

BANK OF BARODA

REGIONAL OFFICE, JORHAT

CRYSTAL ENCLAVE,
SEUNI ALI, BARPOOL,
JORHAT – 785001, ASSAM



TENDER DOCUMENT FOR

Interior Furnishing of eVB Tinsukia Branch in alternative premises at Tinsukia, Assam.

LAST DATE OF SUBMISSION : **13.02.2023 upto 03.00 PM**
Contact Details : **Premises Department**
Regional Office, Jorhat
+91 -9007393722

Bank of Baroda
Regional Office, Jorhat

Bank of Baroda invites sealed Open **Tenders** in Two-bid system from experienced Contractors for **Interior Furnishing of eVB Tinsukia Branch in an alternative premises at Tinsukia, Assam**, which includes Carpentry, Furnishing, Electrical, LAN Cabling and associated works in accordance with Bank's General Conditions of Contract, Special Terms & Conditions of Contract & Particular Terms & Conditions of Contract, Standard specifications, Extent of Work, Special Instructions to Bidders as appended on the subsequent page & Annexures.

- a) Name of work : **Interior Furnishing of eVB Tinsukia branch at Tinsukia, Assam**
- b) Time of Completion : 45days
- c) Earnest Money : **Rs 15,000.00**(Rupees Fifteen Thousand Only) by crossed Demand Draft/ Pay Order payable at Jorhat and drawn in favor of Bank of Baroda, to be submitted with the Bid.
(Tender without earnest money in proper form will be rejected)
- d) Retention Money : 10% of total certified bill amount
- e) Release of Retention : Retention money will be released after Defect Liability Period of 1 (One) year from the date of payment of the final bill after adjusting all dues, if any, from the contractor.
- f) Availability of Tender Document : Tender form has to be downloaded from the Bank's website ***www.bankofbaroda.co.in*** (Tender Section). Application form available on website alone needs to be used. Tender forms will be available on Bank's website from **23/01/2023 till 13/02/2023** upto 3:00 p.m.
- g) Date of Commencement : Either one week from the date of acceptance of work Order or the day on which contractor is instructed to take possession of the site, whichever is later.
- h) Time and date of Submission of tender : Upto **03.00 P.M. on 13.02.2023**
- i) Time and date of Opening of Technical Bid : **At 4.00 P.M. on 13.02.2023**
All the bidders are advised in their own interest to be present on the aforesaid date & time. No separate intimation will be given in this regard.
- j) Venue of Opening Tenders : Bank of Baroda
Jorhat Regional Office
Crystal Enclave, Seuni Ali,
Barpool, Jorhat, Assam – 785001
- k) Tender to be addressed and submitted to: The Asst. General Manager & Regional Head
Bank of Baroda , Jorhat Regional Office
Crystal Enclave, Seuni Ali,
Barpool, Jorhat, Assam – 785001
- l) Clarification, if any to be obtained from: M/s Archiventions, R.G. Baruah Road

- Jorhat-781024, Assam.Mob :9854062928.
- m) Validity of Tenders : 6 (Six) calendar months from the last date of submission of Tender.
- n) Defects liability period : 12(twelve) months from the date of payment of the final bill.
- o) Taxes : **GST at applicable rate shall be paid as extra.**
- p) Delay in submission : Delay in submission of Tender arising due to postal or any other irregularities at any stage will not be considered. The Bank will not be responsible for any damage in transit in case of postal delivery /delivery through courier service.
- q) All tenders in whom any of the prescribed conditions are not fulfilled or are incomplete in any respect, are liable to be rejected.
- r) The acceptance of tender will rest with Bank of Baroda which does not bind itself to accept the lowest or any tender and reserves to itself the right to reject any or all the tenders received without assigning any reasons thereof.
- s) In case the date of opening of tenders is declared as a holiday, the tenders will be opened on the Next working day.
- t) The date & time for opening of Financial Bid will be advised separately to those Bidders who are found eligible after Technical evaluation as per Tender norms.
- u) **Conditional Tenders will be summarily rejected.**

Retention money: The Retention percentage (i. e. deduction for interim bill) shall be 5% of the gross value of each interim bills. The Retention Money will be released after 1(one) year (Defect Liability Period) from the date of payment of the final bill provided the contractor has satisfactorily carried out all the works and attended to all defects in accordance with the conditions of the contract, including site clearance.

Defects liability period shall be as per memorandum. It must be realized that this period is for exposure of "Latent Defects". The DLP commences from the date of payment of the final bill for a period of 12 months.

After opening the envelope containing the offer on the standardized conditions and opening of the priced tender, no correspondence will be entertained.

Prior to opening of Financial Bid, Bank of Baroda / Deputed Architect, at their discretion may inspect the on-going/completed works of the Contractor s as well as obtain confidential report from the concerned employers. The bids of tenders who do not fulfill the above criteria will summarily be rejected. The Bank also reserves to itself the right of accepting the whole or any Part of the tender and the tenderers shall be bound to perform the same at the rates quoted.

Pre-Qualification Criteria:

The firms having experience of successfully completed Civil & Furnishing Works during the last 7 years ending on 30th September, 2022.

- i) **3(three)** "similar completed works" costing not less than 5.86 Lakhs
OR
- ii) **2(two)** "similar completed works" costing not less than 7.32 Lakhs
OR
- iii) **1 (one)** "similar completed work" costing not less than 11.72 Lakhs

Minimum average turnover of the Bidder shall be **14.65 Lakhs** during the last 3 (three) Financial years, testimonials to be mandatorily submitted along with Technical Bid, Part – I

The Contractor Should have a fully fledged operational office in Assam or any of the North Eastern States for operational convenience, with up-to-date tax paid Trade License.

Copy of Trade License (with up to date tax receipt)/ Rent Agreement, etc, Details of local address. Acceptance of the address subjected to verification by the Bank to its satisfaction.

The Tenderer should have at least min. **07years** experience of working with nature of works as briefly mentioned below:

- i. **Civil Interior Works :** [1] New partition walls made of wooden, aluminum, gypsum board, bison board [2] False ceiling, acoustic paneling and flooring work [3] Center table, loose furniture [4] Door closer, louver window work, floor spring works [5] All types of anti-termite and pest control treatment works [6] All types of plumbing, sanitary works in the residential/office complex including supply of plumbing and sanitary materials as per the requirement for office premises, boardrooms, auditoriums, hotels, resort etc.
- ii. **Internal Electrical works:** [1] Installation, testing, commissioning of all electrical low tension [LT] works [2] Electrical control panel, wiring, conducting, trunking. [3] Installation of fitting and fixture, chandelier, switches, MCB's [4] Maintenance and repair of earthing system and lightning arrestors. Works for office premises, boardrooms, auditoriums, hotels, resorts etc.

“**Similar completed works**” means Composite nature of work comprising of Civil work, Carpentry work, Flooring work, Painting work, Sanitary & Plumbing work, Furniture work, Electrical work, and other associated works.

Sealed tender shall be submitted in three separate envelopes consisting of the following:

1. **Cover 1 :** Part – I, Technical Bid including pre-qualification documents (Annexure – A)
2. **Cover 2 :** Earnest Money Deposit (EMD)
3. **Cover 3 :** Part – II, Price Bid

All the above 3 (three) sealed envelopes are to be submitted in a single Covering envelope, duly super-scribed as “**Interior Furnishing of eVB Tinsukia Branch at Tinsukia, Assam**” and submitted to the address mentioned in clause – k herein above.

NOTE:-

- i) The agency will be fully responsible for correctness of all documents submitted along with the tender. False documents may lead to rejection of their bid.
- ii) Bank does not bind itself to accept the lowest or any tender and reserves the right to accept or reject any or all tenders either in whole or in part, without assigning any reasons whatsoever.
- iii) No conditions will be entertained. Conditional offers shall be summarily rejected. Disputes, if any, will be subject to Jorhat jurisdiction only.
- iv) Canvassing in connection with tenders is strictly prohibited and the tenders submitted by the contractors who resort to canvassing will be liable to rejection.
- v) ***MSEs are exempted from paying Tender/RFP fee/cost, EMDs as per MSME Act 2012. For getting the benefits in case of MSE firms, contractors /agencies should submit exemption certificate issued from the relevant authorities.***

GENERAL CONDITIONS OF CONTRACT

- 1 Tenders shall remain open to acceptance by the Bank for a period of 180 days from the date of opening of Part-II of the tender which period may be extended by mutual agreement and the tenderer shall not cancel or withdraw the tender during this period.
- 2 The tenderer must use only the forms displayed on the bank's website to fill in the rates. (Any addition/ alteration in the text of the tender form made by the tenderer shall not be valid and would be liable of rejection).
- 3 The tender form must be filled in Hindi / English and all entries must be made by hand and written in ink. The rate and amount should be in figures and words. If any of the documents is missing or unsigned, the tender may be considered invalid by the Bank Representative in its discretion.
- 4 Rates should be quoted both in figures and in words in columns specified. All erasures and alterations made while filling the tender must be attested by initials of the tenderer. Overwriting of figures is not permitted and failure to comply with either of these conditions will render the tender void at the Bank's option. No advice of any change in rate or conditions after the opening of the tender will be entertained.
- 5 Each of the Tender documents should be signed by the person or persons submitting the tender in token of his/their having acquainted himself/themselves with the General Conditions of Contract, General Specifications, Special Conditions etc., as laid down. Any tender with any of the documents not so signed will be rejected.
- 6 The tender submitted on behalf of a firm shall be signed by all the partners of the firm or by a partner who has the necessary authority on behalf of the firm to enter into the proposed contract. Otherwise the tender may be rejected by the Bank.
- 7 The Bank does not bind itself to accept the lowest or any tender and reserves to itself the right to accept or reject any or all the tenders, either in whole or in part, without assigning any reasons for doing so.
- 8 Intending tenderers shall pay an interest free Earnest Money Deposit for a sum of 15,000/- (Rupees Fifteen Thousand Only) by a demand draft / Banker's Cheque in favour of Bank of Baroda, payable at Jorhat. Tender not accompanied by earnest money deposit will not be considered. The earnest money deposit of unsuccessful bidders shall be refunded after the work order is issued to selected bidder. Under no circumstances earnest money deposit will be accepted in the form of fixed deposit receipt or Bank or Insurance guarantee or Cheque.
- 9 The Earnest Money Deposit of 15,000/- paid by the successful tenderer shall be held by the Bank as security for the execution and due fulfillment of the contract. No interest shall be paid on the said deposit.
- 10 On receipt of intimation from the Employer of the acceptance of his/their tender, the successful tenderer shall be bound to implement the contract agreement within Fourteen days thereof, the successful tenderer shall sign the agreement in accordance with the draft agreement and the schedule of conditions but the written acceptance by the Bank of a tender will constitute a binding contract between Bank of Baroda and the person so tendering, whether such formal agreement is subsequently executed or not. The cost of necessary stamp paper for execution of the agreement shall be borne by successful tenderer.

- 11(a) In additional to the Earnest Money Deposit, successful tenderer shall further deposit 1% of accepted tender value. Thus Bank will keep 2% of accepted tender value as initial security deposit. Total 5% of the accepted tender value may be kept as retention money which includes security deposit and retention money.
- 11(b) All compensation or other sums of money payable by the contractor to the Employer under the terms of this contract may be deducted from his earnest money and security deposit if the amount so permits and the contractor shall, unless such deposit has become otherwise payable within ten days after such deductions make good in cash the amount so deducted.
- 12 The Contractor shall not without the written consent of the Bank assign this Contract, and shall not without the written consent of the Bank (which consent shall not be unreasonably withheld to the prejudice of the Contractor) sublet any portion of the work. Bank may serve a notice in writing on the Contractor rescinding the contract, whereupon the security deposit shall stand forfeited to the Employer, without prejudice to his/other remedies against the Contractor.
- 13 The Contractor shall carry out all the work strictly in accordance with drawings, details and instructions of Bank's Architect & Engineer. If in the opinion of the Bank Representative, changes have to be made in the design and with the prior approval in writing of the Bank's Representative, they desire the Contractor to carry out the same, the Contractor shall carry out the same without any extra charge.
- 14 A schedule of Probable Quantities in respect of each work and Specifications accompany these Special Conditions. The Schedule of Probable Quantities is liable to alterations by omissions, deductions or additions at the discretion of the Bank. Each tender should contain not only the rates but also the value of each item of work entered in a separate column and all the amounts quoted against various items should be totaled in order to show the aggregate value of the entire tender.
- 15 The tenderer must obtain for himself on his own responsibility and at his own expense all the information which may be necessary for the purpose of making a tender and for entering into a contract and must examine the Drawings, inspect the site of the work, acquaint himself with all local conditions, means of access of the work, nature of the work and all matters pertaining thereof.
- 16 The rates quoted in the tender shall include all charges for clearing of site before commencement as well as after completion, water, electric consumption, meters, double scaffolding, centering, boxing, staging, planking, timbering and pumping out water including bailing, fencing, hoarding, plant and equipment, storage sheds, watching and lighting, by night as well as day including Sundays and Holidays, temporary plumbing and electric supply, protection of the public and safety of adjacent roads, streets. The rates quoted shall be deemed to be for the finished work to be measured at site. The rates shall also be firm and shall not be subject to exchange variations, Labour conditions, fluctuations in railway freights or any conditions whatsoever. **The quoted rates shall not include applicable GST, which shall be paid by Bank in addition to the quoted rates.**
- 17 The Contractor should note that unless otherwise stated the tender is strictly on item rate basis and his attention is drawn to the fact that rates for each and every item should be correct, workable and self-supporting. The quantities in the Schedule of Quantities approximately indicate the total extent of work but may vary to any extent and may even be omitted thus altering the aggregate value of the Contract.

- 18 Time allowed for carrying out the work as mentioned in the Memorandum shall be strictly observed by the tenderer and it shall be reckoned from the tenth day after written order to commence the work is issued.
The work shall throughout the stipulated period of the Contract be proceeded with all due diligence and if the Contractor fails to complete all the work within the specified period he shall be liable to pay compensation of the Conditions of Contract/ work contract. The tenderer shall before commencing work prepare a detailed work program which shall be approved by the Employer. Contractors have to pay Liquidated damages against delay of the work @ 1 % per week of delay of the estimated amount shown in the tender or contract amount whichever is higher per week. Maximum liquidated damages will be 10 % of the accepted contract sum.
- 19 Tenders will be considered only from recognized bonafide contractors in trade concerned. Each tenderer shall submit with his tender a list of large works of a like nature he has executed giving details as to their magnitude and cost of the proportion of work done by the Contractor in it and the time within which the work were completed.
- 20 The Contractor shall not be entitled to any compensation for any loss suffered by him on account of delays in commencing or executing the work, whatever the cause of delays may be, including delays arising out of modification to the work entrusted to him.
- 21 The successful tenderer is bound to carry out any or all items of work necessary for the completion of the job even though such items are not included in the quantities and rates. Schedule of instructions in respect of such additional items and their quantities will be issued in writing by Bank.
- 22 The successful tenderer must co-operate with the other contractors appointed by the Employer so that the work shall proceed smoothly with the least possible delay and to the satisfaction of the Bank.
- 23 The contractor must bear in mind that all the work shall be carried out strictly in accordance with the specifications made by the Bank and also in compliance of the requirements of the local public authorities and no deviation on any account will be permitted.
- 24 The tenderer shall have to use materials of the makes/manufacturers specified in the list of material approved brand and/or manufacture contained in this tender form.
- 25 The Contractor shall strictly adhere to the rules laid down by the Housing Society for carrying out repair & renovation works in the premises. Any penalty/ fine imposed by the Society due to non-adherence of laid down rules has to be borne by the Contractor.
- 26 The contractor shall strictly comply with the provision of safety code annexed hereto.
- 27 I.S. Code numbers wherever mentioned in the tender shall be the latest version of I.S. codes as on the date of opening of Tenders.
- 28 The security deposit of the successful tenderer will be forfeited if he fails to comply with any of the conditions of the Contract.

29 All disputes and differences of any kind whatever arising out of or in connection with the contract or the carrying out of the works (whether during the progress of the works or within 12 months from the date of virtual completion of the work and whether before or within 12 months of determination abandonment or breach of the contract) shall be referred to giving inter-alia full details of the matter under dispute like quantities, rates, amount claimed and the reason thereto and settled by the Bank who shall state his The Arbitrator shall have power to open up, review and revise any Certificate, opinion, decision requisition or notice, save in regard to the excepted matters, referred to in the preceding Clause and to determine all matters in dispute which shall be submitted to arbitration and of which notice shall have been given as aforesaid. The Arbitrator shall make his award within one year (or such further extended time as may be decided by him or them as the case may be with the consent of the parties) from the date of entering on the reference. In case during the arbitration proceedings the parties mutually settle, compromise or compound their dispute or difference, the reference to arbitration, the reference to arbitration and the appointment of the Arbitrator shall be deemed to have been revoked and the arbitration proceedings shall stand withdrawn or terminated, with effect from the date on which the parties file a joint memorandum of settlement thereof; with the Arbitrator or the Arbitrators as the case may be. The submission shall be deemed to be a submission to arbitration within the meaning of the Arbitration & Conciliation Act, 1996 or any statutory modification thereof. It is agreed that the Contractor shall not delay the carrying out of the works by reason of any such matter, question or dispute being referred to arbitration, but shall proceed with the works with all due diligence and shall, until the decision of the Arbitrator or Arbitrators as the case may be, is given.

30 **CONTRACTOR TO INFORM HIMSELF FULLY:**

The contractor shall be deemed to have carefully examined the work and sited conditions including Labour, the general and special conditions, the specifications, schedules and drawings and shall be deemed to have visited the site of work, to have fully informed himself regarding the local conditions and carried out his own investigations to arrive at the rates quoted in the tender. In this regard he will be given necessary information available with the department but without any guarantee about its accuracy.

If the contractor shall have any doubt as to the meaning of any portion of the general conditions, or the special conditions or the scope of the work or the specifications and drawings or any other matter concerning the contract he shall in good time, before submitting his tender, put forth the particulars thereof and submit them to the Bank, Kolkata in writing in order that such doubts may be clarified authoritatively in writing before tendering. Once a tender is submitted, the matter will be decided according to tender conditions in the absence of such authentic pre-clarification.

I/We hereby declare that I/We have read and understood the above instructions for the guidance of tenderers.

Signature of Bidder with Seal

SPECIAL CONDITIONS OF THE CONTRACT

1. The wood to be used should have similar / uniform grains and should be totally free from white portions, decay, knots etc.
2. All the edges of the plywood should be teak wood beadings. The beading to be fixed with adhesive / screw/ nails.
3. The measurements indicated in the drawings are approximate and may vary as per the site conditions. Bank's Engineer/ Architect's interpretation of the design and the specifications mentioned in the entire document shall be final and without appeal. In case of Errors or inconsistency, if discovered in the drawing and specifications, Bank's Engineer/ Architect's interpretation shall be final and without appeal.
4. The contractor shall submit the Bar Chart & PERT chart before commencement of work and the progress chart during the course of work.
5. For the design and other details mentioned in the entire document Bank's Engineer/ Architect alone has the patent right.
6. The contractor shall take the prior approval from Bank's Engineer/ Architect for subletting the job even if the same is to a specialized agency.
7. In case Bank's Engineer/ Architect rejects a particular work the tenderer shall remove the same within two days and no payment shall be made for such work.
8. The Contractor has to take all safety measures with regard to the workmen employed as per relevant laws and good engineering practices at site and safety measures against the fire hazard.
9. The contractor has to make necessary arrangement for internal lighting at the site.
10. The contractor has to carry out the job strictly as per specification spelt out in the bill of quantities, the drawings, instructions that may be issued by the Engineer-in-charge and the specification of the Bureau of Indian Standards, National Building Code etc.
11. In case of any discrepancy between the specifications and the drawings, the details mentioned in the specifications / Bill of quantities may be taken as final.
12. The electrical installation works are to be carried out by engaging licensed electrical contractor. The successful tenderer shall submit the photocopy of Electrical Contractor's license at the time of execution of work. The copy of license of Electrical Supervisor and electricians also are to be submitted.
13. The contractor shall submit the single line drawing of electrical installations/wiring of completed work along with the final bill.
14. The contractor shall submit the Test Certificate of the Electrical installations carried out by him as per requirement of local Electrical supply Authority, Indian Electricity Rules, and Indian Electricity Act.
15. The work shall be carried out on holidays and Sundays after and before office hours and during office hours on working days. The Contractor shall ensure that there shall not be any problem, disturbance in office/other areas/floors as the work is to be executed in working office.
16. The Contractor shall depute one electrician and one helper during office hours to avoid any electrical breakdown in electrical installation.

17. The contractor has to carry out the job strictly as per specification spelt out in the bill of quantities, the drawings, instructions that may be issued by the Engineer-in-charge and the specification of the Bureau of Indian Standards, National Building Code etc.
18. Contractors shall insure whole work against fire, PICT and third party.
19. In case of any discrepancy between the specifications and the drawings, the details mentioned in the specifications / Bill of quantities may be taken as final.
20. The work will be awarded to the Agency that has given the lowest rate (L-1).

Additionally, the L2 Bidder will be asked to confirm if he can do the work at the lowest rates quoted by L1.

If the L2 gives a letter confirming that he is ready to carry out the work at the lowest rate (L1), then it can be considered to award the work to him also. The condition of this award of work to L2 on the rates of L1 will be as under:

1. When L1 denies in writing that he does not have capacity to do the work.
2. When it is observed by Bank's Engineer/ Architect. That L1 has not completed more than 3 sites in time.
3. When defects are found in the work of L1.
4. When L1 does not take up the work as assigned within the stipulated time period as mentioned in the work order.

PREAMBLE TO THE BILL OF QUANTITIES

The work proposed is to be carried out at the Office premises mentioned on the cover page (no.1) of the tender. The premise is proposed to be provided with Furnishing, civil, plumbing, electrical, LAN cabling works. The quality of work proposed should have the best workmanship. The contractor should ensure that only the first quality materials mentioned in the list of material is purchased for the project.

1. The work should be carried out in such a way that the structure is not disturbed.
2. Any difference / discrepancies in the specification should be clarified with the Engineer in charge before submitting the tender. The Engineer in charge will have the liberty to modify the specification to a reasonable limit to suit the basic concept during the course of work; the tenderer should carry out such work without any extra cost.
3. In case of any major modification such items will be considered as an extra items. Payment for such items will be paid based on the Engineering rate / Market rate analysis. 15% of the total cost of material & labour will be considered as tenderer's profit.
4. The contractor should co-ordinate with the other contractors employed at the site for smooth flow of work.

LIST OF PREFERRED MAKE / BRAND ALL WORKS

Sr.No.	LIST OF NOMINATED MATERIALS & SUPPLIERS	SUGGESTED MAKE LIST
1	INTERIOR WORKS	
	Block board / Plywood	Greenply / Duro / Archidply/ Everest or equivalent
	Laminate	Greenlam/ Archidply/Merino or equivalent
	Veneer	Green / Duro / Century / or equivalent
	Acrylic sheet	ICI, GE or equivalent ISI make
	Marine grade plywood	Century, Duro, Archidply, or equivalent
	Adhesive	Fevicol / Araldite/Anchor or equivalent
	Solid Surfaces (Corian)	DUPOINT/LG/ Merino OR equivalent
	Marine grade Block Board	Century / Duro /Archidply or equivalent
	Flush Door	Century / Duro /Archidply or equivalent
	Polish	Asain / Dulex or equivalent
	Latex	MM Foam or equivalent ISI make
	High density foam	U Foam or equivalent ISI make
	Locks	Haffle / Hettich or equivalent
	Storage Hardware	Haffle / Hettich or equivalent
	Screws / Nails & other accessories	GKW / Nettleford or equivalent
	False Flooring	Kebao , Armstrong , AMF or equivalent
	Vinyl Flooring	Armstrong ,Viabrant, Eurotex ,
	Carpet	Unitex, Armstrong,
	Wooden laminated flooring	Pergo / Armstrong / Squarefeet or equivalent
	Plain/Toughened glass	Saint- Gobain, Indo Asahi , Modi or equivalent
	Hardware for general staff areas	Dorma / Ozone / Ebco /Hafele or equivalent
	Hardware for main Glass doors (patch fittings)	Dorma / Ozone / Ebco /Hafele or equivalent
	Door Closers (general use)	Dorma / Ozone / Ebco /Hafele or equivalent
	Floor springs (general use)	Dorma / Ozone / Ebco /Hafele or equivalent
	Floor springs for main glass doors	Dorma / Ozone / Ebco /Hafele or equivalent
	Aluminium Sections for Partitions	Jindal / Tata steel or equivalent
	False Ceilings: Gypsum	India Gypsum / Saint Gobin / Asia
	False Ceilings: Grid (As Approved)	Armstrong / AMF or equivalent
	False Ceilings: Grid (Metal Ceiling)	Unimech / AMF / Armstrong
	GI Sections	India Gypsum / Saint Gobin / Jindal or equivalent
	Acoustical False Ceilings: Mineral fiber board	Armstrong, Hunter Douglas / Peritex or equivalent
	POP Punning	Gyprock / India Gypsum / Birla
	Paint	Asian / Nerolac / Dulex / Berger or equivalent
	Exterior Paint	Asian / Nerolac / Dulex / Berger or equivalent
	ACP (Exterior / Interior)	Alstone / Eurobond /Alucobond
	Cylicon	G E / Dow corning / Wacer

	Rolling / Vertical Blind	Vista / Peritex / Winfab / MAC or equivalent
	Frosted Film	Garware or equivalent
	Aluminum Skirting - 50mm	Jindal or equivalent
	Water Proofing	Pidilite or equivalent
	HardWood	Salwood / Teakwood/kapoor
	Automated Rolling Shutter	Gandhi Automation/Toshi Automatic Systems/Akash Rolling Shutter
	Glass	Saint Gobin / equivalent
	Wall Panels (Baffle Panelling)	Hunter Douglas, Armstrong or equivalent
	Modular Desk & Bench for training Room	Godrej/ Geeken/ Wipro/ Featherlite or equivalent
2	ELECTRICAL	
	Light Fittings	Philips / Wipro / Havells / Century or equivalent
	MCCB, MCB , RCCB, DB, ICTPN TP, HRC Fuse, cahnge over switch, switch fuse Unit	L&T, ABB, Legrand, Siemens, Schneider
	FRLS insulated Elec. Wire/ cable armourd, unarmourd, Sheathed,unSheathed, flexible LT cable, Multi core, single core cable, flat cable	Finolex/Ploycab/Havells/RR kabel/KEI
	PVC conduit(HEAVY DUTY ONLY)	CAP/Finolex/Polycab
	PVC insulated copper conductor Wires	Finolex/ Polycab/RR Cable
	Distribution Box	Legrand/ Schneider/ ABB/Siemens
	MCB & MCCB	Legrand/ Schneider/ ABB/Siemens/L&T
	Wall Fan, Ceiling Fan & Exhaust fan	Havells/ Usha/ Chrompton or equivalent
	HT cable	Polycab/Havells
	Modular Switches	ABB/ Legrand/ MK/ANCHOR/ROMA
	DLP Trunking	Legrand/Schneider or equivalent
	Power cable	CCI/ Skytone/ Universal/ LAPP/ Torrent
	End Termination	Raychem/ Mahindra/ELMEX
	PANEL	Crompton/L&T/C&S
	Fan	Crompton/Havells/Bajaj/Usha
	Raceway & Alu. Trunking	Tata/Jindal/Zenith
	Casing Caping	Finolex/Cap or equivalent
	Weather proof socket outlet with MCB	ABB/MDS/LEXIC/Neptune/Elcon- Clipsil, Siemens, Schneider (Merlin Gerin)
	Miniature Circuit Breaker	ABB/MDS/LEXIC/ Clipsil/Siemens/HPL
	Earth Leakage Circuit Breaker	MDS/LEXIS/Siemens/HPL

	MCB Distribution Boards in sheet steel housing (double door)	ABB/MDS/LEXIC/Siemens/HPL
3	DISTRIBUTION	
	MV Contractor/Timer/Relays/Starters	Legrand/ Schneider(MG)/ ABB/Siemens/L&T
	Moulded case circuit breakers	Legrand/ Schneider(MG)/ ABB/Siemens/L&T
	SFU/Fuses	HPL/ L&T. Siemens, GE Power, Schneider (MG)
	ACB	Schneider(MG)/ ABB/Siemens/L&T
	Single Phase Preventer (Current base)	L&T, Minilec
	Raising Mains & Tap Off (Power coated)	Zeta, C&S, Siemens
	MV Switchboards (Powder Coated)	Tricolite Electrical Industries, conlec Enginners Pvt. Ltd, Vidyut Control Pvt Ltd., Trinitron Milestone Switchgear, Unilec Ltd, Madhu Electrical Advance
4	LOW TENSION SYSTEM	
	Light & Fan Wire	Polycab, Finolex, Havells
	Telephone Wires	Delton, Skyline, Finolex, Rallison, Batra Henley
	Telephone Tag Blcoks	Krone / Pouyet/ TVS
6	Electrical Items	
	Panel Switch Gear & related Item	
	LT Panel/Bus Duct	By any Panel manufacturer who process C.P.R.I. certificate for specified fault level & IP level protection
	Fuse Disconnecter switch/switch fuse unit	L&T, Siemens/ Schneider/ABB/Legrand
	Ammeter Voltmeter	AE/L&T/MECO/Rishab
	Digital Meters/ Intelligent Maultifuntional Digital mater	AE/HPL/CONZERV
	Selector Switch, Push button switch / emergency switch	KAY CEE/ L&T/ Siemens/ Schneider
	Indication Lamp	AE/L&T/Siemens/ Schneider
	CT's	L&T / AE/ Kappa
	AT's	L&T/Siemens/ Schneider/ legrand
7	Internal Wiring Related Works	
	MCB/RCCS/Isolators (ISI) marked	L&T Siemens/ Schneider/ Legrand

	MCB DB	
	PVC Conduit	CAP / BEC/ Seiko/ AKG
	PVC insulated copper wire (ISI marked)	Skyline/ Finolex/ Havells/ Ploycab
	Telephone Cable	Skytone/ Delton/ NICCO/Polycab/ Finolex
	Switch, TV & Telephone socket & boxes (Modular Type)	CPL/ Legrand/ABB/Anchor
8	Miscellaneous Items	
	Lightning Protection Unit	Erico/ Pheonix/ INDELEC
	Relays	L&T/ABB/Siemens/BCH
	Contractors	L&T/ GE Power/BCH/ Siemens/ABB
	Changeover switch	C&S/Havells/ L&T/HPL
	KWH, PF, Frequency meter	BHEL/ AE/Havells/ L&T/ALSTOM
	Push Buttons	L&T/ Siemens
	Timers	L&T/ Legrand/ Schneider/Siemens/GE
	Timer Switch	L&T/ Legrand/ Schneider/Siemens/GE
9	Networking	
	Switches	Brocade/Cisco/Digi-Link/3Com/Nortel/Foundry/D-Link
	Patch Panel,Patch cord and I/o	Digi-Link / Tyco(AMP) /Schneider/D-Link
	Cable	Digilink/Clipser/National/Polycab/Lapp/Finolex
	Racks	ComRack / HCL / ValRack / APW President

CONTRACTOR

NOTE: The contractor shall use only above mentioned material to be approved by the Consultant. All other materials shall confirm to the specifications laid down. The tenderer shall take this into account while tendering rates / prices.



BANK OF BARODA
JORHAT REGIONAL OFFICE, CRYSTAL ENCLAVE, SEUNI ALI
BARPOOL, JORHAT-785001, ASSAM

T E N D E R F O R M

I/We have read and examined the notice inviting tender. Schedules A,B,C,D,E & F, specifications applicable, Drawings and Designs, General Rules and Directions, Conditions of Contract, clauses of contract, Special conditions, Schedule of Rate and all other documents and Rules referred to in the conditions of contract and all other contents in the tender document for the work.

I/We hereby tender for the execution of the work specified for the Bank of Baroda within the time specified in Schedule 'F' at the rates specified in the attached Schedule 'A' viz., schedule of quantities and in accordance in all respects with the specifications, designs drawings and instructions in writing referred to in Rule-1 of General Rules and Directions and in Clause 11 of the conditions of contract and with such materials as are provided for, by, and in all respects in accordance with, such conditions so far as applicable.

I/We agree to keep the tender open for hundred and twenty days from the due date of submission thereof and not to make any modifications in its terms and conditions.

A sum of **Rs. 15000/-** is hereby forwarded in Demand Draft of a Scheduled Bank as earnest money (unless exempted). If I/We, fail to commence the work specified I/We agree that the Bank shall without prejudice to any other right or remedy, be at liberty to forfeit the said earnest money absolutely otherwise the said earnest money shall be retained by it towards security deposit to execute all the works referred to in the tender documents upon the terms and conditions contained or referred to therein and to carry out such deviations as may be ordered, upto maximum of the percentage mentioned in Schedule 'F' and those in excess of that limit at the rates to be determined in accordance with the provision contained in Clauses 12.2 and 12.3 of the tender form.

I/We hereby declare that I/We treat the tender documents, drawings and other records connected with the work as secret/confidential documents and shall not communicate information/derived therefrom to any persons other than a person to whom I/We am /are authorised to communicate the same or use the information in any manner prejudiced to the safety of the state.

I/We fully understand that you are not bound to accept the lowest or any tender you may receive.

Shri. _____, **Partner/Proprietor/** _____, is the person authorised to negotiate commercial and technical terms and conditions and sign on behalf of the firm any Agreement, Bills and receipts for this work.

I/We agree that should I/We fail to deposit the full amount of initial security deposit and/or fail to commence the work specified in the above memorandum, an amount equal to the amount of the earnest money mentioned in the form of invitation of tender shall be



absolutely forfeited to the BANK OF BARODA and the same ,may at the option of the BANK OF BARODA be recovered without prejudice to any other right or remedy available in law, out of the deposit in so far as the same may extend in terms of the said bond and in the event of deficiency out of any other money due to me/us under this contract or otherwise.

I/We agree that until a formal agreement on stamp paper is prepared and signed, this tender with your written acceptance thereof shall constitute a binding contract between us.

**Signature of Contractor
Full Postal Address
Pin Code No. & Telephone No.**

Dated the: _____ day of 2023

Witness:

Name :

Address:

Occupation:

◆ ◆ ◆ ◆ ◆ ◆ ◆ ◆

**:ANNEXURE-1:
APPLICATION FORMAT**

1. (a) Name of the Applicant :

(b) Address :

(c)Telephone No. :

Office :

Residence :

Mobile :

Fax :

E-Mail :

(d)Registered Address of office :

(e) Local Address of Office :

2. a) Status of the Firm(Whether company/

Partnership / proprietary) :

b)Name of the Proprietor/ Partners/ Directors

(With professional qualifications, if any):

l)

II)

III)

c) Year of establishment :

3. Whether registered with Registrar of
Companies/ firm. If so, No. & Date :

4. Registration with Tax Authorities :

a) Income-tax No. PAN ;
(Furnish copies of Income-tax returns)

b) GST Regdn Number :
(Furnish the latest copies of the returns filed)

c) Electrical license number of the contractor /associate:

5. Names of the Bankers with address :

I)

II)

6. Turnover of the Company/firm (Please attach copy of documents in support of the details).

Sl. No.	Year	Turnover
1	2020-21	
2	2021-22	
3	2022-23	

7. Registration/Empanelment with Government / Public Sector / Banks / Corporate if any (Copy of valid registration/empanelment copy should be enclosed).

NAME OF THE ORGANISATION	NATURE OF WORKS	VALUE OF WORKS	DATE OF REGISTRATION

8. What are your fields of activities? Mention the fields on preference Basis

1)

2)

3)

9 Details of the works executed during the last 3 years prior to 31.09.2022 to meet eligibility Criteria

Sl	Name of Work	Work executed for (name of the organization with address, concerned office and telephone number)	Nature of work (in brief)	Location of the work	Actual Value of the works	Date of commencement & Completion.

10. Key personnel permanently employed in your organization:

Sl No.	Name	Qualifications	Experience	Particulars of work done	Employed in your firm since	Any other

11. Furnish the names of three responsible clients/ persons to whom the major works carried out by the applicant with address and telephone number who will be in a position to certify about the quality as well as past performance of your organization.

NAME OF THE OFFICIAL	ORGANISATION & ADDRESS	CONTACT NUMBERS

12. Furnish the details of AWARDS, CITATIONS etc received in recognition of your services in projects designed/ associated

YEAR	Name of the Award with details	Name of the organization from whom award was received	Name of the project for which such award was received

DECLARATION

1. All the information furnished by me / us here above is correct to the best of my knowledge and belief.
2. I / we have no objection if enquiries are made about the work listed by me / us in the accompanying sheets / annexure.
3. I / We agree that the decision of Bank in selection will be final and binding to me / us.

Place :

SIGNATURE

Date :

NAME & DESIGNATION

SEAL OF ORGANISATION



:ANNEXURE-2:

**BANK OF BARODA
JORHAT REGIONAL OFFICE, CRYSTAL ENCLAVE, SEUNI ALI
BARPOOL, JORHAT-785001, ASSAM**

ACCEPTANCE

The above tender (as modified by us or negotiations as provided in the letters mentioned hereunder) is accepted by me for and on behalf of the Bank of Baroda for a sum of Rs. _____ (Rupees _____)

The letters referred to below shall also form part of this contract agreement :

a)

b)

c)

For & on behalf of the BANK OF BARODA

Signature : _____

Designation: _____

Dated this _____ day of 2021.



:ANNEXURE-3:

BANK OF BARODA
JORHAT REGIONAL OFFICE, CRYSTAL ENCLAVE, SEUNI ALI
BARPOOL, JORHAT-785001, ASSAM

FORM OF AGREEMENT

This agreement made the _____ day of the month of _____ in the year **2022** BETWEEN, **BANK OF BARODA**, having its Head Office, at **Baroda Bhavan, R.C. Dutt Road, Alkapuri, Baroda-390007, Gujarat, India**, represented by its duly constituted attorney (hereinafter referred to as Bank) of the ONE PART; and Shri/M/s _____ S/D/o _____ resident of _____

_____ the sole proprietor of **M/s** _____ having office at _____ /the partnership firm represented by its Managing/duly authorised partner, having an administrative/principal office at _____ /a company/body corporate being its registered office at _____

_____ duly represented at _____ duly represented by its constituted and authorised Managing Director, Shri _____ and (hereinafter called the Contractor) of the other part WHEREAS THE Bank is desirous that certain works should be constructed viz., _____ and has accepted the tender dt. _____ furnished by the contractor for the constructions, completion and performance of such works.

NOW THIS AGREEMENT WITNESSETH as follows:

1. In this agreement words and expression shall have the same meanings as are respectively assigned to them in the conditions of contract hereinafter referred to.
2. The following documents not inconsistent with these presents shall be deemed to form and be read and construed as part of this agreement viz.,
 - a) Notice inviting Tender
 - b) The Tender form
 - d) General Rules and Directions to tenderers .
 - e) Conditions of contract and clauses of contract along with Annexures thereto and Schedules A to F.



- f) Schedule of quantities (SOQ) includes Prices and tendered amount.
- g) Tender drawings.
- h) Technical Specifications for the work.
- i) Safety code and Model rules for the protection of health, Sanitary arrangements for workers employed.
- j) Letter of Acceptance.
- k) Letters from and to the Contractor, if any, leading to and prior to acceptance letter.

3. In consideration of the payments to be made by the Bank to the Contractor the Contractor hereby covenants and agrees with the Bank to construct, complete and perform the works in conformity in all respects and subject to all terms and conditions/rules as mentioned in the aforesaid documents which shall form part of this agreement.

In witness whereof the parties hereto have hereunto set their respective hands and seals the day and year first above written.

Signed, sealed and delivered by the said contractor, _____ to bank
_____ in the presence of:

Signature of Contractor (with seal)

Signature of Bank Official (with seal)



:ANNEXURE-4:

**BANK OF BARODA
JORHAT REGIONAL OFFICE, CRYSTAL ENCLAVE, SEUNI ALI
BARPOOL, JORHAT-785001, ASSAM**

LIST OF RELATIVES EMPLOYED IN BANK OF BARODA AND WITH THE ARCHITECT FOR THIS WORK.

I. No	Name	Designation	Branch/ Office of Bank / Architect	Relationship with Contractor
1.				
2.				
3.				
4.				
5.				

Signature of the Contractor



:ANNEXURE-5:

INTEGRITY PACT

Between

BANK OF BARODA a body corporate constituted under the Banking Companies (Acquisition and Transfer of undertakings Act, 1970,) having its Head office, at Baroda Bhavan, R.C. Dutt Road, Alkapuri, Baroda-390007, Gujarat, India hereinafter referred to as “The Principal”, which expression unless repugnant to the context or meaning hereof shall include its successors or assigns of the ONE PART

and

(description of the party along with address), hereinafter referred to as “The Bidder/ Contractor” which expression unless repugnant to the context or meaning hereof shall include its successors or assigns of the OTHER PART

Preamble

The Principal intends to award, under laid-down organizational procedures, contract/s for *Interior Furnishing of proposed new Branch at Athibung, Nagaland*

The Principal values full compliance with all relevant laws of the land, rules and regulations, and the principles of economic use of resources, and of fairness and transparency in its relations with its Bidder(s)/ Contractor(s).

In order to achieve these goals, the Principal will appoint Independent External

Monitor(s), who will monitor the Tender/RFP process and the execution of the contract for compliance with the principles mentioned above.

Section 1 – Commitments of the Principal

1.1 The Principal commits itself to take all measures necessary to prevent corruption and to observe the following principles:-

1.1.1 No employee of the Principal, personally or through family members, will in connection with the Tender/RFP for, or the execution of a contract, demand, take a promise for or accept, for self or third person, any material or immaterial benefit which the person is not legally entitled to.

1.1.2 The Principal will, during the Tender/RFP process treat all Bidder(s) with equity and reason. The Principal will in particular, before and during the Tender/RFP process, provide to all Bidder(s) the same information and will not provide to any Bidder(s) confidential / additional information through which the Bidder(s) could obtain an advantage in relation to the Tender/RFP process or the contract execution.

1.1.3 The Principal will exclude from the process all known prejudiced persons.

1.2 If the Principal obtains information on the conduct of any of its employees which is a penal offence under the Indian Penal Code 1860 and Prevention of Corruption Act 1988 or any other statutory penal enactment, or if there be a substantive suspicion in this regard, the Principal will inform its Vigilance Office and in addition can initiate disciplinary actions.

Section 2 – Commitments of the Bidder(s)/ Contractor(s)

2.1 The Bidder(s)/ Contractor(s) commit himself to take all measures necessary to prevent corruption. He commits himself to observe the following

principles during his participation in the Tender/RFP process and during the contract execution.

2.1.1 The Bidder(s)/ Contractor(s) will not, directly or through any other person or firm, offer, promise or give to the Principal or to any of the Principal's employees involved in the Tender/RFP process or the execution of the contract or to any third person any material, immaterial or any other benefit which he / she is not legally entitled to, in order to obtain in exchange any advantage of any kind whatsoever during the Tender/RFP process or during the execution of the contract.

The Bidder(s)/ Contractor(s) will not enter with other Bidder(s) into any illegal or undisclosed agreement or understanding, whether formal or informal. This applies in particular to prices, specifications, certifications, subsidiary contracts, submission or non-submission of bids or any other actions to restrict competitiveness or to introduce cartelization in the bidding process.

2.1.2 The Bidder(s)/ Contractor(s) will not commit any penal offence under the relevant IPC/ PC Act; further the Bidder(s)/ Contractor(s) will not use improperly, for purposes of competition or personal gain, or pass on to others, any information or document provided by the Principal as part of the business relationship, regarding plans, technical proposals and business details, including information contained or transmitted electronically.

2.1.3 The Bidder(s)/ Contractor(s) will, when presenting his bid, disclose any and all payments he has made, and is committed to or intends to make to agents, brokers or any other intermediaries in connection with the award of the contract.

2.2 The Bidder(s)/ Contractor(s) will not instigate third persons to commit offences outlined above or be an accessory to such offences.

Section 3 – Disqualification from Tender/RFP process and exclusion from future contracts

If the Bidder(s)/ Contractor(s), before award or during execution has committed a transgression through a violation of Section 2 above, or acts in any other manner such as to put his reliability or credibility in question, the Principal is entitled to disqualify the Bidders(s)/ Contractor(s) from the Tender/RFP process or take action as per the separate “Guidelines for Suspension of Business Dealings with Suppliers/ Contractors” framed by the Principal.

Section 4 – Compensation for Damages

4.1 If the Principal has disqualified the Bidder(s) from the Tender/RFP process prior to the award according to Section 3, the Principal is entitled to demand and recover the damages equivalent to Earnest Money Deposit.

4.2 If the Principal has terminated the contract according to Section 3, or if the Principal is entitled to terminate the contract according to section 3, the Principal shall be entitled to demand and recover from the Contractor liquidated damages equivalent to 5% of the contract value or the amount equivalent to Security Deposit/Performance Bank Guarantee, whichever is higher.

Section 5 – Previous Transgression

5.1 The Bidder declares that no previous transgressions occurred in the last 3 years with any other company in any country conforming to the anti-corruption approach or with any other Public Sector Enterprise in India that could justify his exclusion from the Tender/RFP process.

5.2 If the Bidder makes incorrect statement on this subject, he can be disqualified from the Tender/RFP process or the contract, if already awarded, can be terminated for such reason.

Section 6 – Equal treatment of all Bidders/ Contractors/ Sub-contractors

6.1 The Bidder(s)/ Contractor(s) undertake(s) to demand from his sub-contractors a commitment consistent with this Integrity Pact. This commitment shall be taken only from those sub-contractors whose contract value is more than 20% of Bidder's/ Contractor's contract value with the Principal.

6.2 The Principal will enter into agreements with identical conditions as this one with all Bidders and Contractors.

6.3 The Principal will disqualify from the Tender/RFP process all bidders who do not sign this pact or violate its provisions.

Section 7 – Criminal Charges against violating Bidders/Contractors /Subcontractors

If the Principal obtains knowledge of conduct of a Bidder, Contractor or Subcontractor, or of an employee or a representative or an associate of a Bidder, Contractor or Subcontractor which constitutes corruption, or if the Principal has substantive suspicion in this regard, the Principal will inform the Vigilance Office.

Section 8 –Independent External Monitor(s)

8.1 The Principal appoints competent and credible Independent External Monitor for this Pact. The task of the Monitor is to review independently and objectively, whether and to what extent the parties comply with the obligations under this agreement.

8.2 The Monitor is not subject to instructions by the representatives of the parties and performs his functions neutrally and independently. He reports to the MD & CEO , BANK OF BARODA.

8.3 The Bidder(s)/ Contractor(s) accepts that the Monitor has the right to access without restriction to all contract documentation of the Principal including that provided by the Bidder(s)/ Contractor(s). The Bidder(s)/ Contractor(s) will grant the monitor, upon his request and demonstration of a valid interest, unrestricted and unconditional access to his contract documentation. The same is applicable to Sub-contractor(s). The Monitor is under contractual obligation to treat the information and documents of the Bidder(s)/ Contractor(s) / Sub-contractor(s) with confidentiality.

8.4 The Principal will provide to the Monitor sufficient information about all meetings among the parties related to the contract provided such meetings could have an impact on the contractual relations between the Principal and the Contractor. The parties offer to the Monitor the option to participate in such meetings.

8.5 As soon as the Monitor notices, or believes to notice, a violation of this agreement, he will so inform the Management of the Principal and request the Management to discontinue or take corrective action, or heal the situation, or to take other relevant action. The Monitor can in this regard submit non-binding recommendations. Beyond this, the Monitor has no right to demand from the parties that they act in a specific manner, refrain from action or tolerate action.

8.6 The Monitor will submit a written report to the MD & CEO , BANK OF BARODA within 8 to 10 weeks from the date of reference or intimation to him by the Principal and, should the occasion arise, submit proposals for correcting problematic situations.

8.7 The MD & CEO , BANK OF BARODA shall decide the compensation to be paid to the Monitor and its terms and conditions.

8.8 If the Monitor has reported to the MD & CEO , BANK OF BARODA, a substantiated suspicion of an offence under relevant IPC / PC Act, and the MD & CEO , BANK OF BARODA has not, within reasonable time, taken visible action to proceed against such offence or reported it to the Vigilance Office, the Monitor may also transmit this information directly to the Central Vigilance

Commissioner, Government of India.

8.9 The number of Independent External Monitor(s) shall be decided by the MD & CEO, BANK OF BARODA.

8.10 The word 'Monitor' would include both singular and plural.

Section 9 – Pact Duration

9.1 This Pact begins when both parties have legally signed it. It expires for the Contractor 12 months after the last payment under the respective contract and for all other Bidders 6 months after the contract has been awarded.

9.2 If any claim is made / lodged during this time, the same shall be binding and continue to be valid despite the lapse of this pact as specified as above, unless it is discharged/ determined by the MD & CEO, BANK OF BARODA.

Section 10 – Other Provisions

10.1

This agreement is subject to Indian Laws and jurisdiction shall be registered office of the Principal, i.e. New Delhi.

10.2

Changes and supplements as well as termination notices need to be made in writing. Side agreements have not been made.

10.3

If the Contractor is a partnership or a consortium, this agreement must be signed by all partners or consortium members.

10.4

Should one or several provisions of this agreement turn out to be invalid, the remainder of this agreement remains valid. In this case, the parties will strive to come to an agreement to their original intentions.

10.5

Only those bidders/ contractors who have entered into this agreement with the Principal would be competent to participate in the bidding. In other words,



entering into this agreement would be a preliminary qualification.

For & On behalf of the Principal
Bidder/ Contractor

For & On behalf of the

(Office Seal)

(Office Seal)

Place-----

Date-----

Witness: _____

Witness:

(Name & Address) _____
Address)_____

(Name &

COST SUMMARY		
eVB TINSUKIA BRANCH AT TINSUKIA, ASSAM		
SR. NO.	DESCRIPTION	AMOUNT
1	CARPENTRY & LOOSE FURNITURE WORKS	
2	ELECTRICAL WORKS	
3	TOTAL COST	

PROJECT NAME - CARPENTRY WORKS FOR eVB TINSUKIA BRANCH OF BANK OF BARODA					
ADDRESS - AT TINSUKIA , ASSAM					
WORK TYPE- CARPENTRY WORKS					
SR.NO.	DESCRIPTION	UNIT	QNTY	RATE	AMOUNT
A.	CARPENTRY WORKS				
1	PARTITION WORKS				
	Note :- The rate shall be include of frame work above false ceiling level. Measurement should be taken up to false ceiling level and visible portion only.				
a	FULL HEIGHT SOLID PARTITION				
(i)	BOTH SIDE LAMINATE	SFT	120		
	Providing and fixing full height solid partition at places as mentioned in the drawing and as directed by the Architect/ EIC. The partition framing shall consist of Heavy duty Aluminium Box Sections 50mm x 50mm x 1.8mm thk @ 600mm c/c both ways Horizontally and Vertically. The vertical alternate frames to be fixed to the ceiling with necessary fixtures. The framing shall be finished with 8 mm thk. commercial ply on both side and finished with 1.00 mm thk. Laminate of approved shade and make and as directed by the architect. Rate shall be inclusive of necessary hardware items, etc. Complete. The edge beadings with steam beach wood should be finished with melamine Polish.				
b	FULL HEIGHT PARTLY GLAZED PARTITION	SFT	112		
	Providing and fixing full ht. partly glazed partition at places as mentioned in the drawing and as directed by the Architect/ EIC. The partition framing shall consist of Heavy duty Aluminium Box Sections 50mm x 50mm @ 600mm c/c Horizontally and Vertically . The vertical alternate frames to be fixed to the ceiling with necessary fixtures.The framing shall be fixed with 8/9 mm thk. commercial grade plywood on both side and finished with 1mm Laminate of approved shade and make . Approved make 5/6 mm thick itched Float glass or clear glass fixed with frosted film as per design, to be fixed at an height as mentioned in the drawing or as directed by the architect . The skirting should be as per approved laminate as per drawing and direction. Rate shall be inclusive of necessary hardware items, etc. Complete. The edge beadings with steam beach wood should be finished with melamine Polish.				
c	Full Ht Ht Solid Partition in Aesbostos Sheet with Door (Having Fire Rating of 3Hours for UPS Room) Finished with POP and approved shade of Acrylic Emulsion Paint	SFT	88		
	Providing & fixing in position Semi-Height Solid Partition in Aluminium frame work in 2'x 2' grid (horizontally and vertically) comprising of 50mm x 50mm x 1.8mm thk Aluminium Section covered with with 8 mm thick Aesbostos Sheet on both sides and finished with paint of approved make and colour as shown in drawing, on both sides. It shall also consist of a Flush door of required size and fixed with aesbostos Sheet in Aluminium sections on both sides and finished with paint of approved shade				
d	<u>SEMI HEIGHT SOLID/ SEMI GLAZED PARTITION FOR CASH CABIN AND OTHER AREAS</u>	SFT	196		
	Providing and fixing in position Semi Height Semi Glazed/ solid Partition at places as indicated in the drawing in Aluminium frame work in 2'x 2' grid (horizontally and vertically) comprising of 50mm x 50mm x 1.8mm thk Aluminium Section , fixed with 8/9 mm thk plywood on both sides and then finished with 1.0 mm thick laminate of approved shade and make in approved pattern. Item to include 8/10 mm thick itched glass or clear glass with frosted film of approved pattern. All edges should be fixed with T.W beading and should be finished in melamine polish of matching laminate colour as directed including wood preservative paint etc. as per list of approved material and as approved by the Project Consultant/ Bank complete in all respects.				
e	FULLY GLAZED PARTITION - WITH TOUGHENED GLASS	SFT	158		

	Providing and fixing of Fixed Glass partition with 10mm thick toughened glass using Standard fittings of above - mentioned makes at the top and grouting at the bottom with U - Shaped Aluminium rails and EPDM gaskets including cutting, making holes in glass and fixing the fittings in floors, false ceiling etc. and making the same good with necessary screw, sealant wherever required. The top fittings to be fitted to the Wooden section fixed above the Gypsum board in the level of GI channels of False ceiling.				
	USING OZONE / HAFFLE / YALE / GODREJ MAKE FITTINGS				
2	DOORS				
i	ENTRANCE DOORS - WITH TOUGHENED GLASS (PATCH FITTINGS)				
	Providing and fixing frameless fully glazed 12mm thk toughened float glass fixed with necessary patch fittings(Dorma make) including cutting, making holes, cutouts in the glass of required shape and size to accommodate fittings and fixing the fittings in floors, soffits, jams including necessary fixtures, screws, sealant wherever required and SS cover over patch fittings. Rate shall include necessary etching film / LOGO, approved patch fitting locking systems, 1 pair of 12" long S. S. (C Shape) Handles of approved make, floor springs, and any necessary hardware items.(ABOVE MENTIONED MAKES Top Pivot , Top Patch Fittings, Bottom Patch fittings , Floor Spring , Corner lock with strike plate and Euro Profile Cilinder, C Shape Handle 25mm dia X 300mm length)				
a	DOORS - WITH OZONE / HAFFLE / YALE / GODREJ MAKE FITTINGS	SFT	49		
ii	PARTLY GLAZED/ SOLID FLUSH DOOR (Without door frame) FINISHED ON BOTH SIDES WITH LAMINATE				
	Providing and fixing in position 35mm thick solid core flush door shutters conforming to IS 2202 with/ without(as per design) 6mm thick plain Clear Glass(vision panel) finished with frosting film of approved make as per design and pattern. The shutter is to be finished with 1.0mm thk laminate of approved shade and make on both the sides. All edges should be finished with Second Class Teak Wood lipping (minimum thickness 12 mm) with three or more coats of melamine polish. The glass shall be fixed with the flush door shutter by using suitable beading from both sides made out of second class teak wood. Rate shall include the cost of all approved quality hardwares required like nails, screws, handles, lock, heavy duty hinges, door stoppers etc. in case of veneer partition, the rate shall be inclusive of melamine polish of 2-3 coats or further as per the satisfaction of the architect/ engineer incharge, so as to achieve a glossy finish without any marks on the surface. Item to be completed in all respects as per drawings & instructions from EIC /Architect.				
a	FULL HT. DOOR WITH DOOR CLOSER	NOS	4		
b	SEMI HT. DOOR AT ENTRANCE TO CASH COUNTER PASSAGE	NOS	1		
c	2'-6" X 5'-6"/ 6'-0" TELLER COUNTER DOOR WITH NIGHT LATCH	NOS	2		
d	4'-0" high Wicked Door as per design	NOS	1		
3	PANELLING ON COLUMNS/WALLS/DOORS WITH/ WITHOUT FRAMING				
i	IN PLYWOOD FINISHED WITH LAMINATE FINISH	SFT	356		
	Providing and fixing panelling on walls/ columns with or without framing as per the directions of the architect. Framing if required and provided, shall consists of aluminium sections 50mm x 40mm(wall thickness 2mm) @ 2'-0" c/c both ways horizontally and vertically on the wall. The framing would be covered with 1/4" thk plywood finished in approved shade of laminate of thickness 1.0mm. Wooden moulding, lipping etc as directed by the architect shall be provided wherever required. The panelling should be done in such a way that it can house the sliding folding partition when fully opened and remain in flush with the panelling				
ii	PANNELLING WITH LECQUERED GLASS OF APPROVED SHADE	SFT	84		
	Providing and fixing of paneling with or without frame so as to receive a plain and even surface in exact plumb line , covered with 9mm thick commercial ply and finished with 6mm thick <u>TEMPERED LECQUERED GLASS</u> of approved shade and make as per the design . Rate shall be inclusive of 100 mm high skirting of silver metal laminate as and where required and as per the direction of the Consultant Architect/ Engineer.				
4	LOW HT RUNNING STORAGE (1'-6"DX2'-6"HT) (BACK CADENZA)	SFT	50		

	Providing and laying low ht Storage unit of sizes as mentioned above. They shall consist of 3/4" thk plywood for top, base and sides and base 1/4" thk marine plywood, 3/4" thk plywood shutter with self closing hinges of haffle make(full ovel open) & PVC lipping matching with the approved shade of laminate on all the edges. All external surfaces shall be finished with 1.0mm thk laminate of approved shade and make. Divisions of the shutter shall be make equally according to the length of the storage. A 3/4" thk fixed ply wood shelf on battens shall be provided @16" intervals from the base. Suitable wooden moulding (as per Architects design) with mellamine polish shall be provided to the edges of the storage top. All inner surfaces including shutters shall be finished with natural french polish. Rates shall be inclusive of all necessary approved fittings like hinges(haffle make), locks, 3" long brushed finish handle, tower bolts and any other misc hardware items of approved make				
5	FULL HT. STORAGE	SFT	256		
	Providing and fixing storage units of full height as per drwng. They shall consist of 18mm thk.comm. ply top, sides,back, bottom, shelves and shutters. The bottom of the storages shall be at 3" from FFL. The top of storages shall touch the false ceiling level or 7'-0" ht. The shutter with box type higes of approved make & steam beach lipping finished with melamine with approved laminate on all the shutter edges. Division of the shutters shall be made equally according to the length of the storages (as approved by Bank/ architect). All the external surfaces shall be finished with 1.0mm thk. Laminate (suede finish) of approved make. 18mm thk. Comm. Ply shelves removable type supported on side steam beach wood battens on both sides at 16" interval (approximately / divided equally) shall be provided. All inner surfaces shall be finished with laminate including the shutters. Rate shall be inclusive of all necessary approved fittings like hinges, locks, 150mm long SS brushed finish handles,tower bolts, locks and any necessary hardware items. The top ply edge should be fitted with 19mm x 7mm size steam beach moulding finished with melamine.				
6	SHUTTER BOXING	SFT	38		
	Providing and Fixing Shutter Boxing with 19mm thk Marine Ply and Finished with Aluminium Composite Panel. The boxing of shutter should be made opennable type for periodic maintainance. <u>Note the mode of measurement would be the multiplication of the length and the height of the boxing</u>				
7	GYP SUM BOARD CEILING WITH POP PUNNING	SFT	800		
	Providing and fixing 1/2" thk Gypsum India Board false ceiling at levels as shown in the drg. From the FFL. Rate shall be inclusive of all Gypsum India Components contained G.I perimeter channels of size 0.55 thk having one flange of 20mm and another flange of 30mm and a web of 27mm along the perimeter of the ceiling, screw fixed to brick wall/partition with the help of nylon sleeves and screws at 610mm centres. The suspending G.I intermediate channels of size 45mm, 0.9mm thk with two flanges of 15mm each from the soffit at 1220mm centres with ceiling angles of width 25mm x 10mm x 0.55mm thk fixed to soffit with G.I cleat and steel expansion fastner at every 610mm c/c. Ceiling sections of 0.55mm thk having knurled web of 51.5mm and two flanges of 26mm each with lips of 10.5mm are then fixed to the intermediate channel with the help of connecting clip and in directions perpendicular to the intermediate channel at 457mm centres. 12.5mm tapered edge Gypboard is then screw fixed to ceiling section with 25mm drywall screws driver or drilling machine with suitable attachment. The board are to be jointed and finished so as to have a flush look which includes filling and finishing the tapered and square edge of the boards with jointing compound & jointing paper tape. Rate shall be inclusive of any vertical ceiling part, cutouts for spot and				
	Note- Rates shall be inclusive of The drop/band of 6"-12" between the gypsum(at lower level) and Armstrong(at heigher level). No extra can be claimed for the same. Amount will be paid as per the measurement of the horizontal surfaces of Gypsum and Armstrong and nothing will be paid for vertical surface / band/ drop as it is all inclusive				
8	MODULAR FALSE CEILING- ARMSTRONG make	SFT	384		
	Providing and fixing Armstrong (Fine Fissured Micro Look with Tagular Edge using 15mm grid sections) false ceiling of size 24" X24" AT LEVELS AS SHOWN IN THE DRG. FROM THE FFL. Rates shall be inclusive of providing the total system with installation etc. The contractor has to maintain all ceiling tiles in good order and replace the defective tiles (at his own cost) before the handing over of the site.				

9	COLOURED ACRYLIC SHEET LOGO FOR THE BANK, (BACK LIT) OVERALL SIZE 450MM X 450	NOS	1		
	Supplying , fabricating and installation of BOB's Logo made of coloured acrylic sheet 5-6mm thk in box section, and as per the sizes as mentioned in the detailed drawings . This Coloured Acrylic sheet box logo should be fixed with light from inside so as to have a back lit , as per the direction of the architect.				
9	PAINTING & POP/ WALL PUTTY WORKS				
i	PLASTIC EMULSION (ONLY IN BANKING HALL)	S.FT.	300		
	Providing & applying plastic emulsion paint on walls, columns & ceilings. The rate shall include scrapping, levelling & preparing the surface. Primer coat + (minimum) 3 coats to get evenly spread quality finish (roller finish) of approved make , quality & finish shall be provided.				
ii	DISTEMPER PAINT AT STORE, UPS,PANTRY,TOILETS & OTHER NON-CUSTOMER AREAS	S.FT.	2000		
	Providing & applying distemper paint on walls, columns & ceilings at places as mentioned above and as directed by the architect. The rate shall include scrapping, levelling & preparing the surface. Primer coat + (minimum) 3 coats to get evenly spread quality finish (roller finish) of approved make , quality & finish shall be provided.				
iii	LUSTRE PAINT IN GYPSUM FALSE CEILING	S.FT.	900		
	Providing & applying Luster Paint on walls, columns & ceilings. The rate shall include scrapping, levelling & preparing the surface. Primer coat + (minimum) 3 coats to get evenly spread quality finish (roller finish) of approved make, quality & shade shall be provided.				
iv	ENAMEL PAINT IN ROLLING SHUTTER, COLLAPSABLE GATE , WINDOW GRILLS AND OTHER METAL WORKS	S.FT.			
	Providing & applying 1 st quality oil paint of approved make, quality & shade. The rate shall include scrapping, levelling & preparing the surface with primer quote.				
v	POP/ WALL PUTTY ON EXISTING WALLS (ONLY IN BANKING HALL)	S.FT.	300		
	Providing and applying POP Punning/ Birla Wall Putty on walls and columns (average 6mm thk). The rate shall include scrapping, levelling and preparing the surface. The rate shall include scrapping, levelling and preparing the surface. The rate shall be inclusive of all types of grooves above the skirting, around the windows and door frames. If the average thickness is found to be 4mm or less than POP/ Wall putty will be considered as a putti finish and the rate shall be 50% of the quoted rate				
	B. LOOSE FURNITURE WORKS				
1	DESK & DRAWERS				
i	OFFICER'S TABLE (2'3" x 4'-6" x 2'-6" ht)	NOS			
	Providing and fixing a desk of overall size of top as mentioned. It shall consist of 3/4" thk plywood top as per design(double edge on the front and the back with 1 1/2" thk half round moulding on the edges) supported on 3/4" thk plywood verticals. Suitable (as per architect's design) wooden moulding with mellamine polish shall be provided to the edges of the top. A 3/4" thk plywood apron shall be provided as per architect's design with necessary pattern. The table top shall be finished with 1.0 mm thk laminate of approved shade and all external surfaces to be finished with 1.0mm thk laminate of approved shade. Each top shall be provided with a pedestal (set of three drawers with central locking system either movable or fixed to the table), 1.no metal computer key board tray as per architect's design fixed with telescopic /double (haffle/albihari/solo make) sliders ,a 3" dia PVC wire manager of approved quality near the CPU/Monitor position as shown in the drg. 1 no Metal CPU Trolley to be provided below the desk as shown in the drg and a foot rest made out of 19mm thk plywood as per the design or as directed by the architect shall also be provide below the counter. All the inner surfaces shall be finished with Laminate finish of approved shade. Rates shall be inclusive of all necessary approved fittings like locks(godrej/vijayan make) for drawers and any misc. hardware items				
ii	CLERICAL TABLE (2'0" x 4'-0" x 2'-6" ht)	NOS			
	Specifications same as above but of overall size as mentioned here				
iii	MANAGER'S TABLE(2'-6" X 6'-0" X 2'-6") WITH 6MM THK CLEAR GLASS WITH POLISHED EDGES ON TABLETOP	NOS	1		

	Providing and fixing a desk of overall size of top as mentioned. It shall consist of 3/4" thk plywood top as per design(double edge on the front and the back with 1 1/2" thk half round moulding on the edges) supported on 3/4" thk plywood verticals. Suitable (as per architect's design) wooden moulding with mellamine polish shall be provided to the edges of the top. A 3/4" thk plywood apron shall be provided as per architect's design with necessary pattern. The table top shall be finished with 1.0 mm thk laminate of approved shade and all external surfaces to be finished with 1.0mm thk laminate of approved shade. Each top shall be provided with a pedestal (set of three drawers with central locking system either movable or fixed to the table), 1.no metal computer key board tray as per architect's design fixed with telescopic /double (haffle/albihari/solo make) sliders ,a 3" dia PVC wire manager of approved quality near the CPU/Monitor position as shown in the drg. 1 no Metal CPU Trolley to be provided below the desk as shown in the drg and a foot rest made out of 19mm thk plywood as per the design or as directed by the architect shall also be provide below the counter. All the inner surfaces shall be finished with Laminate finish of approved shade. Rates shall be inclusive of all				
iv	LINEAR WORK STATIONS (RUNNING COUNTER)-1050 MM WIDTH (WITH CUSTOMER LEDGE)	RFT	16.25		
	Providing and fixing a Clerical Desk/ Linear Work Station as per the width as mentioned above. Each top shall be provided with a pedestal (set of three drawers with central locking system either movable or fixed to the table), 1.no metal computer key board tray as per architect's design fixed with telescopic /double (haffle/albihari/solo make) sliders ,a 3" dia PVC wire manager of approved quality near the CPU/Monitor position as shown in the drg. 1 no Metal CPU Trolley to be provided below the desk as shown in the drg and a foot rest under the table as per design. All the inner surfaces shall be finished with Laminate finish of approved shade. Rates shall be inclusive of all necessary approved fittings like locks(godrej/vijayan make) for drawers and any misc. hardware items It shall consist of 3/4" thk. Comm. Ply top as per design (double edge on the front and back with 1 1/2" thk half round moulding on the edges) supported on 3/4" thk. Comm. Ply verticals at every 4'-6" length. Suitable (as per Architects design) wooden moulding with mellamine shall be provided to the edge of the top. The top of the counter should be finished with 1.0mm Laminate and all other external surfaces to be finished in 1.0 mm. Thk. Laminate (suede finish)of approved make. Afoot rest made out of 19mm thk plywood as per the design or as directed by the architect shall also be provide below the counter.Rates shall				
v	Same as Linear Counter as described above but without front glass and fixed to wall on one side	RFT	13.75		
vi	CASH COUNTER TABLE (EXCLUDING SIDE & REAR PARTTION)	RFT	9		
	Providing and fixing teller counter as shown in the drwng. It shall consist of 18/19 mm thk comm. ply. counter top & laminate finished ledge at 3' 6" height from FFL. The counter shall consists of 18/19mm thk. Comm. ply table top of size as per design as mentioned in the detailed drawings of Cash Counter and finished with 1.0mm thk laminate(suede finish) of approved shade and make in approved pattern . It shall be supported on 18/19mm thk. Comm. Ply verticals on either sides and finished with 1.0 mm thk laminate of approved shade and make. The counter shall be provided with a front apron made with 18/19mm thk commercial ply and finished with 1.0 mm thk laminate of approved shade and make.18/19mm thk plywood ledge 1'6" wide finished with approved shade of laminate alongwith edge moulded on both sides & 6" wide protruding (edge moulded) shall be provided at 3'-6" from FFL 12 mm thick clear toughened glass with machined polished edges shall be provided from the top of the ledge to 5' 6"- 6'-0" height and fixed on the sides with 4 1/2" gap at the bottom for teller supported on the sides by D clips.				

	1no. Computer key board tray (either ready made / made to the order as per architects design using 18/19 mm thk comm ply base and 1" x 2" round edged moulding on the front fixed with telescopic sliders(approved make), 1 no. 18/19 mm thk. Comm. ply for Shelf below the table shall be provided for the CPU, 2 / 3 nos. (equal sized) Drawer units shall be provided as shown in drgs. Drawer shall consist of 12mm thk. Comm. Ply, sides, back & base, facia of drawers shall be of 18/19 mm thk. Comm. Ply finished in 1 mm laminate with steam beach wooden moulding on edges of drawer units.. Each drawer shall slide on a pair of approved make telescopic drawer sliders, provision to accommodate currency notes of different denominations shall be provided on the top drawer unit, which should be finished with 1mm thick laminate. A 19mm x 7mm steam beach wooden moulding with mellamine shall be provided to the edge of the table. All the exposed surfaces shall be finished with 1mm laminate all inner surfaces excluding drawers to be finished with frenchpolish and inside of the drawers with melamine finish. A 12mm thick soft board of good density to be mounted over 12mm thick comm.ply below the customer top and in between space of staff counter. The soft board to be covered with plain fabric teal green colour (approx. cost Rs.250/mtrs) from front and edges.				
	Rate shall be inclusive of 12mm thk toughened glass and all necessary approved fittings like locks, handle, D-clips, telescopic channel, magnet etc. all complete				
	NOTE- Side & rear partition shall be paid extra as per actual measurement at site				
vii	SIDE CADENZA				
	Providing and laying side cadenza of above sizes and as mentioned in the drawing.It shall consist of 3/4" thk plywood top, side and bases and 1/4" thk back. The edges on th top shall be provided with suitable(as per architect's design)wooden moulding with melamine finish.A pair of 3/4" wood shutters will be provided which will slide on 1" x1" wooden battens above skirting. 1" a3/8" deep vertical depression shall be made on each shutters to act as handle as shown in the drawing. All external surfaces should be finished in 1.0mm laminate of approved shade and make. A 3/4" thk fixed ply wood shelf on battens shall be provided at 16" intervals from the base.Rates shall be inclusive of necessary approved fittings like sliding rollers, locks, tower bolts and any other misc. hardware items				
(a)	SIZE - 1050MM X 400MM X 750MM (For BM only)	NOS	1		
(b)	SIZE - 975MM X 400MM X 750MM	NOS	2		
viii	SUB-STAFF/ MAY I HELP YOU TABLE - 1050 MM X600 MM X 750MM	NOS			
	Providing and laying a Plain Table for Security Gurd with a Pencil Drawers for over all size of top as mentioned above. It shall consist of 3/4" thk. Comm. Ply top as per design (double edge on the front and back with 1 1/2" thk half round moulding on the edges) supported on 3/4" thk. Comm. Ply verticals at every 3' length. Suitable (as per Architects design) wooden moulding with mellamine shall be provided to the edge of the top. The top of the counter should be finished with 1.0mm Laminate and all other external surfaces to be finished in 1.0 mm. Thk. Laminate (suede finish)of approved make.				
ix	WALL MOUNTED WRITING TABLE 0'-10" TO 1'- 0" WIDE	RFT	4		
	Providing and Fixing wall mounted writing ledge as per design. The top shall be made of 19 mm thk plywood fixed with flexi ply to achieve curved surfaces on either sides as per design and fixed with 6mm thk corian , mirror polished, of approved shade and make. The ledge shall be provided with 10" high plywood selves with necessary partitions in between made out of 19mm thk plywood and finished with laminate of approved shade. ledge should be supported on 19mm thick comm. ply on rear side for fixing to the wall. The bottom ply piece to be supported additionally with 2 Nos. of SS Brackets.				
x	NOTICE BOARD	SFT	12		

	Providing and fixing notice board size as required/ directed (matching with the panel of the cabin) with openable shutter on the front. Made out of 19mm thick Steam beech veneered block board frame and outer frame in 2 1/2" x 1 1/2" Steam beech wood section , concealed hinges , locking arrangement , and glass of (5.5mm thick) with rear panel of SITATEX board , covered with fabric of approved shade. (Basic rate Rs.100/-per mtr , 48" width), fixed to back ply 6mm thick . All complete including melamine polish in stain of required shade. All complete as per approval of the Architect / employer				
xi	COMPLAIN BOX & SUGGESTION BOX	NOS	1		
	Supplying and erecting free-standing complain box of overall size 300 mm long x 200 mm deep x 450 mm high made of 19 mm thick phenol formaldehyde block board, all as in drawing, complete with hardware fittings and fixtures of approved make and quality.Top and all exposed surfaces of block board are to be finished with 1.00 mm thick laminate sheet of approved shade and quality. Inner faces of block board surfaces are to be finished with minimum two coats of synthetic enamel paint of approved shade and quality over a coat of approved primer.				
xii	CHEQUE DROP BOX	NOS	1		
	Supplying and erecting cheque drop box (overall size 450 mm x 300 mm x 750 mm) made of 19mm thick phenol formaldehyde bonded plyboard and the curved portion at top made out of 90 mm x 90 mm C.P teak wood section. A slit opening of 10 mm x 150 mm is to be provided at the top of the box. An openable shutter of 259 mm x 262 mm size made of 19 mm thick phenol formaldehyde bonded block board is to be provided at 1.50 mm above finished floor level. All the exposed timber surfaces including all free edges are to be finished with 1 mm thick laminate sheet of combination shade .Inner faces of block board surfaces are to be finished with minimum two coats of synthetic enamel paint of approved shade and quality over a coat of approved primer.Rate to include cost of necessary hardware fittings e.g. brass hinges, lock, knob etc. of approved designand quality.				
xii	VERTICAL BLINDS	SFT	264		
	Supplying and Fixing VERTICAL BLINDS Vista/Mac/Parytex make. Blinds made using 100% polyester with acrylic polymer coating, of the shade and colour as approved by the Arcitect/ Bank ffficial(only for external windows. In case of front facia necessary approval need to be obtained)				
	GRAND TOTAL				

ELECTRICAL WORKS FOR BANK OF BARODA BANK-TINSUKIA BRANCH

GENERAL NOTE

1	UPS input and Output wiring should be done with FRLS Insulated stranded copper conductor laid through M.S Conduit. (From input DB to UPS and
2	All wires for circuit wiring and other wiring should be drawn inside M. S. Conduits Only unless otherwise specified
3	Specifications of all wires should be followed strictly as mentioned in the BOQ
4	All makes of materials should be strictly followed as mentioned in the detailed specifications of the Tender document
5	Earthing Test Certificate MUST be provided alongwith the Final bill for further bill verification
6	Single Line diagram showing the all the wiring including point wiring, computer and RAW power wiring, Circuit wiring etc. all complete should be
7	Only DATA and Voice point wiring is allowed to be carried out through MS Conduits

PART A: ELECTRICAL WORKS

Sl. No	Description	Unit	Qty	Rate	Amount
SECTION-A					
1	MAIN SWITCH				
1.1.	S.I.T.C of following MCCB Unt with MCCB in sheet steel enclosure on M.S. angle frame / M.S. legs on wall complete with interconnection, mending good damages to original finish, painting, etc. as required.				
	40A 4P 25 KA MCCB	No.	1		
2	S.I.T.C. of Factory Manufactured Single/ 3 Phase & Neutral Double Door Distribution board made out of 16 SWG sheet steel enclosure with cutouts for operating MCB/MCCB/RCCB etc. knobs & consisting of Phase, Neutral & Earth Busbars with tapped holes , phase barriers, & covers with removable plates on Top & bottom for Incoming & Outgoing Cables . D.B.'s shall be flush mounting type for both single & three phase.				
2.1.	S.I.T.C. of TPN 4 way Double Door Vertical Distribution Board with following M.C.B./M.C.C.B./RCCB & cable end boxes at Input & Output. [Main VTPN]				
a	4 Pole ,Type C, 40 Amp 30KA RCCB as Incomer - 1 no.s				
	25A DP "C" Class MCB . for input to LDB - 1 Nos				
	25A DP "C" Class MCB for input to Raw PDB- 1 Nos. (Water Dispenser, Mobile Charger & Ancillary services Load)				
	25A DP "C" Class MCB for input to ACDB- 1 Nos.				
	16A SP "C" Class MCCB for Inverter INPUT AND OUTPUT- 2 Nos,				
	Note- Rates Shall be inclusive of S.I.T.C. 3X35 sqmm Armoured alluminium cable from the Main LT panel to the main DB including 4 X10 Sq.mm. F.R.L.S. Copper Flexible wires with 2 X 10 Smm Copper Earth Wires in Rigid MS conduit from 100 A MCCB in Metal Box (Metering Cabinet) at the output of Br. Meter to Main DB and any other ancillary items as directed by Engineer-in-Charge/ Architect.	No.	1		
	Note- FOR AC POINTS Rates Shall be inclusive of S.I.T.C. of 4 x 6.0mm² + 2x4.0 mm² F.R.L.S. copper flexible wires in 19/20 mm. MS conduit from Main Panel To AC points				
Section B					
3	MCB DISTRIBUTION BOARD				
	Supplying, installation, testing and commissioning of surface/recess mounting, 220/415 volts prewired MCB distribution boards with all switchgears as specified below, of sheet steel, dust protected, duly phosphatized and powder painted, inclusive of 200 amps tinned uniformly rated electrolytic copper bus-bar, common neutral link, earth bar, din bar for mounting MCB/MCCB/RCCBs detachable gland/knock out plates and with built in loose wire box, and superior make terminal connectors for all incoming and outgoing circuits, duly prewired with adequate size of FR MS insulated copper conductor upto the terminal connector/neutral link and ready for installation as specified below:				
3.1.	S.I.T.C. Of L.D.B. [MCB DB- LIGHT] (LIGHT DB)				
a.1.	S & I of 8 Way SPN, DB for distribution to all Light points of different areas (as indicated in the circuit diagram), having below mentioned switchgears (Earth bar inside these DB should be insulated from the body) - 25A, 30 mA, DP RCCB as incomer - 1 Nos, 6A SP MCB as outgoing 6 Nos.	No.	1		
	Note- Rates Shall be inclusive of S.I.T.C. of 3X 2.5 Sq.mm. F.R.L.S. copper flexible wires in 19/20 mm. MS conduit from Main D.B To L.D.B				
b	S.I.T.C. Of P.D.B. [MCBDB-POWER] (Raw Power DB)				

b.1.	S.I.T.C. of SPN 8 way Single door D.B. with Incomer 40Amp 30mA, DP RCCB - 1 No . 10A SP MCB-2 Nos. 6A SP MCB-4 Nos. with all wiring connections.(Max. 2 Points to be looped on one MCB, 3 nos. in exceptional case.)	No.	1		
	Note- Rates Shall be inclusive of S.I.T.C. of 3 X 4 Sq.mm. F.R.L.S. Copper Flexible wires in Rigid MS conduit from Main DB to Power DB				
c	S.I.T.C OF U.P.S. D.B. : (MCBDB-UPS)				
	S.I.T.C. of 8 way Single Door SPN D.B. with Incomer Double pole 30 mA 40 Amp RCCB - 1 No 10A SP MCB 6 Nos. with all wiring connections.(Max. 2 work-Station Points to be looped on one MCB, 3 nos. in exceptional case.)	No.	1		
	Note- Rates Shall be inclusive of S.I.T.C. of 3 X 4 Sq.mm. F.R.L.S. Copper Flexible wires in Rigid MS conduit from Main DB to MCBDB-UPS-1. (body to be earthed)				
d	S.I.T.C of 32 Amp. D.P. MCB in Metallic box for Inverter I./P. & O/P to LDB	No	2		
e	S.I.T.C of 32A DP MCB in Metallic box for UPS I./P.& O./P.	No	2		
f	S.I.T.C. Of ACDB [MCB DB- AC]				
	S.I.T.C. of 4 way Single door TPN Distribution Board with all wiring connections. Incomer : -25A TPN 30mA RCCB : - 1 No. Outgoing : - 20 A SP MCB : -4 Nos.	No.	1		
	Note- Rates Shall be inclusive of S.I.T.C. of 4 x 6.0mm² + 2x4.0 mm² F.R.L.S. copper flexible wires in 19/20 mm. Medium Guage MS conduit from Main Panel To ACDB				
	SECTION-C				
4	POINT WIRING				
4.1	Supply & Installation of concealed point wiring using 3 x 1.5 sqmm stranded FRLS copper conductor in M.S Conduit including the cost of circuit wiring from the relevant DB's with 3x 1.5 sq mm stranded FRLS copper conductor in M.S Conduit . PIN GRIP Lugs should be used for connection/ terminations at both the ends with proper colour coding of phase, neutral and earth wire (Phase R,Y,B Neutral-Black & Earth - Green Colour). The rate shall also include concealed M.S Box, Cover Plate and Switches of grid plate type switches and sockets of approved shade and make as approved by Bank / Architect. Each circuit should not have more than 8 points / 800 W in one loop as per the following configuration.				
i	Single Light points, Call Bell controlled by 6 Amp switch.	Pts	14		
ii	Two Light points controlled by one 6 Amp Switch	Pts	12		
iii	Three Light Points controlled by one 6 Amp Switch	Pts	1		
iv	Primary light points including the cost of 6A switch in UPS Power	Pts	6		
b	Secondary 6A Plug point on switch board. [SO]	Pts	4		
c	16/6 A Plug Point directly taken from PDB for hotplate/geyser / zerox / fridger etc.	Pts	3		
d	Exhaust fan/ Wall Fan point consisting of 6A socket near fan and switch on light switch board	Pts	14		
e	Wiring for Signages with 2R x2.5 Sq.mm and 1 Rx 1.5 Sq.mm, PVC insulated copper conductor flexible cable to be connected to the SPN D/D consumer along with a Timer and Contactor unit installed in Electrical Room room	Set	1		
f	S.I.T.C. of call bell with bell point .	Nos.	1		
4.2	COMPUTER/ RAW POWER WIRING				
	Note- All sockets should be placed below the workstations as mentioned in the drawings but the controlling switch should fixed above the work stations and at place as directed by the architect				
a	Supply & Installation of concealed UPS or stabilized power plug points on workstations / table for computers using 3 x 2.5 sqmm stranded FRLS copper conductor in M.S Conduit including the cost of circuit wiring from the relevant DB's with 3 x 4.0 sq mm stranded FRLS copper conductor in M.S Conduit . PIN GRIP Lugs should be used for connection/ terminations at both the ends with proper colour coding of phase, neutral and earth wire (Phase R,Y,B Neutral-Black & Earth - Green Colour). Each point shall consist of 3 Nos of 6A/16A 2 / 3 Pin sockets and 1 No 16A switch, wired together forming one point. Switches and sockets to be of approved shade and make. (Only 2 tables served by one circuit from UPS DB/ Not more than 2 points shall be permitted per loop) Cost is inclusive of necessary cutting the walls/ partitions and carrying all the wires through M.S Conduit and againg finishing the walls with Putty/ Cement/ POP to receive the final paint.. [SOC]	Pts	11		

b	S & I of points similar to above but to be used as raw power point on the tables consisting of one 6/16A socket with switch of other color and flexible cable of black color & circuit taken from Raw Power DB (2 tables (Maximum 3) served by one circuit from LDB/PDB) Taken Above False ceiling and through walls/ partitions inside M.S. Conduits as raceways are not provided. Cost is inclusive of necessary cutting the walls and including M.S. Conduits as required for taking the wires.	Pts	13		
SECTION-D					
5	Supply, Installation, Testing and Commissioning of EARTHING				
5.1	Earthing with Copper earth plate 600 x 600 x 3 mm thick including accessories, and providing masonry enclosure with cover plate having locking arrangement and watering pipe of 2.7 meter long etc with charcoal/ coke and salt as required. Rate shall be inclusive of Providing & fixing 25 mm x 5 mm Cu strip on surface or in recess for connection as required.	Each	1		
5.2	Earthing with GI earth plate 600x600x3mmthick including accessories, and providing masonry enclosure with cover plate having locking arrangement and watering pipe of 2.7 meter long etc with charcoal/ coke and salt as required.Rate shall be inclusive of Providing & fixing 25 mm x 5 mm G.I. strip on surface or in recess for connection as required.	Each	1		
SECTION-E					
6	LIGHTING FIXTURES (Bajaj or equivalent)				
6.1	S & I of lighting fixtures as per the details given below including necessary hardware such as clamps,nuts, bolts, nails, screws and suspension chains as required for fixing the fixtures in position as directed by architect / Consultant.				
a	PANEL LIGHT [PL] - Ultra Slim LED Panel made from extruded aluminium housing frame (recess / pendant) 2ft x 2ft , Wattage-30W, CCT- 4000 K, of Phillips, Havells, Bajaj, Wipro or equivalent as approved by the Engineer-incharge/ Architect.	No	15		
b	DOWN LIGHT [DL] - Round LED recess-mounted designer panel with aluminium die cast housing , Wattage-18W, CCT- 4000 K, of Phillips, Havells, Bajaj, Wipro or equivalent as approved by the Engineer-incharge/ Architect.	No	16		
c	S.I.T.C. of12/13 Watt 6000/6500 K,(≥720 lumens) Recessed/Surface mounted LED Down Lighting Fixtures with fixing accessories. As Emergency Light	No	6		
d	1200 MM TUBE LIGHT [TL] - LED batten tubes, Glaze LED Batten, High quality aluminium extruded with decorative end caps, Wattage-20W, CCT- 4000 K, of Phillips, Havells, Bajaj, Wipro or equivalent as approved by the Engineer-incharge/ Architect.	Each	7		
e	600 MM TUBE LIGHT [TL] - LED batten tubes, Glaze LED Batten, High quality aluminium extruded with decorative end caps, Wattage-20W, CCT- 4000 K, of Phillips, Havells, Bajaj, Wipro or equivalent as approved by the Engineer-incharge/ Architect.	Each	3		
6.3.	Supplying including fitting fixing of following star rated new 450 mm dia bracket/wall fan in metal body and metal blade of Orient Electric (TORNADO Wall Black Metal) or equivalent of approved make , complete with all accessories with necessary connection cable, as approved by the Deptt.s etc. as required complete and as directed by the Bank				
	a) 400- 450 mm sweep	EACH	11		
6.4	Supply and fixing of 10" - 12" Metal bladed exhaust fans with louvers.[EF]	EACH	3		
7	WIRING FOR DATA AND VOICE OUTLETS				
7.1	Supplying, laying and termination of 4 pair Copper solid, twisted pair G600 CAT-6 cables through specified dia MS conduits / raceways. Cables must meet and exceed category 6/ class E standards requirements in ISO/IEC11801, CENELEC EN50173 & TIA 568-B2-1. and providing & terminating with RJ-45 (Krone make) with face plates / I/O Ports in suitable modular / MS box from server / EPABX room to individual work stations and terminating other end with RJ-45 connector including numbering with ferule. Note- Rates shall be all inclusive as mentioned in the description above and the payment for the same item shall be made on the number of points provided based on the above description. Rates shall be inclusive of 5'-0" long patch chord with crimping on both ends				
a	RJ-45 for data points (THROUGH False ceiling and wall)	points	11		
7.2	Supplying, laying and fixing of 19", 9U SS Rack Mount Recessed Frame for DATA Terminations. Rate shall be inclusive of Patch Panel etc. all complete	Nos	1		
8	A.C POINT WIRING				

	A.C. power point wiring from AC DB with 1100 volt grade 2 Nos. single core 6 sq.mm. + 1 No. 4 sq.mm. (Green colour for earthing) PVC insulated flexible FRLS copper conductor cable through suitable size M.S. conduit (ISI marked embossed on conduit surface) complete with junction box, circular box, elbows, bends, couplers and other accessories on surface above false ceiling or concealed by chase cutting on wall complete with North-West make AC power unit having 25A DP MCB with enclosure, 25A Socket, 20A Starter, mounting box & front plate, interconnection, mending good all damages to original finish, painting etc. as required. All connections of wires to be done by means of 'Wago' type connectors. Each Ac will be connected through Inverter to be located near the ACDB. Rates shall be inclusive of cost of wires, wirings, sockets,starter, testing all complete	NOS	4		
9	MISCELLENOUS WORKS				
9.2	4 Pole 63 Amp Manual Changeover Switch For Mains to D.G. supply switching (If D.G. Back-up is provided). Rates shall be inclusive of complete wiring and no payment for wiring shall be entertained for this item of work	No	1		
A	TOTAL OF ELECTRICAL & OTHER RELATED WORKS				

LAYOUT REVISED-2 ON 14.12.2022

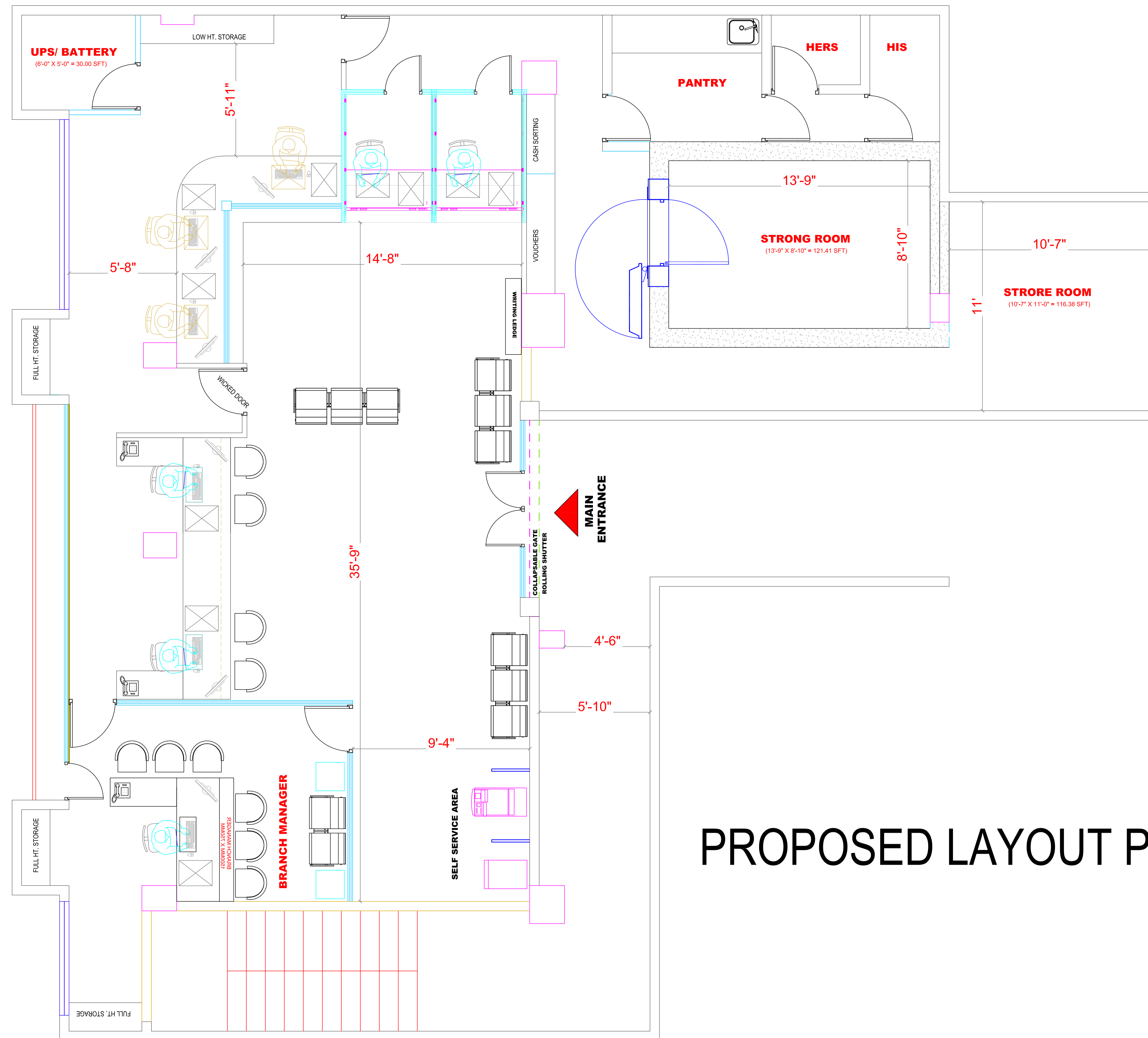

PROPOSED LAYOUT PLAN OF TINSUKIA BRANCH

CLIENT
BANK OF BARODA
 JORHAT REGIONAL OFFICE
 CRYSTAL ENCLAVE, 1ST FLOOR,
 SEUNI ALI, BARPOOL, JORHAT, ASSAM

Description of Proposal.

**PROPOSED LAYOUT PLAN OF TINSUKIA BRANCH
 AT TINSUKIA, ASSAM**

FIRST FLOOR PLAN CARPET AREA- 1652.00 SQ. FT

JOB NO.	DATE	SCALE	DEALT BY	CHKD BY	DRG NO.
			AR. DEBOJYOTI DEBROY		

SIGN & STAMP

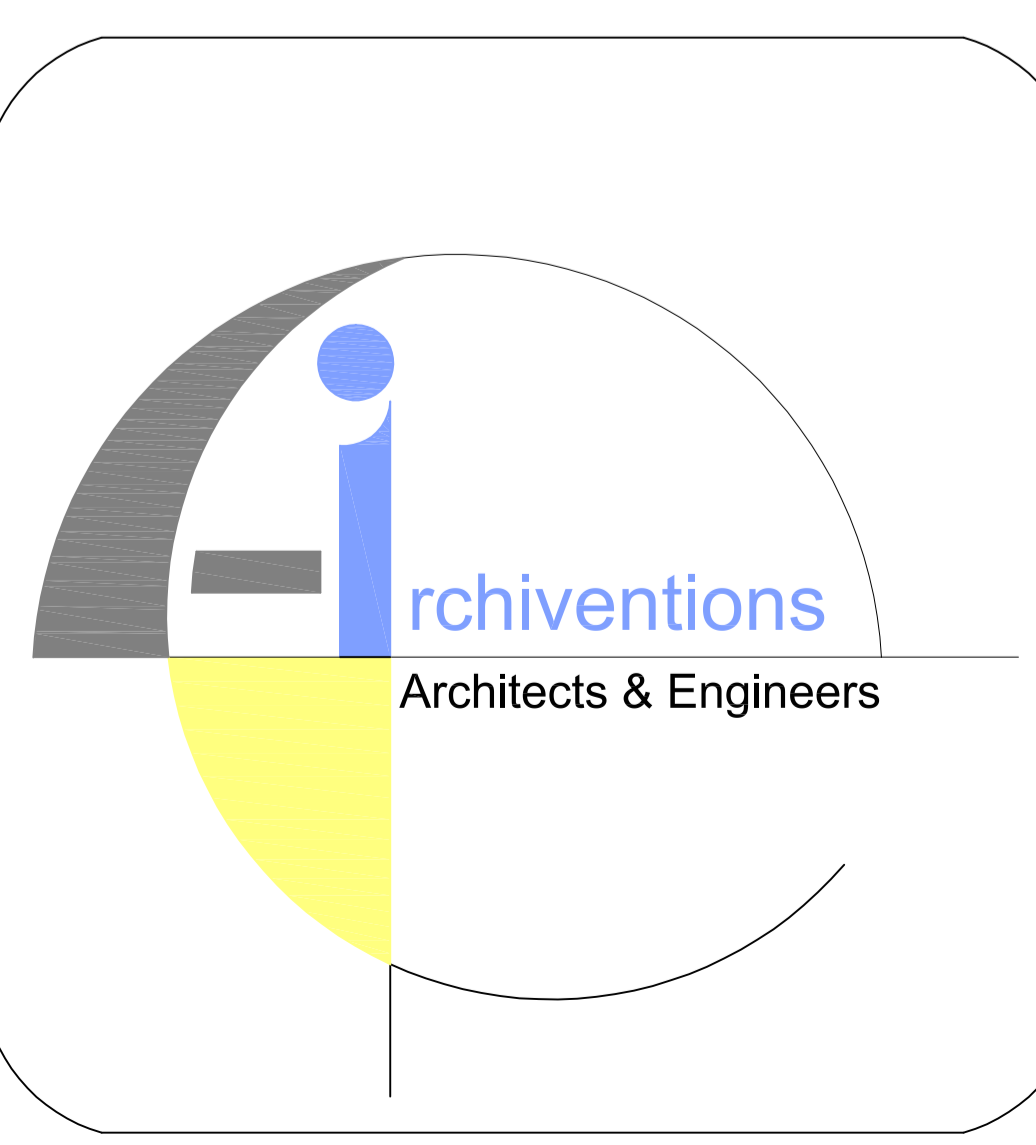

FIRM NAME & ADDRESS

ARCHIVENTIONS
 Architects , Planners & Interior Designers
 C.O.A. Regd. No.- CA / 2004 / 32922

ADDRESS
 ABOVE KALITA ENTERPRISES, 1ST FLOOR
 BANK OF INDIA ZOO RD BRANCH BUILDING
 JONALI, R.G. BARUAH ROAD, GUWAHATI
 ASSAM-781024, PH-9854062928/ 0361-2970463

FLOOR PLANS