

BANK OF BARODA

REGIONAL OFFICE, GREATER KOLKATA

BARODA TOWER (3rd Floor), PLOT NO. -38/2,
BLOCK – GN, SECTOR -V, SALT LAKE CITY,
KOLKATA – 700 091, INDIA



TENDER DOCUMENT FOR

Refurbishment of Office space at
Shyamnagar

LAST DATE OF SUBMISSION : 15-01-2025 at 03.00 PM
Contact Details : Premises and Equipment's
Department
Regional Office, Greater Kolkata
Ph : (033) 23401435

Bank of Baroda
Regional Office, Greater Kolkata

Bank of Baroda invites sealed **Tenders** in Two-bid system from experienced Contractors for **Refurbishment (Composite Work) of Office space at Shyamnagar**, which includes Civil, Plumbing, Carpentry, Furnishing, Electrical, LAN Cabling and associated works in accordance with Bank's General Conditions of Contract, Special Terms & Conditions of Contract & Particular Terms & Conditions of Contract, Standard specifications, Extent of Work, Special Instructions to Bidders as appended on the subsequent page & Annexures.

- a) Name of work : **Refurbishment (Composite Work) of Office space at Shyamnagar having address: 437, Garulia Main Road, Shyamnagar P.O Garulia Dist North 24 Parganas West Bengal -743133.**
- b) Time of Completion : 30 days
- c) Earnest Money : **₹.14,500 /-(Rupees Fourteen Thousand Five Hundred Only)** by crossed Demand Draft/ Pay Order payable at Kolkata and drawn in favor of Bank of Baroda to be submitted with the Bid.
(Tender without earnest money in proper form will be rejected)
- d) Retention money : 5% of total certified bill amount
- e) Release of Retention Liability : Retention money will be released after Defect Period of 1 (One) year from the date of payment of the final bill after adjusting all dues, if any, from the contractor.
- f) Availability of Tender Document : Tender form has to be downloaded from the Bank's website **www.bankofbaroda.co.in** (tender section). Application form available on website alone needs to be used. Tender forms will be available on Bank's website from **02-01-2025 till 15-01-2025 upto 3:00 p.m.**
- g) Date of Commencement : Either one week from the date of acceptance of work order or the day on which contractor is instructed to take possession of the site, whichever is later.
- h) Time and date of Submission of tender : **Upto 03.00 P.M. on 15-01-2025.**
- i) Time and date of Opening of Technical Bid : **At 4.00 P.M. on 15-01-2025.**
- j) Venue of Opening Tenders : Bank of Baroda
Regional Office, Greater Kolkata
Baroda Tower (3rd Floor), Plot No. -38/2,
Block – GN, Sector -V, Salt Lake City,
Kolkata – 700 091, India
- k) Tender to be addressed and submitted to: The Dy. General Manager & Regional Head

Bank of Baroda, Regional Office, Greater Kolkata, Baroda Tower (3rd Floor), Plot No. - 38/2, Block – GN, Sector -V, Salt Lake City, Kolkata – 700 091, India.

- l) Clarification, if any to be obtained from: M/s Dhar & Associates Pvt. Ltd
7, Red Cross Place, 4th Floor
Kolkata -700001
LL-033- 2213-1496 Mob: 9830266062
- m) Validity of Tenders : 6 (Six) calendar months from the last date of submission of Tender.
- n) Defects liability period : 12 (twelve) months from the date of payment of the final bill.
- o) Taxes : **GST at applicable rate shall be paid as extra**
- p) Delay in submission : Delay in submission of Tender arising due to Postal or any other irregularities at any stage will not be considered. The Bank will not be responsible for any damage in transit in case of postal delivery / delivery through courier service.
- q) All tenders in whom any of the prescribed conditions are not fulfilled or are incomplete in any respect are liable to be rejected.
- r) The acceptance of tender will rest with Bank of Baroda which does not bind itself to accept the lowest or any tender and reserves to itself the right to reject any or all the tenders received without assigning any reason/s thereof.
- s) In case the date of opening of tenders is declared as a holiday, the tenders will be opened on the next working day.
- t) **Conditional Tenders will be summarily rejected.**

Retention money: The Retention percentage (i. e. deduction for interim bill) shall be 5% of the gross value of each interim bills. The Retention Money will be released after 1(one) year (Defect Liability Period) from the date of payment of the final bill provided the contractor has satisfactorily carried out all the works and attended to all defects in accordance with the conditions of the contract, including site clearance.

Defects liability period shall be as per memorandum. It must be realized that this period is for exposure of “Latent Defects”. The DLP commences from the date of payment of the final bill for a period of 12 months.

After opening the envelope containing the offer on the standardized conditions and opening of the priced tender, no correspondence will be entertained.

Prior to opening of Financial Bid, Bank of Baroda/ Deputed Architect, at their discretion may inspect the on - going/completed works of the Contractors as well as obtain confidential report from the concerned employers. The bids of tenders who do not fulfill the above criteria will summarily be rejected. The Bank also reserves to itself the right of accepting the whole or any Part of the tender and the tenderers shall be bound to perform the same at the rates quoted.

Sealed tender shall be submitted in Two separate envelopes consisting of the following:

1. **Cover 1:** Letter of empanelment, Earnest Money Deposit, Tender Document & Annexure – A
2. **Cover2:** Price Bid

All the above 2 (two) sealed envelopes are to be submitted in a single Covering envelope, duly super-scribed “**Tender for Refurbishment (Composite Work) of Office space at Shyamnagar,**” and submitted to the address mentioned in clause – k hereinabove.

NOTE:-

- i) The agency will be fully responsible for correctness of all documents submitted along with the tender. False documents may lead to rejection of their bid.
- ii) Bank does not bind itself to accept the lowest or any tender and reserves the right to accept or reject any or all tenders either in whole or in part, without assigning any reasons whatsoever.
- iii) No conditions will be entertained. Conditional offers shall be summarily rejected. Disputes, if any, will be subject to Kolkata jurisdiction only.
- iv) Canvassing in connection with tenders is strictly prohibited and the tenders submitted by the contractors who resort to canvassing will be liable to rejection.
- v) ***MSEs are exempted from paying Tender/RFP fee/cost, EMDs as per MSME Act 2012. For getting the benefits in case of MSE firms, contractors /agencies should submit exemption certificate issued from the relevant authorities.***

ANNEXURE - A

Mandatory information required of the bidder
(To be furnished on the letterhead of the bidder)

Important Note:

1. Please type or handwrite in capital letters.
2. Attach copies of the supporting documents.
3. Attach extra sheets with Sr. No if the space found is insufficient.
4. Applications of those agencies who do not furnish below mentioned information, will be summarily rejected.

1	a) Name of the applicant / organization b) Address of the Registered Office c) Address of office at Kolkata/ Burdwan. (Name of Contact Person along with Phone Nos, Email ID)	
2	Year of establishment	
3	Type of the organization (Whether sole proprietorship, Partnership, Private Ltd. or Ltd. Co. etc.) (Enclose certified copies of documents as evidence)	
4	Registration of firm under Shop & Establishment Act 1948	
5	Address of Kolkata office through which the proposed work of the Bank will be handled and the Name & Designation of officer-in-charge.	
6	Enclose copy of latest income tax clearance certificate.	
7	PAN No.	
8	GST Registration No. with Certificate	
9	Empanelment with other Companies/PSUs	
10	Other infrastructural information to be used/ referred for this project. List of available plants, machineries equipments etc.	
11	Whether any Civil Suit / litigation arisen in contracts executed / being executed during the last 10 years. If yes, please furnish the name of the project, employer, Nature of work, Contract value, work order and brief details of litigation. Give name of court, place, and status of pending litigation.	Attach a separate sheet if required.
12	Information relating to whether any litigation is pending before any Arbitrator for adjudication of any litigation or else any litigation was disposed off during the last ten years by an arbitrator. If so, the details of such litigation are required to be submitted.	

13	Have you been ever disqualified or levied penalty by the bank in past for non-fulfillment of the contractual obligations. If yes, please provide details.	
14	Have you in past carried out any works for Bank of Baroda or its subsidiaries? If yes, give details.	

GENERAL CONDITIONS OF CONTRACT

- 1 Tenders shall remain open to acceptance by the Bank for a period of 180 days from the date of opening of Part-II of the tender which period may be extended by mutual agreement and the tenderer shall not cancel or withdraw the tender during this period.
- 2 The tenderer must use only the forms displayed on the bank's website to fill in the rates. (Any addition/ alteration in the text of the tender form made by the tenderer shall not be valid and would be liable of rejection).
- 3 The tender form must be filled in Hindi / English and all entries must be made by hand and written in ink. The rate and amount should be in figures and words. If any of the documents is missing or unsigned, the tender may be considered invalid by the Bank Representative in its discretion.
- 4 Rates should be quoted both in figures and in words in columns specified. All erasures and alterations made while filling the tender must be attested by initials of the tenderer. Overwriting of figures is not permitted and failure to comply with either of these conditions will render the tender void at the Bank's option. No advice of any change in rate or conditions after the opening of the tender will be entertained.
- 5 Each of the Tender documents should be signed by the person or persons submitting the tender in token of his/their having acquainted himself/themselves with the General Conditions of Contract, General Specifications, and Special Conditions etc., as laid down. Any tender with any of the documents not so signed will be rejected.
- 6 The tender submitted on behalf of a firm shall be signed by all the partners of the firm or by a partner who has the necessary authority on behalf of the firm to enter into the proposed contract. Otherwise the tender may be rejected by the Bank.
- 7 The Bank does not bind itself to accept the lowest or any tender and reserves to itself the right to accept or reject any or all the tenders, either in whole or in part, without assigning any reasons for doing so.
- 8 Intending tenderers shall pay an interest free Earnest Money Deposit for a sum of **₹.14,500 /-(Rupees Fourteen Thousand Five Hundred Only)** by a demand draft / Banker's Cheque in favour of Bank of Baroda, payable at Kolkata. Tender not accompanied by earnest money deposit will not be considered. The earnest money deposit of unsuccessful bidders shall be refunded after the work order is issued to selected bidder.
Under no circumstances earnest money deposit will be accepted in the form of fixed deposit receipt or Bank or Insurance guarantee or Cheque.
- 9 The Earnest Money Deposit of ` **₹.14,500 /-(Rupees Fourteen Thousand Five Hundred Only)** paid by the successful tenderer shall be held by the Bank as security for the execution and due fulfillment of the contract. No interest shall be paid on the said deposit.

- 10 On receipt of intimation from the Employer of the acceptance of his/their tender, the successful tenderer shall be bound to implement the contract agreement within Fourteen days thereof, the successful tenderer shall sign the agreement in accordance with the draft agreement and the schedule of conditions but the written acceptance by the Bank of a tender will constitute a binding contract between Bank of Baroda and the person so tendering, whether such formal agreement is subsequently executed or not. The cost of necessary stamp paper for execution of the agreement shall be borne by successful tenderer.
- 11(a) In addition to the Earnest Money Deposit, successful tenderer shall further deposit 1% of accepted tender value. Thus Bank will keep 2% of accepted tender value as initial security deposit. Total 5% of the accepted tender value may be kept as retention money which includes security deposit and retention money.
- 11(b) All compensation or other sums of money payable by the contractor to the Employer under the terms of this contract may be deducted from his earnest money and security deposit if the amount so permits and the contractor shall, unless such deposit has become otherwise payable within ten days after such deductions make good in cash the amount so deducted.
- 12 The Contractor shall not without the written consent of the Bank assign this Contract, and shall not without the written consent of the Bank (which consent shall not be unreasonably withheld to the prejudice of the Contractor) sublet any portion of the work. Bank may serve a notice in writing on the Contractor rescinding the contract, whereupon the security deposit shall stand forfeited to the Employer, without prejudice to his/other remedies against the Contractor.
- 13 The Contractor shall carry out all the work strictly in accordance with drawings, details and instructions of Bank's Architect & Engineer. If in the opinion of the Bank Representative, changes have to be made in the design and with the prior approval in writing of the Bank's Representative, they desire the Contractor to carry out the same, the Contractor shall carry out the same without any extra charge.
- 14 A schedule of Probable Quantities in respect of each work and Specifications accompany these Special Conditions. The Schedule of Probable Quantities is liable to alterations by omissions, deductions or additions at the discretion of the Bank. Each tender should contain not only the rates but also the value of each item of work entered in a separate column and all the amounts quoted against various items should be totaled in order to show the aggregate value of the entire tender.
- 15 The tenderer must obtain for himself on his own responsibility and at his own expense all the information which may be necessary for the purpose of making a tender and for entering into a contract and must examine the Drawings, inspect the site of the work, acquaint himself with all local conditions, means of access of the work, nature of the work and all matters pertaining thereof.

- 16 The rates quoted in the tender shall include all charges for clearing of site before commencement as well as after completion, water, electric consumption, meters, double scaffolding, centering, boxing, staging, planking, timbering and pumping out water including bailing, fencing, hoarding, plant and equipment, storage sheds, watching and lighting, by night as well as day including Sundays and Holidays, temporary plumbing and electric supply, protection of the public and safety of adjacent roads, streets. The rates quoted shall be deemed to be for the finished work to be measured at site. The rates shall also be firm and shall not be subject to exchange variations, Labour conditions, fluctuations in railway freights or any conditions whatsoever. **The quoted rates shall not include applicable GST, which shall be paid in addition to the quoted rates.**
- 17 The Contractor should note that unless otherwise stated the tender is strictly on item rate basis and his attention is drawn to the fact that rates for each and every item should be correct, workable and self-supporting. The quantities in the Schedule of Quantities approximately indicate the total extent of work but may vary to any extent and may even be omitted thus altering the aggregate value of the Contract.
- 18 Time allowed for carrying out the work as mentioned in the Memorandum shall be strictly observed by the tenderer and it shall be reckoned from the tenth day after written order to commence the work is issued. The work shall throughout the stipulated period of the Contract be proceeded with all due diligence and if the Contractor fails to complete all the work within the specified period he shall be liable to pay compensation of the Conditions of Contract/ work contract. The tenderer shall before commencing work prepare a detailed work program which shall be approved by the Employer. Contractors have to pay Liquidated damages against delay of the work @ 1 % per week of delay of the estimated amount shown in the tender or contract amount whichever is higher per week. Maximum liquidated damages will be 10 % of the accepted contract sum.
- 19 Tenders will be considered only from recognized bonafide contractors in trade concerned. Each tenderer shall submit with his tender a list of large works of a like nature he has executed giving details as to their magnitude and cost of the proportion of work done by the Contractor in it and the time within which the work were completed.
- 20 The Contractor shall not be entitled to any compensation for any loss suffered by him on account of delays in commencing or executing the work, whatever the cause of delays may be, including delays arising out of modification to the work entrusted to him.
- 21 The successful tenderer is bound to carry out any or all items of work necessary for the completion of the job even though such items are not included in the quantities and rates. Schedule of instructions in respect of such additional items and their quantities will be issued in writing by Bank.
- 22 The successful tenderer must co-operate with the other contractors appointed by the Employer so that the work shall proceed smoothly with the least possible delay and to the satisfaction of the Bank.
- 23 The contractor must bear in mind that all the work shall be carried out strictly in accordance with the specifications made by the Bank and also in compliance of the requirements of the local public authorities and no deviation on any account will be permitted.

- 24 The tenderer shall have to use materials of the makes/manufacturers specified in the list of material approved brand and/or manufacture contained in this tender form.
- 25 The Contractor shall strictly adhere to the rules laid down by the Housing Society for carrying out repair & renovation works in the premises. Any penalty/ fine imposed by the Society due to non-adherence of laid down rules has to be borne by the Contractor.
- 26 The contractor shall strictly comply with the provision of safety code annexed hereto.
- 27 I.S. Code numbers wherever mentioned in the tender shall be the latest version of I.S. codes as on the date of opening of Tenders.
- 28 The security deposit of the successful tenderer will be forfeited if he fails to comply with any of the conditions of the Contract.
- 29 All disputes and differences of any kind whatever arising out of or in connection with the contract or the carrying out of the works (whether during the progress of the works or within 12 months from the date of virtual completion of the work and whether before or within 12 months of determination abandonment or breach of the contract) shall be referred to giving inter-alia full details of the matter under dispute like quantities, rates, amount claimed and the reason thereto and settled by the Bank who shall state his The Arbitrator shall have power to open up, review and revise any Certificate, opinion, decision requisition or notice, save in regard to the excepted matters, referred to in the preceding Clause and to determine all matters in dispute which shall be submitted to arbitration and of which notice shall have been given as aforesaid. The Arbitrator shall make his award within one year (or such further extended time as may be decided by him or them as the case may be with the consent of the parties) from the date of entering on the reference. In case during the arbitration proceedings the parties mutually settle, compromise or compound their dispute or difference, the reference to arbitration, the reference to arbitration and the appointment of the Arbitrator shall be deemed to have been revoked and the arbitration proceedings shall stand withdrawn or terminated, with effect from the date on which the parties file a joint memorandum of settlement thereof; with the Arbitrator or the Arbitrators as the case may be. The submission shall be deemed to be a submission to arbitration within the meaning of the Arbitration & Conciliation Act, 1996 or any statutory modification thereof. It is agreed that the Contractor shall not delay the carrying out of the works by reason of any such matter, question or dispute being referred to arbitration, but shall proceed with the works with all due diligence and shall, until the decision of the Arbitrator or Arbitrators as the case may be, is given.
- 30 **CONTRACTOR TO INFORM HIMSELF FULLY:**
- The contractor shall be deemed to have carefully examined the work and sited conditions including Labour, the general and special conditions, the specifications, schedules and drawings and shall be deemed to have visited the site of work, to have fully informed himself regarding the local conditions and carried out his own investigations to arrive at the rates quoted in the tender. In this regard he will be given necessary information available with the department but without any guarantee about its accuracy.

If the contractor shall have any doubt as to the meaning of any portion of the general conditions, or the special conditions or the scope of the work or the specifications and drawings or any other matter concerning the contract he shall in good time, before submitting his tender, put forth the particulars thereof and submit them to the Bank, Kolkata in writing in order that such doubts may be clarified authoritatively in writing before tendering. Once a tender is submitted, the matter will be decided according to tender conditions in the absence of such authentic pre-clarification.

I/We hereby declare that I/We have read and understood the above instructions for the guidance of tenderers.

Signature of Bidder with Seal

SPECIAL CONDITIONS OF THE CONTRACT

1. The wood to be used should have similar / uniform grains and should be totally free from white portions, decay, knots etc.
2. All the edges of the plywood should be teak wood beadings. The beading to be fixed with adhesive / screw/ nails.
3. The measurements indicated in the drawings are approximate and may vary as per the site conditions. Bank's Engineer/ Architect's interpretation of the design and the specifications mentioned in the entire document shall be final and without appeal. In case of Errors or inconsistency, if discovered in the drawing and specifications, Bank's Engineer/ Architect's interpretation shall be final and without appeal.
4. The contractor shall submit the Bar Chart & PERT chart before commencement of work and the progress chart during the course of work.
5. For the design and other details mentioned in the entire document Bank's Engineer/ Architect alone has the patent right.
6. The contractor shall take the prior approval from Bank's Engineer/ Architect for subletting the job even if the same is to a specialized agency.
7. In case Bank's Engineer/ Architect rejects a particular work the tenderer shall remove the same within two days and no payment shall be made for such work.
8. The Contractor has to take all safety measures with regard to the workmen employed as per relevant laws and good engineering practices at site and safety measures against the fire hazard.
9. The contractor has to make necessary arrangement for internal lighting at the site.
10. The contractor has to carry out the job strictly as per specification spelt out in the bill of quantities, the drawings, instructions that may be issued by the Engineer-in-charge and the specification of the Bureau of Indian Standards, National Building Code etc.
11. In case of any discrepancy between the specifications and the drawings, the details mentioned in the specifications / Bill of quantities may be taken as final.
12. The electrical installation works are to be carried out by engaging licensed electrical contractor. The successful tenderer shall submit the photocopy of Electrical Contractor's license at the time of execution of work. The copy of license of Electrical Supervisor and electricians also are to be submitted.
13. The contractor shall submit the single line drawing of electrical installations/wiring of completed work along with the final bill.
14. The contractor shall submit the Test Certificate of the Electrical installations carried out by him as per requirement of local Electrical supply Authority, Indian Electricity Rules, and Indian Electricity Act.
15. The work shall be carried out on holidays and Sundays after and before office hours and during office hours on working days. The Contractor shall ensure that there shall not be any problem, disturbance in office/other areas/floors as the work is to be executed in working office.
16. The Contractor shall depute one electrician and one helper during office hours to avoid any electrical breakdown in electrical installation.

17. The contractor has to carry out the job strictly as per specification spelt out in the bill of quantities, the drawings, instructions that may be issued by the Engineer-in-charge and the specification of the Bureau of Indian Standards, National Building Code etc.
18. Contractors shall insure whole work against fire, PICT and third party.
19. In case of any discrepancy between the specifications and the drawings, the details mentioned in the specifications / Bill of quantities may be taken as final.
20. The work will be awarded to the Agency that has given the lowest rate (L-1).

Additionally, the L2 Bidder will be asked to confirm if he can do the work at the lowest rates quoted by L1.

If the L2 gives a letter confirming that he is ready to carry out the work at the lowest rate (L1), then it can be considered to award the work to him also. The condition of this award of work to L2 on the rates of L1 will be as under:

1. When L1 denies in writing that he does not have capacity to do the work.
2. When it is observed by Bank's Engineer/ Architect. That L1 has not completed more than 3 sites in time.
3. When defects are found in the work of L1.
4. When L1 does not take up the work as assigned within the stipulated time period as mentioned in the work order.

PREAMBLE TO THE BILL OF QUANTITIES

The work proposed is to be carried out at the Office premises mentioned on the cover page (no.1) of the tender. The premise is proposed to be provided with Furnishing, civil, plumbing, electrical, LAN cabling works. The quality of work proposed should have the best workmanship. The contractor should ensure that only the first quality materials mentioned in the list of material is purchased for the project.

1. The work should be carried out in such a way that the structure is not disturbed.
2. Any difference / discrepancies in the specification should be clarified with the Engineer in charge before submitting the tender. The Engineer in charge will have the liberty to modify the specification to a reasonable limit to suit the basic concept during the course of work; the tenderer should carry out such work without any extra cost.
3. In case of any major modification such items will be considered as an extra items. Payment for such items will be paid based on the Engineering rate / Market rate analysis. 15% of the total cost of material & Labour will be considered as tenderer's profit.
4. The contractor should co-ordinate with the other contractors employed at the site for smooth flow of work.

FORM OF TENDER

To,
The Dy. General Manager & Regional Head
Bank of Baroda, Zonal Office, Kolkata
Baroda Tower (3rd Floor), Plot No. -38/2,
Block – GN, Sector -V, Salt Lake City,
Kolkata – 700 091, India.

Dear Sir,

Re: “Tender for Refurbishment (Composite Work) of Office space at Shyamnagar”

Having examined the plans/ specifications and schedule of quantities, and satisfying ourselves as to various conditions stated, I/we hereby offer to execute the above works at the respective rates which I/we have quoted for the items in the Schedule of Quantities.

I/ we enclose demand draft/ banker's cheque for ₹.14,500 /-(Rupees Fourteen Thousand Five Hundred Only) towards Earnest Money deposit for the execution of the works at my/ our tendered rates, together with any variations at later stage, should the work be awarded to me/ us.

In the event of this tender being accepted, I/we agree to enter into and execute the necessary contract required by you. I/ We do hereby bind myself/ourselves to forfeit the aforesaid deposit of ₹.14,500 /-(Rupees Fourteen Thousand Five Hundred Only) in the event of our refusal or delay in signing the Contract Agreement. I/we further agree to execute and complete the work within the time frame stipulated in the tender documents.

I/we agree to pay GST, Sales Tax, Works Contract Tax, Excise Tax, Octroi, VAT, Duties, all Royalties and all other applicable taxes prevailing and be levied from time to time on such items for which the same are Leviable and the rates quoted by me/us are inclusive of the same.

I/we understand that you are not bound to accept the lowest tender or bound to assign any reasons for rejecting our tender. I/we further understand that Bank of Baroda may award Contracts to more than one Contractor and that I/ we shall make no claims whatsoever if Bank of Baroda accept only a part of my/ our tender. We unconditionally agree to Bank of Baroda's preconditions as stipulated in the tender documents.

Bank reserves the right to terminate our contract and forfeit the Earnest money deposit paid by us in additions to recovery of all the dues to the Bank from the payment receivable by us. Further we may also be barred from tendering in future for the Bank and its subsidiaries.

Any Commercial disclosure in the Envelope No. 1 will disqualify me/ us without any further scrutiny.

I/we enclose herewith the completed tender documents duly signed in duplicate.

Yours truly,

[To be signed by the Authorized Representative of
Tenderer holding Power of Attorney]

Place:

Date:

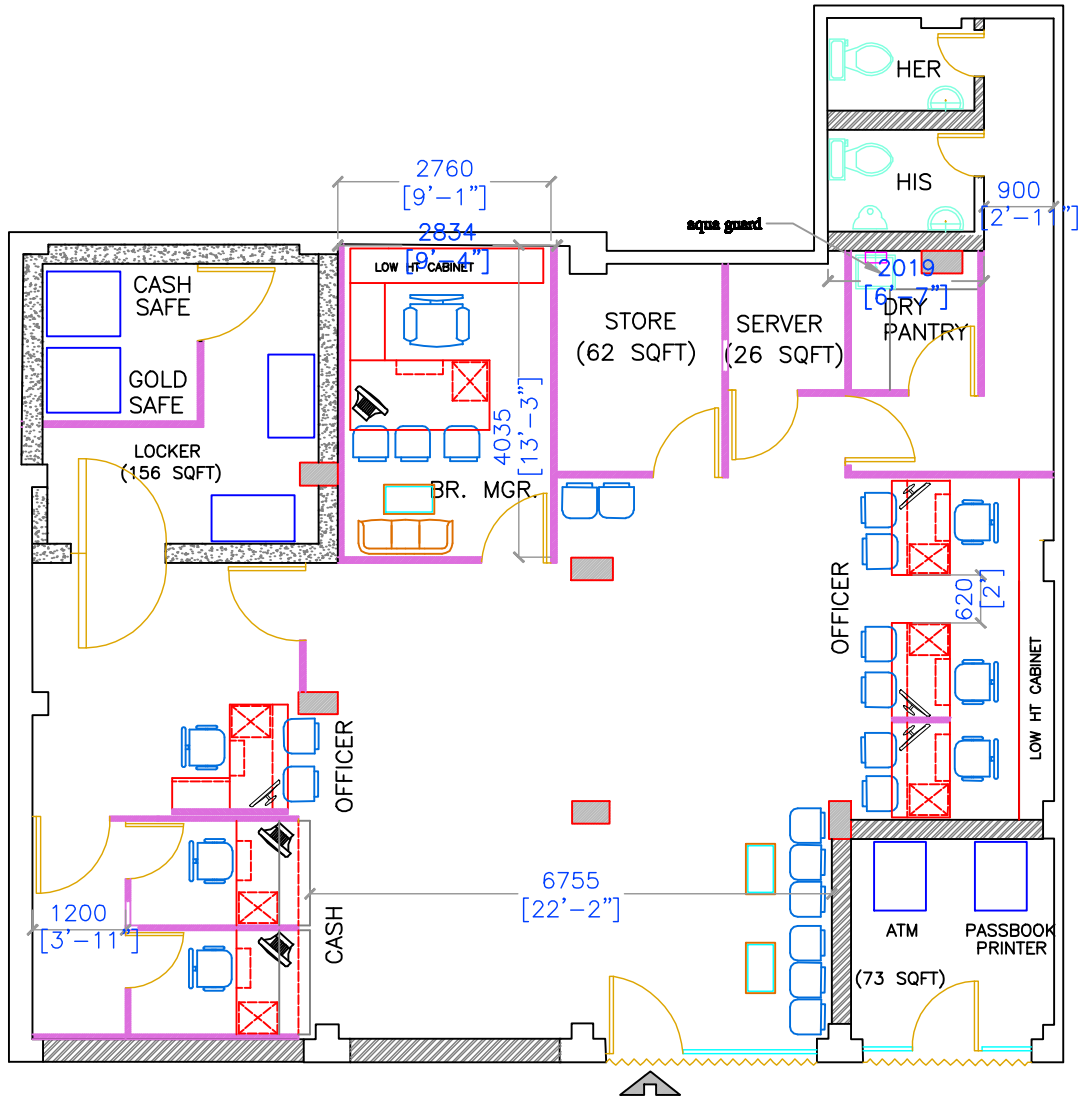

GROUND FLOOR PLAN

CARPET AREA: 146.52 SQ.MT = 1577.14 SQ.FT



NAME	DATE		CLIENT- BANK OF BARODA	ARCHITECT- DHAR & ASSOCIATES (P) LTD. KOLKATA.	
TRD			TITLE- PROPOSED INTERIOR LAYOUT OF SHYAMNAGAR BRANCH	PROJECT- INTERIOR WORK OF SHYAMNAGAR BRANCH	
DRN	M.KAR	30.10.24			DRG.NO-
CHD	A.Dhar.	30.10.24			DA/INT/BOB-2426/SYMN/C-1
APPD					

This drawing is the property of M/S Dhar & Associates (P) Ltd. and cannot be copied or re-produced without their written permission.

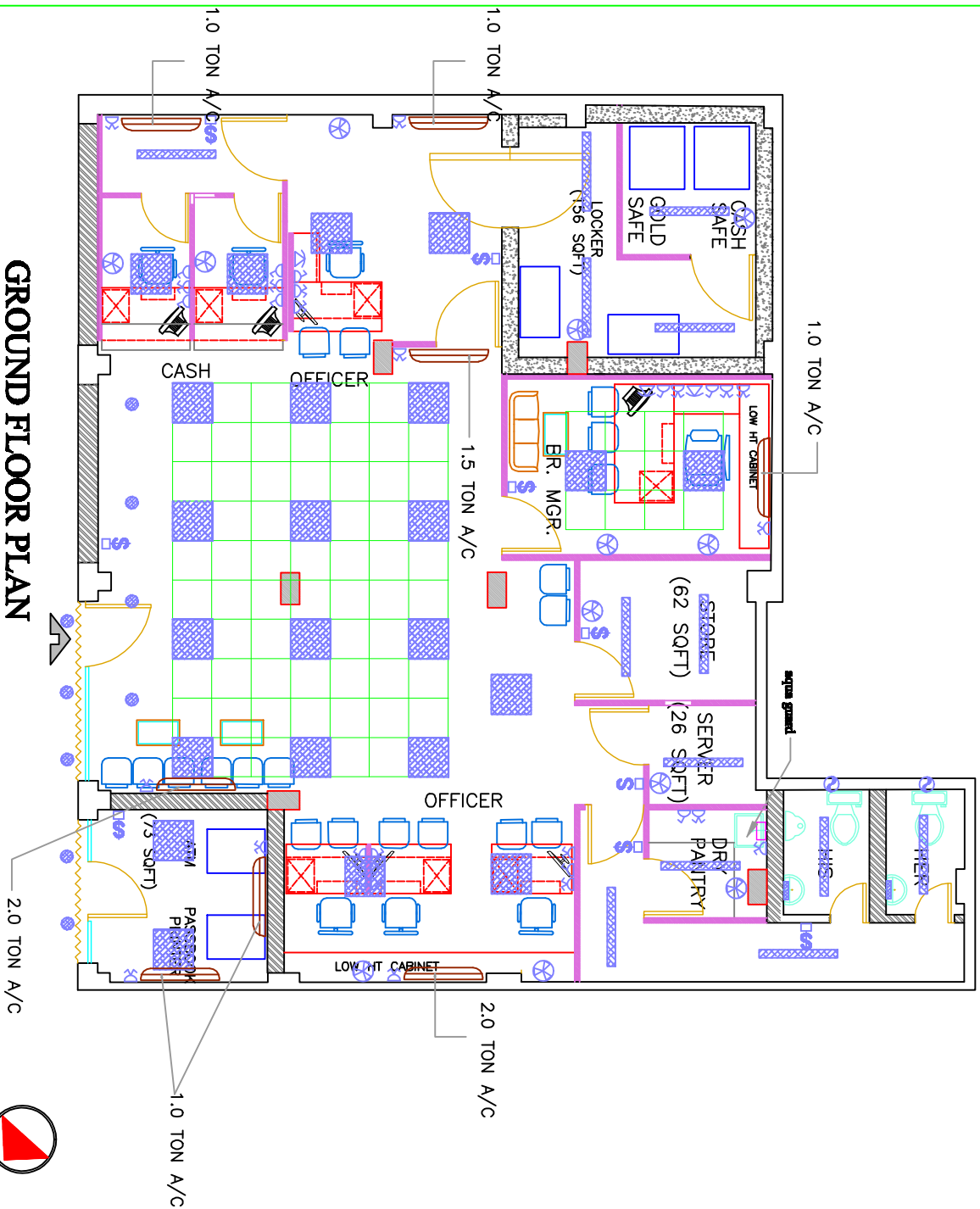

GROUND FLOOR PLAN
CARPET AREA: 146.52 SQ.MT = 1577.14 SQ.FT



NAME	DATE	CLIENT- BANK OF BARODA	ARCHITECT- DHAR & ASSOCIATES (P) LTD. KOLKATA.	DRG.NO-
TRD				
DRN	M.KAR 30.12.24	NTS		
CHD	A.Dhor. 30.12.24		PROJECT- INTERIOR WORK OF SHYAMNAGAR BRANCH	DA/INT/BOB-2426/SVMN/E-1
APPD				

This drawing is the property of M/S Dhor & Associates (P) Ltd. and cannot be copied or re-produced without their written permission.

APPROVED MAKE LIST OF MATERIALS

CIVIL & FURNISHING WORKS		
1	False Ceiling / Channels	India Gypsum / Armstrong /AMF / Saint Gobain
2	Aluminium Frame Work / Aluminium Section	Jindal / TATA
3	Wood Skirting / Moulding / Lipping / Beading	C P Teak
4	Wood Preservative	STP Pentaphene Pale / Termiseal by PCI / Bison by British Paint
5	Fire Reterdant Paint	Industrial grades of Noble / Viper
6	Commercial Ply	Century / Greenply / Archid / Austin / Avenger / Globe Ply
7	Marine Ply with ISI : 710 mark	Century / Greenply / Archid / Austin / Avenger / Globe Ply
8	BWP Block board (IS : 1659) Flush Door	Century / Greenply / Archid / Austin / Avenger / Globe Ply
9	Laminate (0.5 mm & above thk.)	Formica / Greenlam /Centurymica / Sunmica
10	Door Closure (Heavy Duty)	Ebco / Ozone / Dorma / Godrej
11	Floor Spring (Heavy Duty)	Ebco / Ozone / Dorma / Godrej
12	Door Lock (Dead)	Godrej / Ebco
13	Door Handles	Godrej / Hafele /Hettich / Ebco
14	Drawer / Storage Handle	Godrej / Hafele /Hettich / Ebco
15	Drawer / Storage Lock (Multipurpose)	Godrej / Hafele /Hettich / Ebco
16	Night latch	Godrej / 4C Acme
17	Screws	GKW / Nettle fold
18	Hinges	CIEF / Godrej / Palam / Hettich
19	Sliding Telescopic Drawer Channel	Godrej / Ebco / Kombo / Innofit / Palam
20	Cable Organiser	Ebco / Innofitt Systems (CM 63.C)
21	Adhesive	Fevicol SH / Araldite
22	Soft Board	Jolly Board
23	Vertical / Roller Blinds	Mac / Vista / Wincab
24	Glass	Modiguard /AIS / Saint Gobain
25	Paints (Synthetic Enamel / Acrylic Emulsion)	Asain Paints / Berger / Dulux
26	PVC Flooring	Krishna Vinyl / Armstrong / Birla
27	Texture Paint	Asain Paints / Berger / Dulux
28	WPC 3DPanel	Alutuff / Murrato
29	European WC / Washbasin	Hindware /Parryware
30	Sanitary Fittings	Jaquar / Hindware
31	G.I. Pipe	Tata (Medium) / Jindal
32	Cement	Ultratech / Ambuja / ACC
33	Footmat	Birla 3M / Approved Equivalent
34	Vitrified Tiles	Johnson / Kajaria / Nitco / ASL
35	Ceramic Tiles	Johnson / Kajaria / Nitco / ASL
36	Polyester fibre panels/ Acoustics wall panel	Times / Armstrong / Anutone
37	ACP	Alucobond / Alstone / Euroboard
38	Wooden Flooring	Pergo / Armstrong / Egger or similar
39	Carpet tiles	Unitex / Modulyss / Japan
40	Veneer (4 mm.)	Century / Green
41	Corian (6 mm.)	DUPOINT/HI-MAC/ STARON / Merino or equivalent
42	Glass Etching Film	Garware / 3M / LG
43	All other items not covered above	As per sample approved by Bank

ELECTRICAL WORKS

1	Switch fuse / fuse switch units (HRC) (32A TPN &above)	L & T / Siemens/ Schneider/ ABB/ Legrand
2	Timer (TSQ 100)	L & T
3	Voltmeter & Ammeter	A. E. / IMP
4	Voltmeter & Ammeter selector switches	KAYCEE / L & T / Siemens
5	Phase indicating lamp	L&T, Vaisno, Teknic
6	Capacitor	CROMPTON/SIEMENS
7	HRC fuses	GE power / SIEMENS / L & T / SCHNEIDER
8	Power Cable : XLPE Al armoured (ISI marked)	POLYCAB / HAVELLS / NICCO
9	HRC fuse base & carriers.	GE power / SIEMENS / L & T / SCHNEIDER
10	1.1KV grade PVC insulated & sheathed / insulatedcopper wire & flexible cords (ISI marked).	POLYCAB / FINOLEX / HAVELLS
11	RCCB / ELCB / MCCB	LEGRAND / SIEMENS / HAGER / HAVELLS
12	Switch fuse with rewirable fuses. (6A - 32A TPN)	LEGRAND / SIEMENS / HAGER / HAVELLS
13	Isolator / MCB	LEGRAND / SIEMENS / HAGER / HAVELLS
14	Changeover switch (on load type)	LEGRAND / SIEMENS / HAGER / HAVELLS
15	MCB distribution board (Double Door)	LEGRAND / SIEMENS / HAGER / HAVELLS
16	Distribution fuse board with rewirable fuses	LEGRAND / SIEMENS / HAGER / HAVELLS
17	6/16 Amp modular switch / socket, module plate &mounting M.S. / PVC box.	CRABTREE / LEGRAND / ANCHOR
18	16/25 Amp., 2 module electronic regulator	CRABTREE / LEGRAND / ANCHOR
19	Ceiling rose	KAY / EPP / ANCHOR / JJ
20	Holder	KAY / EPP / ANCHOR / JJ
21	Alarm bell	KHERAJ / GETCO / KONE / ANCHOR
22	PVC conduits	CAP/Finolex/Polycab
23	Compression type brass gland	DOWELLS / JOHNSON / COMET
24	Cable termination socket	DOWELL'S
25	Light fitting & lamps	PHILLIPS / HAVELLS / WIPRO / OSRAM
26	Ceiling / Wall Mounted Fan	CROMPTON / USHA / BAJAJ / HAVELL'S
27	Exhaust fan	CROMPTON / POLAR / KHAITAN / HAVELL'S
28	Industrial type socket & top	HAVELL'S / CROMPTON / LEGRAND
29	Telephone / TV cable	Delton, Skyline, Finolex, Rallison, Batra Henley
30	STARTERS	NORTH WEST / CABTREE
31	RACKS	ComRack / HCL / ValRack / APW President
32	All other items not covered above	As per sample approved by Bank

B.O.Q AND ESTIMATE FOR CIVIL, FURNISHING, FURNITURE FIXTURE, ELECTRICAL AND COMPUTER WORK FOR SHYAMNAGAR BRANCH UNDER GREATER KOLKATA OF BANK OF BARODA.

PART-A CIVIL AND ALLIED WORKS					
Sl.No.	Description Of Works	Unit	Qty	Rate	Amount
				Rs.	Rs. P.
1	<u>PAINTING</u>				
1.1	Providing and applying plastic emulsion of approved colour & shade, cleaning the surface and make it free from dust by scrapping, cleaning etc., including application of two coats acrylic putty of approved make over the walls to make it the same in line and level; application of primer coat over the same; application of minimum two or more coats of plastic emulsion of Paints equivalent upto the desired finish of the Architects and protecting till the handing over of site including required scaffolding, cleaning, filling up cracks with approved crack filler etc. all complete at all levels and leads to entire satisfaction of the Architects.	Sqm	250		
1.2	Supply and application of two coats of synthetic enamel paint of approved brand and manufacturer to give an even shade over a coat of primer after thorough sand papering, pully work and cleaning of the surfaces all complete as per direction of our Architect.	Sqm	10		
1.3	White washing three or more coats including cleaning and smoothening (5 parts of stone lime and 1 part of shell lime in the finishing coat).	Sqm.	0		
2	<u>WALL PUTTY WORK</u>				
	Applying Wall Putty Work about 1:5mm thk.as per direction to wall, coloumns incl. preparation of base and supply of materials at all levels over cement plaster as per specification and direction by our Architect.	Sqm	250		
3	<u>FALSE CEILING</u>				

B.O.Q AND ESTIMATE FOR CIVIL,FURNISHING,FURNITURE FIXTURE, ELECTRICAL AND COMPUTER WORK FOR SHYAMNAGAR BRANCH UNDER GREATER KOLKATA OF BANK OF BARODA.

Sl.No.	Description Of Works	Unit	Qty	Rate	Amount
				Rs.	Rs. P.
	<p>GYPBOARD – Providing and fixing suspended false ceiling which includes providing and fixing G.I peremeter channels of size 0.55 m. of thick having one flange of 20mm and another flange of 30 mm and a web of 27 mm along with peremeter of ceiling screw fixed to brick wall/ partition with metal slaves and screws at 600 mm centers. Then suspending GI intermediate channels of size 45mm 0.9mm thick two flanges of 15mm each from the soffit at 1220mm centres with ceiling angle of width 25mm x 10 mm x 0.55mm thk. fixed to soffit with GI cleat and steel expansion fastners, ceiling section of 55 mm thick having knurled web of 51.5mm and two flanged of 26mm each with lips of 10.5 are then fixed to intermediate channels with the help of connecting clips and in direction perpendicular to the immediate channel at 457mm centres 12.5 mm tapered edge Gyp board conforming to IS 2095 – 1982 is then screw fixed to ceiling position 25mm sky wall screws at 230 mm centres, finally teh boards are to be jointed and finished, so as to have a flush look which includes filling and finishing the tape shade and square edges of the boards with jointing compound paper tape and two coats of primer and two coats of acrylic emulsion paint of approved make and desired colour suitable for Gyp Board(as per manufacturers specification)</p>	Sqm	80.22		
4	<u>FALSE CEILING</u>				
	<p>Providing and fixing of false ceilings at all heights of 600 mm x 600 mm x 16 mm ceiling tiles of type Prima Dune Premier-Beveled Tegular Edge RH-99 laid on 15mm exposed grid system. The framework comprise of main runner spaced at 1200mm centers securely fixed to the structural soffit by approved hangers at 1200mm maximum centers. Hangers (GI wire of 4.0mm dia) to be fixed by approved roof plug, level adjusters</p>				

B.O.Q AND ESTIMATE FOR CIVIL,FURNISHING,FURNITURE FIXTURE, ELECTRICAL AND COMPUTER WORK FOR SHYAMNAGAR BRANCH UNDER GREATER KOLKATA OF BANK OF BARODA.

Sl.No.	Description Of Works	Unit	Qty	Rate	Amount
				Rs.	Rs. P.
	and screws etc. The last hanger at the end of each main runner should not be greater than 450mm from the adjacent wall. Flush fitting 1200mm long cross tees (with double stitching) to be interlocked between main runners at 600mm centers to form 1200 x 600mm modules. Cut cross tees longer than 600mm to be supported independently. 600mm x 600mm modules to be formed by fitting 600mm long flush fitting cross tees centrally between the 1200m cross tees All Complete as per design and direction by our Architects.	Sq.M.	38.52		
PART-`A' TOTAL CARRIED TO GENERAL SUMMARY					-
PART-B	FURNISHING WORK				
1	FULL HEIGHT PARTITION (OPAQUE)				
	Supplying and erecting full height opaque partitions (upto 2450 mm high) as per drawing and conforming to the following specifications				
	Basic frame work :				
	Aluminium Square Hollow Section-SHS (49.5mmx49.5mmx2.6mm) at minimum 450 mm c/c both ways horizontal or vertical spacings as per site condntions. Vertical members shall be suitably extended upto anchored and cross- tied at ceiling level.				
	Exposed frame members in the Solid portions shall be finished with 1 mm thick laminate sheet of same or combination shades, over layer 6 mm thk. Firewall solid Ply (IS 5509) facing including 4x4 mm grooves at locations as per instruction.				
	Skin membrane :				
	solid portion with double layer 6 mm thick Firewall solid Ply (IS 5509) on each face at the top layer as per drawings/ instructions				
	Finishing :				

B.O.Q AND ESTIMATE FOR CIVIL, FURNISHING, FURNITURE FIXTURE, ELECTRICAL AND COMPUTER WORK FOR SHYAMNAGAR BRANCH UNDER GREATER KOLKATA OF BANK OF BARODA.

Sl.No.	Description Of Works	Unit	Qty	Rate	Amount
				Rs.	Rs. P.
	1 mm thick laminate sheet of same or combination shades as per instructions.				
	Quoted rates shall include all necessary materials, accessories and labour and also allow provisions for electrical/Telephone/ computer wiring conduits and switch boxes, etc. (Materials for wiring conduits and switch boxes shall be separately paid for.)	Sqm	91.78		
2	<u>FULL HEIGHT PARTITION (PARTLY GLAZED)</u>				
	Supplying and erecting full height partly glazed partitions (upto 2450 mm high) as per drawing and conforming to the following specifications				
	<u>Basic frame work :</u>				
	Aluminium Square Hollow Section-SHS (49.5mmx49.5mmx2.6mm) at minimum 450 mm c/c both ways horizontal or vertical spacings as per site conditions. Vertical members shall be suitably extended upto anchored and cross- tied at ceiling level.				
	Exposed frame members in the glazed portions shall have wider spacings (approx. 1800 mm. clear)as per instructions. Exposed members shall be finished with 1 mm thick mica laminate sheet of same or combination shades, over single layer 6 mm thk. Firewall solid Ply (IS 5509) as per instruction				
	<u>Skin membrane :</u>				
	solid portion upto 300 mm from floor level and from 2100 mm to false ceiling with single layer 6 mm thick Firewall solid Ply (IS 5509) on each face as per drawings/ instructions				
	<u>Finishing :</u>				
	1 mm thick laminate sheet of same or combination shades as per instructions.				
	<u>Glazing :</u>				

B.O.Q AND ESTIMATE FOR CIVIL,FURNISHING,FURNITURE FIXTURE, ELECTRICAL AND COMPUTER WORK FOR SHYAMNAGAR BRANCH UNDER GREATER KOLKATA OF BANK OF BARODA.

Sl.No.	Description Of Works	Unit	Qty	Rate	Amount
				Rs.	Rs. P.
	8 mm. thick clear float glass fixed with continuous steam beech wood glazing beads of approved shape (finished 35 x 25 mm) all round , polished and coated with NC lacquer finish. The rate should also include cost for decorative etching Film on one side of the glass.				
	Quoted rates shall include all necessary materials, accessories and labour and also allow provisions for electrical/Telephone/ computer wiring conduits and switch boxes, etc. (Materials for wiring conduits and switch boxes shall be separately paid for.)	Sqm	8.94		
3	<u>HALF HEIGHT PARTITION</u>				
	Supplying and erecting Low height Partition (upto max. 1200 mm. High) as per drawing and conforming to the following specifications :				
	<u>Basic frame work :</u>				
	Aluminium Square Hollow Section-SHS (49.5mmx49.5mmx2.6mm) at minimum 450 mm c/c both ways horizontal or vertical spacings as per site condtions. Vertical members shall be suitably extended upto anchored and cross- tied at ceiling				
	<u>Skin Membrane :</u>				
	6mm. thk. Firewall solid Ply (IS 5509) on both side, as per drawing/ instructions.				
	<u>Finishing :</u>				
	1 mm thk. laminate sheet of same or combination shades as per instructions.				
	<u>Edge moulds :</u>				
	All free top/end surfaces shall have polished steam beech wood moulds of approved shape (from 80 x 25 mm sections) with NC lacquer in mat finish.				
	<u>skirting :</u>				

B.O.Q AND ESTIMATE FOR CIVIL,FURNISHING,FURNITURE FIXTURE, ELECTRICAL AND COMPUTER WORK FOR SHYAMNAGAR BRANCH UNDER GREATER KOLKATA OF BANK OF BARODA.

Sl.No.	Description Of Works	Unit	Qty	Rate	Amount
				Rs.	Rs. P.
	100 mm high x 12 mm thick polished steam beech wood skirting with NC lacquer finish.				
	Quoted rates shall include all necessary materials, accessories and labour and also allow provisions for electrical/Telephone/computer wiring conduits and swithc boxes, etc.(Materials for wiring conduits and switch boxes shall be separately paid for.)	Sqm.	2.70		
4	<u>FULL HT. CASH PARTITION (PARTLY GLAZED)</u>				
	Supplying and erecting full height Partly Glazed partitions (2450 mm. high) as per drawing and conforming to the following specifications.				
	<u>Basic frame work :</u>				
	Aluminium Square Hollow Section-SHS (49.5mmx49.5mmx2.6mm) at minimum 450 mm c/c both ways horizontal or vertical spacings as per site condtions. Vertical members shall be suitably extended upto anchored and cross- tied at ceiling level.				
	<u>Skin membrane :</u>				
	6mm. thk. Firewall solid Ply (IS 5509) on both side, as per drawing/ instructions.				
	<u>Finishing :</u>				
	1mm thk. mica laminate sheet of same or combinatin shades as per instructions.				
	<u>Edge moulds :</u>				
	All free top / end surfaces shall have C.P wood moulds finished with Powder coated Spray Paint after using NC Putting of approve shade and size (100 mm x 6 mm) .				
	<u>Glazing :</u>				
	8mm. thk clear toughened glass fixed with glass D'clamp / glass hinghes.				
	Quoted rates shall include all necessary materials, accessories and labour and also allow provisions for electrical/ telephone / computer wiring conduits and switch boxes, etc.(Materials for wiring conduits and switch boxes shall be separately paid for.)	Sqm	40.46		

B.O.Q AND ESTIMATE FOR CIVIL, FURNISHING, FURNITURE FIXTURE, ELECTRICAL AND COMPUTER WORK FOR SHYAMNAGAR BRANCH UNDER GREATER KOLKATA OF BANK OF BARODA.

Sl.No.	Description Of Works	Unit	Qty	Rate	Amount
				Rs.	Rs. P.
5	<u>CASH WORKSTATION</u>				
	Providing and erecting in position Cash Work Station comprising of clerical workstation of approx.size 1200 x 800 x 750 mm inclusive of a 1100 mm high,				
	300 mm wide customer writing top finished with mirror polished 18 mm thick granite slab, of approved shade including moulding piece , fixed with chemical adhesive and a side - top made 19 mm thick BWR grade block board finished with 1 mm thick approved laminate including 6 mm thick polished steam beech wood lipping to free edges.The workstations shall be supported from the partition system and made of 19 mm thick BWR garde block board finished with 1.00 mm thick laminate sheet including inner faces. Free edges shall have steam beech wood mouldings of half-round profile as per drawings and instructions. The drawers and corresponding area of modesty panel (front facia) are to be cladded with 14 SWG M.S sheet, painted with two coats of synthetic enamel paint of approved shade and brand over a coat of approved steel primer.				
	Each cash work station shall comprise of the following :				
	Drawer unit having readymade stationery drawer of engineering plastic ; Tea tray at top ;				
	Cash drawers with approved telescopic channels for drawer - slides , automatic locks (keys in duplicate) and other necceary hardware and accssories including satin finish S.S handles of approved quality ;				
	Readimade CPU holder with swivel facility				
	The front of the cash counters shall have 12 mm thick clear Toughned glass in two pieces at sides with polished steam beech wood glazing beads as per instructions and drawings.	Rmt.	2.7		
6	<u>DOOR</u>				

B.O.Q AND ESTIMATE FOR CIVIL,FURNISHING,FURNITURE FIXTURE, ELECTRICAL AND COMPUTER WORK FOR SHYAMNAGAR BRANCH UNDER GREATER KOLKATA OF BANK OF BARODA.

Sl.No.	Description Of Works	Unit	Qty	Rate	Amount
				Rs.	Rs. P.
	Supplying and fixing in position 38 mm thk. solid core hot pressed phenol formaldehyde bonded flush door shutter of approved make finished with 1 mm thk. laminate sheet of approved quality on both sides of the door shutter . The upper portion after 300 mm of the shutter one 6mm thk. clear float glass Vision Panel (1500mm X 150mm)fixed with polished steam beech wood glazing beads, complete as per drawing. Rate to include cost of hardware fittings e.g. mortice lock, hinges,door closer, door stoper etc. of approved make and quality. The exposed timber surface to be polished in natural colour and finishing the same with melamine lacquer in mat satin finish.	Sqm.	19.95		
7	<u>FIXED GLASS PARTITION</u>				
	Providing and fixing Fixed Glass partition with 12 mm thk clear float TOUGHENED glass with approved patch fittings all as directed & to the entire satisfaction of our Architects.				
	All the fittings shall be of eqv. make fixed to the top wooden / R.C.C member and bottom floor grove with necessary screws / holdfast for fixed glass partition with all kinds of patch fittings with proper sylicon sealants in all edges of fixed glass to avoid leakage of A.C . The glass edges shall be machine polished & having 'zero' detail junction etc. complete (crystal polish) in all respect as per drawing and direction by the Architects	Sqm.	4.08		
8	<u>GLASS DOOR</u>				
	Providing & fixing single snutter Glass door of size as per drawing fabricated with 12mm thk TOUGHENED glass with approved patch fittings as shown in the detailed drawing & floor springs. It shall have approved stainless steel door handles on both sides and suitable locking arrangement etc. all as directed & to the entire satisfaction of our Architects-				

B.O.Q AND ESTIMATE FOR CIVIL,FURNISHING,FURNITURE FIXTURE, ELECTRICAL AND COMPUTER WORK FOR SHYAMNAGAR BRANCH UNDER GREATER KOLKATA OF BANK OF BARODA.

Sl.No.	Description Of Works	Unit	Qty	Rate	Amount
				Rs.	Rs. P.
	All the fittings- H shape (25mm dia -600mm long)	Sqm	3.99		
9	<u>DOOR FRAME</u>				
	Providing and Fixing in place Door frames fabricated out of Seasoned sal wood sections of 62.5x100 mm finished in one coat of primer & 3 coats of enamel paint of approved shade and color as per the instructions of the engineer. All door frames in the partitions / Wall shall also be embedded in the floor for 1 1/2" for bearing. Cost of door frames shall be inclusive of hold fasts / anchors for fixing in walls, making all necessary rabites etc. as per design/details.				
9.1	Frame Size: 1200 x 2100 mm	Rmt.	10.8		
9.2	Frame Size: 1000 x 2100 mm	Rmt.	10.4		
9.3	Frame Size: 900 x 2100 mm	Rmt.	20.4		
9.4	Frame Size: 750 x 2100 mm	Rmt.	9.9		
10	<u>WOODEN ROLLING SHUTTER BOX</u>				
	Providing and fixing 19mm thk Firewall solid Ply (IS 5509) openable wooden panelling in front of the rolling shutter hood inclusive of providing and fixing 50mm X 50mm hardwood framing, hinges to open the same for maintenance,finish with 1mm laminate in all exposed surface etc. complete.	Sqm.	6.72		
11	<u>ELECTRICAL PANEL BOX</u>				

B.O.Q AND ESTIMATE FOR CIVIL,FURNISHING,FURNITURE FIXTURE, ELECTRICAL AND COMPUTER WORK FOR SHYAMNAGAR BRANCH UNDER GREATER KOLKATA OF BANK OF BARODA.

Sl.No.	Description Of Works	Unit	Qty	Rate	Amount
				Rs.	Rs. P.
	Supply & fixing in position wooden box for electrical panel in 19mm thk. Firewall solid Ply (IS 5509) finished with 1mm thk. mica laminate on top of shutter, all inner surfaces will be finished with rough steam beach polished as per design. All edges shall have CP teak wood liping,conceal type auto-closing shutter hinges,godrej lock,decorative steel matt handle all complete as per design and drawing by the Architects.				
	DO BUT SIZE D- 600 X W- 1500 X H- 2400	Each	1		
12	<u>NOTICE BOARD</u>				
	Providing and fixing Fabric Wrapped Soft Board Panels for notice board of size and profile with free glass door as per detail.The Rate should be include approved fabric, accoustical infill with necessary 150mm wide, 12MM thk. Firewall solid Ply (IS 5509) reinforcement ,note the Fabric shall be stretched uniformly along the direction of weave and shall be wrinkle free etc. all as direction and to the entire satisfaction of our Architects.(1200mm x 900mm)	Sqm.	1.08		
13	<u>VERTICAL BLIND</u>				
	Providing and fixing vertical drape / blind in windows with 100 mm wide fabric,assembled on top aluminium channel 35 x 28 mm with high quality Clycon fittings with end covers, runners and stainless steel master runners, with nylon chord, fabric hanger and bottom link chain complete including operation guarantee all complete.	Sqm			-
14	<u>WOOD SKIRTING</u>				
	Providing and fixing in position 12 mm thick and 100 mm high steam beech wood skirting , duly polished in approved shade and finished with N.C lacquer in mat satin finish.(Only to the exposed areas)	Rmt.	60		
15	<u>PLANTER BOX</u>				

B.O.Q AND ESTIMATE FOR CIVIL,FURNISHING,FURNITURE FIXTURE, ELECTRICAL AND COMPUTER WORK FOR SHYAMNAGAR BRANCH UNDER GREATER KOLKATA OF BANK OF BARODA.

Sl.No.	Description Of Works	Unit	Qty	Rate	Amount
				Rs.	Rs. P.
	Supplying and placing in position decorative fibre glass planter of approx. 350mm dia.including artificial plants to the planter box.	Nos.	10		
16	<u>COLUMN CLADDING</u>				
	Supply & Fixing column cladding as per design, consisting of 12 mm thk. Firewall solid Ply (IS 5509) fixed on column with consist of Aluminium Rectangular Hollow Section-SHS (50mmx25mmx2.6mm) at minimum 450 mm c/c both ways horizontal or vertical spacings as per site condntions. (As per IS Code:4923:1997) finished with 1 mm thk.design laminate all complete as per design and specification by our Architects , finished with 1 mm thk. Laminate all complete as per design and specification by our Architects .	Sqm.	14.39		
22	<u>WALL PANELLING</u>				
	Supply & Fixing wall paneling as per design, consisting of 6 mm thk. + 6mm thk. Firewall solid Ply (IS 5509) fixed on wall frame consist of Aluminium Rectangular Hollow Section-SHS (50mmx25mmx2.6mm) at minimum 450 mm c/c both ways horizontal or vertical spacings as per site condntions. (As per IS Code:4923:1997) finished with 1 mm thk.3 Piramid design laminate all complete as per design and specification by our Architects	Sqm.	30.55		
23	<u>GLASS SHELVES</u>				
	Providing & fixing 8mm thk. Machine polished glass shelves (Size : 3'-6" x 1'-0") with S.S finished "D" bracket.	No.	2		
PART- B' TOTAL CARRIED TO GENERAL SUMMARY					-
PART-C FURNITURE & FIXTURE					
1	<u>BRANCH MANAGER's TABLE</u>				

B.O.Q AND ESTIMATE FOR CIVIL,FURNISHING,FURNITURE FIXTURE, ELECTRICAL AND COMPUTER WORK FOR SHYAMNAGAR BRANCH UNDER GREATER KOLKATA OF BANK OF BARODA.

Sl.No.	Description Of Works	Unit	Qty	Rate	Amount
				Rs.	Rs. P.
	Supply & fixing in position free-standing office table 1800mm X 900mm X 750mm high with 150mm stationery drawer for Branch Manager's cabin, in 19mm thk. Firewall solid Ply (IS 5509) and 12/6 thk Firewall solid Ply (IS 5509) with 1mm thk.mica laminate on top,side, both side of modesty panel (19mm) and all exposed surfaces. Inside of drawer will be finished with natural colour hi gloss polish, all edges shall have CP teak wood lipping. Table will have one credenza unit (W-500 x D-600 x H-700mm)consist of one tea tray, one readymade stationery drawer of engineering plastic & three nos heavy duty tele-scopic drawer slides, concealed type auto - closing shutter hinges ,godrej central lock,decorative s.s handle/Knob, 10mm clear glass on top, quoted rates shall also include cost of polished steam beech wood moulding (finished 50x20 mm section) to edges of table top ; polished steam beech wood lipping (6mm thick) to free edges of block board /plywood surfaces all complete as per design and drawing by our Architects.	Each	1		-
2	<u>OFFICER's TABLE</u>				
	Supply & fixing in position free-standing Office table 1350/1225mm X 750mm X 750mm high for Mgr./Officers with 510mm wide keyboard drawer in 19mm BWR block board(IS:1659) and				

B.O.Q AND ESTIMATE FOR CIVIL,FURNISHING,FURNITURE FIXTURE, ELECTRICAL AND COMPUTER WORK FOR SHYAMNAGAR BRANCH UNDER GREATER KOLKATA OF BANK OF BARODA.

Sl.No.	Description Of Works	Unit	Qty	Rate	Amount
				Rs.	Rs. P.
	12/6mm thk. Firewall solid Ply (IS 5509) with 1mm thk.mica laminate on top,side, both side of modesty panel and all exposed surfaces, inside of drawer will be finished with natural colour hi gloss polish, all edges shall have CP teak wood lipping as per design. Table will have one credenza unit (w-450 x D-500 x H-700) consist of one tea tray, one readymade stationery drawer of engineering plastic & three nos heavy duty tele-scopic drawer slides,concealed type auto-closing shutter hinges, godrej central lock,decorative s.s handle/ knob,10mm clear glass on top, quoted rates shall also include cost of polished steam beech wood moulding (finished 40x20mm section) to edge of table top:polished steam beech wood lipping (6mm thk) to free edges of block board/plywood surfaces all complete as per design and drawing by our Architects.	Each	4		-
3	<u>BACK CABINET(750mm)</u>				
	Providing and erecting in position side / back cabinet units with sliding shutters of approx. size of 400 mm deep x 700 mm high made of 19mm thick Firewall solid Ply (IS 5509) including intermediate shelves as per drawing /instructions. Exposed block board surfaces shall be finished with 1.00 mm thk.laminate sheet of approved shade and make. Inner faces of shutters shall be polished in approved colour. Free edges of block board shall have polished steam beech wood half round moulds (out of 20 x 20 mm sections) . Inner faces of cabinet units shall be polished in approved shade Quoted rates shall include cost of necessary hardware, viz. handles/ Knob, locks with keys in duplicate , etc.				
3.1	DO BUT SIZE D-450 X L-2500 X H-750 -Manager	Each	1		-
4	<u>COMPUTER TABLE</u>				

B.O.Q AND ESTIMATE FOR CIVIL,FURNISHING,FURNITURE FIXTURE, ELECTRICAL AND COMPUTER WORK FOR SHYAMNAGAR BRANCH UNDER GREATER KOLKATA OF BANK OF BARODA.

Sl.No.	Description Of Works	Unit	Qty	Rate	Amount
				Rs.	Rs. P.
	Supply, fixing and keeping in position Computer table consisting of 19mm thk. Firewall solid Ply (IS 5509) on top and both the side, 6mm thk.BWR Plywood(IS:303) in back with small drawer in both the side etc. All the exposed surface of the table shall be finished with 1mm thk. mica laminate of approved shade with liping all complete as per design and drawing by our Architects.				
4.1	DO BUT SIZE D-450 X L-1000 X H-750 -Manager	Each	1		-
5	<u>SIDE UNIT (750 mm)</u>				
	Supply, fixing and keeping in position Side Unit consisting of 19mm thk. Firewall solid Ply (IS 5509) with one drawer and one wardrobe, 6mm thk.BWR Plywood(IS:303) in back with godrej lock. mat s.s decorative handle, magnetic lock,concealed type auto-closing shutter				
	hinges etc. The all exposed surface of side unit, both side of shutter shall be finished with 1mm thk. mica laminate of approved shade. All inner surfaces shall have natural colour hi gloss polish with liping all complete as per design and drawing by our Architects.				
5.1	DO BUT SIZE D-400 X L-700 X H-750	Each	1		-
6	<u>LOW HT. STORAGE (900mm)</u>				
	Supply & fixing in position half height Storage unit(900mm)with intermediate shelves in every 450mm with19mm thk. Firewall solid Ply (IS 5509) finished with 1mm thk. mica laminate on both side of shutter BWR Plywood(IS:303) only as per design. All edges shall have CP teak wood liping,conceal type auto-closing shutter hinges,lock,decorative S.S handle all complete as per design and drawing by our Architects.				
6.1	DO BUT SIZE D-550 X L-2000 X H-900	Each	1		
6.2	DO BUT SIZE D-550 X L-1800 X H-900	Each	1		
7	<u>SUGGESTION BOX</u>				

B.O.Q AND ESTIMATE FOR CIVIL,FURNISHING,FURNITURE FIXTURE, ELECTRICAL AND COMPUTER WORK FOR SHYAMNAGAR BRANCH UNDER GREATER KOLKATA OF BANK OF BARODA.

Sl.No.	Description Of Works	Unit	Qty	Rate	Amount
				Rs.	Rs. P.
	Supplying and erecting free-standing suggestions box of overall size 450 mm long x 300 mm deep x 900 mm high made of 19 mm thick Firewall solid Ply (IS 5509) , as in drawing, complete with hardware fittings and fixtures of approved make and quality.				
	Top and all exposed surfaces of Ply are to be finished with 1.00 mm thick laminate sheet of approved shade and quality. Inner faces of Ply surfaces are to be finished with minimum two coats of synthetic enamel paint of approved shade and quality over a coat of approved primer.	No	1		
8	<u>CHEQUE DROP BOX</u>				
	Supplying and erecting cheque drop box (overall size 450 mm x 300 mm x 750 mm) made of 19mm thick BWR Plyboard(IS:303) and the curved portion at top made out of 90 mm x 90 mm C.P teak wood section. A slit opening of 10 mm x 150 mm is to be provided at the top of the box. An openable shutter of 259 mm x 262 mm size made of 19 mm thick Firewall solid Ply (IS 5509) is to be provided at 1 mm above finished floor level.				
	All the exposed timber surfaces including all free edges are to be finished with 1 mm thick laminate sheet of combination shade .Inner faces of block board surfaces are to be finished with minimum two coats of synthetic enamel paint of approved shade and quality over a coat of approved primer.Rate to include cost of necessary hardware fittings e.g. brass hinges, lock, knob etc. of approved designand quality.	No.	1		
9	<u>CUSTOMER'S WRITING TOP</u>				
	Supplying and erecting wall mounted Customers' writing top of approx. size 150mm deep supported on Pigeonhole racks as Slip Box approx. 150 x 150 mm each in size(1000mm x 150mm) in 19 mm thick Firewall solid Ply (IS 5509) and 8 mm thick clear float glass, all complete as directed.	No.	1		

B.O.Q AND ESTIMATE FOR CIVIL, FURNISHING, FURNITURE FIXTURE, ELECTRICAL AND COMPUTER WORK FOR SHYAMNAGAR BRANCH UNDER GREATER KOLKATA OF BANK OF BARODA.

Sl.No.	Description Of Works	Unit	Qty	Rate	Amount
				Rs.	Rs. P.
PART-'C' TOTAL CARRIED TO GENERAL SUMMARY					-
PART-D POWER DISTRIBUTION					
1.0	<u>PANELS, DBS, CABLING & WIRING WORK</u>				
1.1	<u>MAIN SWITCH</u>				
	Supply and fixing of following Switch Fuse Unit (SFU) with HRC fuse in sheet steel enclosure on M. S. Angle frame / M.S. Legs on wall complete with interconnection, mending good damages to original finish, painting, etc. as required.				
1.1.1	63A FP SFU with HRC fuse links as main incomer with cable entry box.	Each	1		
1.1.2	40A rated 4P on load CO switch to be connected after the TPN Busbar with cable entry box all both	Each	1		
1.1.3	32A TPN SFU with rewirable fuse links for Generator supply.	Each	1		
1.1.4	40A DP MCB isolator for controlling LDB at exit	Each	1		
1.1.5	25A DP MCB for UPS incomer & outgoing.	Each	1		
1.1.6	TPN Busbar chamber having 4 nos. 25X6mm CU Bars fixed on insulators	Each	1		
1.2	<u>DISTRIBUTION CABLE</u>				
1.2.1	<u>SUPPLYING & FIXING OF CABLE</u>				
	Supplying & Fixing of 1.1 KV grade PVC insulated and PVC sheathed armoured aluminium conductor cables of following sizes conforming of IS : 1554 (Part -1) :				
1.2.1.1	3.5 core 50 sq. mm cable for LDB / PDB	Mtr.	25		
1.2.1.2	4 core 10 sq. mm copper unarmour cable for UPS Power	Mtr.	15		

B.O.Q AND ESTIMATE FOR CIVIL,FURNISHING,FURNITURE FIXTURE, ELECTRICAL AND COMPUTER WORK FOR SHYAMNAGAR BRANCH UNDER GREATER KOLKATA OF BANK OF BARODA.

Sl.No.	Description Of Works	Unit	Qty	Rate	Amount
				Rs.	Rs. P.
1.2.1.3	4 x 10 sqm.copper wire from Busbar to UPS incomer MCB	Mtr.	7		
1.2.2	<u>LAYING OF CABLE</u>				
	Laying of above cable on wall / column / above false ceiling including supply and fixing of M.S. clamps/ galvanised bar saddles @ 300 mm apart, making holes and mending good damages.				
1.2.2.1	3.5 core 50 sq. mm cable for LDB / PDB	Mtr.	25		
1.2.2.2	4 core 10 sq. mm cable for UPS power	Mtr.	15		
1.2.2.3	4 x 10 sqm.copper wire from Busbar to UPS incomer MCB	Mtr.	7		
1.2.3	<u>CABLE GLAND AND FINISHING THE END</u>				
	Supplying and fixing of compression type brass cable gland alongwith rubber rings for dust and moisture proof entry of following 1.1 KV grade PVC insulated and PVC sheathed armoured aluminium conductor cable and finishing the end by crimping method including supply and fixing of " Dowel" make soloderless socket, tapes and jointing materials as required to be completed in all respect.				
1.2.3.1	3.5 core 50 sq. mm. Aluminium cable	Set	6		
1.2.3.2	4 core 10 sq. mm cable for UPS power	Set	4		
1.2.3.3	4 core 6 sq. mm copper unarmer cable for AC Unit	Set	4		
1.2.3.4	4 x 10 sqm.copper wire from Busbare to UPS incomer MCB	Set	4		
1.3	<u>SUBMAIN WIRING</u>				

B.O.Q AND ESTIMATE FOR CIVIL,FURNISHING,FURNITURE FIXTURE, ELECTRICAL AND COMPUTER WORK FOR SHYAMNAGAR BRANCH UNDER GREATER KOLKATA OF BANK OF BARODA.

Sl.No.	Description Of Works	Unit	Qty	Rate	Amount
				Rs.	Rs. P.
	Submain wiring with following sizes 1100 V grade, single core, PVC insulated flexible FRLS copper conductor cable (IS:694) through suitable size M.S. conduit (ISI marked embossed on conduit surface) complete with junction box, circular box, elbows, bends and other accessories on surface below true ceiling or concealed by chase cutting on wall, as per site condition, mending good all damages to original finish, interconnection, etc. as required to be completed in all respect. All connections of wires to be done by means of "Wago" type connectors:				
1.3.1	With 4 Nos 6Sq.mm + 2No 4 Sq.mm (green colour for earth) PVC insulated FRLS copper wire	Mtr.	265		
1.3.2	With 2 Nos. 6 Sq.mm. + 1 No. 4 Sq.mm. (green colour for earth) PVC insulated FRLS copper wire.	Mtr.	280		
1.4	<u>LIGHT DISTRIBUTION BOARD LDB / PDB (Raw Power)</u>				
	Supply and installation of metallic double door MCB Distribution Board with MCB having breaking capacity of 16 KA (minimum) or RCBO of 300 MA sensitivity complete with busbar, interconnection, painting, mounted on flat iron frame on wall / flushed with finished wall by chase cutting , mending good to original finish painting etc. as required. Name plae & nimber of Dbs are to be fixed up on front door of DBs for their indentification. RCBOs should have over load short circuit & Earth leakage protection.				
1.4.1	SPN 8 way consumer unit MCB DB complete with busbar and the following RCBO / MCBs				
	<u>INCOMING :</u>				
	1 No. 240 V 32 A DP RCBO (300 MA sensitivity)				
	<u>OUTGOING :</u>				
	8 Nos. 240 V 10 A SP MCB	Set	1		
1.4.2	4 way TPN DB				
	<u>INCOMING :</u>				
	1 No. 440 V 40 A 4Pole RCCB (300 MA sensitivity)				

B.O.Q AND ESTIMATE FOR CIVIL,FURNISHING,FURNITURE FIXTURE, ELECTRICAL AND COMPUTER WORK FOR SHYAMNAGAR BRANCH UNDER GREATER KOLKATA OF BANK OF BARODA.

Sl.No.	Description Of Works	Unit	Qty	Rate	Amount
				Rs.	Rs. P.
	<u>OUTGOING :</u>				
	1 No 440 V 32 A TPN MCB for front signage lighting	Set	1		
1.5	<u>TPN DISTRIBUTION BOARD FOR A.C</u>				
	Supply and installation of metallic single door Distribution Board with MCB having breaking capacity of 16 KA (minimum) or RCBO of 300 MA sensitivity complete with busbar, interconnection, painting, mounted on flat iron frame on wall / flushed with finished wall by chase cutting , mending good to original finish painting etc. as required. Name plate & number of Dbs are to be fixed up on front door of DBs for their identification. RCBOs should have over load short circuit & Earth leakage protection.				
1.5.1	TPN 6 way MCB DB complete with busbar and the following RCBO / MCBs				
	<u>INCOMING :</u>				
	1 No. 440 V 63A TPN RCBO (300 MA sensitivity)				
	<u>OUTGOING :</u>				
	7 Nos. 240 V 32A SP MCB				
	Blank Plate-11nos.	Set	1		
1.6	<u>6/16A SOCKET OUTLET POINT WIRING</u>				
	Wiring for 6 pin 6/16 A shuttered socket outlet with controlling switch from DB with 1100 volt grade 2 Nos. single core 2.5 sq. mm. + 1 No. 2.5 sq. mm (Green colour for earthing) PVC insulated flexible FRLS COPPER CONDUCTOR CABLE (IS ; 694) through suitable size M. S. conduit (ISI marked embossed on conduit surface) complete with junction box, circular box, elbows, bends, couplers and other accessories on surface above false ceiling or concealed by chase cutting on wall.				

B.O.Q AND ESTIMATE FOR CIVIL, FURNISHING, FURNITURE FIXTURE, ELECTRICAL AND COMPUTER WORK FOR SHYAMNAGAR BRANCH UNDER GREATER KOLKATA OF BANK OF BARODA.

Sl.No.	Description Of Works	Unit	Qty	Rate	Amount
				Rs.	Rs. P.
	The work includes supply & fixing of 6/16A 6 pin shuttered socket outlet with controlling switch, indicator, suitable size mounting box and front plate for socket outlet flushed with finished wall, mending good all damages to original finish, interconnection, painting etc. as required to be completed in all respect all connections of wires to be done by means of 'Wago' type connectors.	Each	15		
1.7	<u>32A INDUSTRIAL SOCKET & PLUG CONCEAL TYPE POINT WIRING FOR GENERATOR</u>				
	Supply and installation of 32A Industrial socket & plug top on M.S. box for Generator connection all complete.	Each	1		
1.8	<u>POWER POINT WIRING FOR HI WALL A.C</u>				
	S.F & L of 3 x 4.0 sqm. Standard FRLS copper conductor in 20mm dia ISI marked conduit pipe partly laid over false ceiling and partly concealed in wall / floor including making all good damages.	Mtr.	285		
1.9	<u>POINT WIRING</u>				
	Point wiring with 1100 V grade 3 nos. single core 1.5 sq. mm. (1 for phase, 1 (black colour) for common neutral by looping method and 1 (green colour) for common earth by looping method) PVC insulated flexible FRLS copper conductor cable (IS : 694) through suitable size M. S. conduit (ISI marked embossed on conduit surface) complete with junction box, circular box, elbows, bends, couplers and other accessories on surface above false ceiling or concealed by chase cutting on wall from light & fan switch board to light, fan & ^A socket outlet on the same switch board or separately mounted switch board.				

B.O.Q AND ESTIMATE FOR CIVIL,FURNISHING,FURNITURE FIXTURE, ELECTRICAL AND COMPUTER WORK FOR SHYAMNAGAR BRANCH UNDER GREATER KOLKATA OF BANK OF BARODA.

Sl.No.	Description Of Works	Unit	Qty	Rate	Amount
				Rs.	Rs. P.
	The work includes supply and fixing of all materials as specified in tender, se 6A switch for each light and fan point. 6A 2/3 pin shuttered socket outlet with switch. 3 plate ceiling rose/ angle or batten holder etc. as required. The point wiring also includes circuit wiring with 1100 V grade 2 nos. single core 2.5 sq. mm. (1 for phase and 1 (Black colour) for netural) + 1 no. single core 1.5 Sq. mm (Green colour for earth) PVC insulated flexible (FRLS) copper conductor cable (IS:694) through suitable size M. S. conduit as described above from Db to switch board, interconnection, mending good all damages to original finish painting etc. as required to be completed in all respect.				
	All connections of wires to be done by means of " Wago" type connectors. (All wiring in storng room, locker room, records & stores will be of surface conduit type.)				
1.9.1	Light Points (one point)	Each	8		
1.9.2	Light Points (two points)	Each	14		
1.9.3	Exhaust Fan Point (cutting,framing and fixing all complete)	Each	2		
1.9.4	Wall bracket/cabin fan point with supply and fixing of 6Amp socket near the fan and controlling switch at light switch board.	Each	12		
1.9.5	Call bell point with buzzer	Each	1		
1.10	<u>HI-WALL A.C POINT WIRING</u>				
	Point Wiring from AC DB to socket outlet using 3x4sqmm 1100v,standard copper conductor PVC insulated wires in MS conduit above false ceiling complete with accessories, junction boxes etc.				
	The cost of point wiring should include length of circuit wiring also.No addition rates will be given for circuit wiring.				

B.O.Q AND ESTIMATE FOR CIVIL,FURNISHING,FURNITURE FIXTURE, ELECTRICAL AND COMPUTER WORK FOR SHYAMNAGAR BRANCH UNDER GREATER KOLKATA OF BANK OF BARODA.

Sl.No.	Description Of Works	Unit	Qty	Rate	Amount
				Rs.	Rs. P.
	6M Power Unit Flush Type modular MCB , socket outlet and starter for hi wall Split type air-conditioner.	Nos	7		
1.11	<u>EARTHING (GENERAL)</u>				
	Earthing the installation as per I.E rules conforming to IS : 3043 or its latest ammendment by making earth station with 600 mm x 600 mm (minimum) thick G.I. plate electrode to be installed such that its top edge shall be at a minimum depth of 3.0 metre below ground level after preparation of ground with charcoal and salt and connecting the MIP with 25 mm x 6 mm G. I. earth lead-in-strip directly in ground by bolting and then brazing to the G. I. plate complete with G.I. bolts of suitable length double nuts and washers including supply and fixing of 50mm dia. partly perforated G.I. pipe with funnel for watering arrangement .				
	The earthing installation should be provided with 300 mm x 300 m and 300 mm depth inside dimension masonry inspection pit with C.I. hinged cover having locking arrangement, test link of size 150 mm length x 25 mm x 6 mm G.I. flat connected to G.I. Earth lead-in-strip and restoring the surfaces duly rammed.	Each	2		
PART-`D' TOTAL CARRIED TO GENERAL SUMMARY					-
PART-E <u>SUPPLY AND INSTALLATION OF LIGHT FITTINGS & FAN</u>					
1	Lighting Fixtures & Fans:				
	Supply and Installation of the following lighting fixtures complete with lamps, tubes, fixing arrangements, ball and sockets, suspension conduits/ chains, cutting of false ceiling etc. as per specifications and site conditions all complete.				
1.1	Recessed 2x2/Pendant mounted 33W 240V with IP20 protection LED Luminiare with(for Modular grid 24/15mm prelude pendent mounted installation with four nos. of Steel hook up wire(IS 10322 part S/sec I,1987 comply Hall area	Nos	23		

B.O.Q AND ESTIMATE FOR CIVIL,FURNISHING,FURNITURE FIXTURE, ELECTRICAL AND COMPUTER WORK FOR SHYAMNAGAR BRANCH UNDER GREATER KOLKATA OF BANK OF BARODA.

Sl.No.	Description Of Works	Unit	Qty	Rate	Amount
				Rs.	Rs. P.
1.2	20W LED 5700K Suspended architectural LED luminaire soft light and glare free symmetrical illumination also.	Nos	13		
1.3	1x11W LED (TC-S) indoor decorative luminaire with opal acrylic diffuser, end caps and coloured rims suitable for T8 and TC-S lamps-Toilet Mirror	Nos.	2		
1.4	18W LED 3000K Recess mounted pressure die-cast aluminium luminaire in powder coated white finish in round profile Entrance.	Nos	9		
1.5	1 x 12W recess round LED downlighter with reflector, white powder coated, pressure die cast aluminium housing complete with LEDs,integrated electronic control gear LED driver and accessories as per IS 10322 PART 5/SEC 1987 Toilet	Nos	2		
1.6	Task Light–Cash Area	Nos.	2		
	Supply & Installation of 300 mm dia Cabin Fan	Nos	2		
	Supply of 400 mm dia wall bracket fan	Nos	8		
	Installation of 300 mm dia suitable for 220/240 volts single phase, A.C. 500hz, exhaust fan with metal blade fixing with wooden frame, cutting of wall all complete.	Nos.	2		
	PART 'E' TOTAL CARRIED TO GENERAL SUMMARY				-
PART-F COMPUTER POWER WIRING					
1.0	INDUSTRIAL TYPE SOCKET DB FROM U.P.S				
	Supply,installation,testing and commissioning of following wall mounted,DB with socket & matching plug with controlling MCB in sheet steel enclosure (Company manufactured)				
1.1	63A 5pin industrial socket with matching plug & 63A TPN controlling MCB including connection	Set	2		

B.O.Q AND ESTIMATE FOR CIVIL,FURNISHING,FURNITURE FIXTURE, ELECTRICAL AND COMPUTER WORK FOR SHYAMNAGAR BRANCH UNDER GREATER KOLKATA OF BANK OF BARODA.

Sl.No.	Description Of Works	Unit	Qty	Rate	Amount
				Rs.	Rs. P.
1.2	Supply and laying 4 x 16 sqm Copper wire	Mtr.	15		
1.3	25 x 6mm copper bus bar chamber with sheet steel enclosure(size 600mm)	Set	1		
2.0	<u>COMPUTER DISTRIBUTION BOARD (CDB)</u>				
	Supply and installation of metallic double door MCB Distribution Board with MCB having breaking capacity of 16 KA (minimum) or RCBO of 300 MA sensitivity complete with busbar, interconnection, painting, mounted on flat iron frame on wall / flushed with finished wall by chase cutting , mending good to original finish painting etc. as required, name plate & number of Dbs are to be fixed up on front door of DBs for their identification. RCBO's should have over load short circuit & earth leakage protection.				
2.1	TPN 4 way consumer Unit MCB DB complete with busbar and the following RCBO/MCB's incoming.				
	<u>INCOMING</u>				
	1 No. 440 volt. 63 A TPN RCBO (300 MA Sencibility)				
	<u>OUTGOING</u>				
	4 Nos. 32A D.P.MCB	Each	1		
2.2	SPN 8 way consumer unit MCB DB complete with busbar and the following RCBO/MCBs				
	<u>INCOMING :</u>				
	1 No. 240 V 32 A DP RCBO (300 MA sensitivity)				
	<u>OUTGOING :</u>				
	8 Nos. 240 V 10 A SP MCB	Each	1		
2.3	Supply and laying of 2 x 10.0 sqm. + 1.4 sqmm. S/c copper wire from bus bar to UPS incomer MCB through MS conduit	Mtr.	12		
3.0	<u>COMUTER SOCKET OUTLET CLUSTER POINT WIRING</u>				

B.O.Q AND ESTIMATE FOR CIVIL,FURNISHING,FURNITURE FIXTURE, ELECTRICAL AND COMPUTER WORK FOR SHYAMNAGAR BRANCH UNDER GREATER KOLKATA OF BANK OF BARODA.

Sl.No.	Description Of Works	Unit	Qty	Rate	Amount
				Rs.	Rs. P.
	Computer socket outlet cluster point wiring with 1100 V grade 3 nos. single core (1 for earth, green colour) 2.5 sq.mm. PVC insulated flexible FRLS copper conductor cable conforming to IS : 694 through suitable size M. S. conduit (ISI mark embossed on conduit surface) and conduit accessories partly through concealed in eall, embedded in floor, partly on surface above false ceiling and partly through partition or through flexible conduit from DB to computer socket outlet cluster as detailed below and upto connection of 2 nos. socket clusters in 1 (one) circuit connecting by looping method. The work includes supply and fixing of socket outlet clusters components as detailed below.				
3.1	Each PC Power Unit comprising of the following items :				
	3 Nos. 6A/13A International Power socket				
	1No. 16A cotrolling switch				
	1 No. Front cover of suitable size				
	1 No. Metal mounting box of suitable size.	Set	8		
4.0	<u>EARTHING (COMPUTER)</u>				
4.1	Earthing the installation as per I. E. rules conforming to IS : 3043 - 1987 or its latest amendment by making earth station with 600 mm x 600 mm x 6mm (minimum) thick copper plate electrode to be installed such that its top edge shall be at a minimum depth of 3.0 metre below ground level after preparation of ground with charoal and salt and connecting the 25 mm x 6 mm copper earth lead- in -strip (upto 10 metre length) by bolting and then brazing to the copper plate complete with copper bolts of suitable length double nuts and washers including supply and fixing of 50 mm dia. partly perforated G.I. pipe with funnel for watering arrangement.				

B.O.Q AND ESTIMATE FOR CIVIL,FURNISHING,FURNITURE FIXTURE, ELECTRICAL AND COMPUTER WORK FOR SHYAMNAGAR BRANCH UNDER GREATER KOLKATA OF BANK OF BARODA.

Sl.No.	Description Of Works	Unit	Qty	Rate	Amount
				Rs.	Rs. P.
	The copper earth lead-in-strip shall be PVC sleeved/ insulated throughout the total length and the underground portion to be laid through suitable size heavy duty rigid PVC conduit (ISI mark embossed on conduit surface) at an average depth of 500 mm below ground level. The earthing installation should be provided with 300mm x 300 mm and 300 m depth inside dimension masonry inspection pit with C. I. hinged cover having locking arrangement, test link of size 150 mm length x 25 mm x 6 mm copper flat connected to copper earth lead- in - strip and reastoring the surfaces duly rammed.	Each	2		
4.2	Extra for earth lead -in - strip exceeding 10 metre length as mentioned in item no. 3.5.1. With supply and fixing of 25m x 6mm copper strip having PVC sleeved/ insulated to be fixed on wall surface with tinned copper bar saddles/ clamps at an interval of 300 mm etc. as required to be completed in all respect. Minimum clearance between wall surface and copper earth lead- in - strip should be 6 mm.	Mtr	18		
PART- ' F' TOTAL CARRIED TO GENERAL SUMMARY					-
PART-G	<u>COMPUTER DATA AND TELEPHONE SYSTEM</u>				
1	<u>SUPPLYING AND LAYING OF PVC CONDUIT</u>				
1.1	Supplying and laying of 25/20 mm dia PVC (ISI marked) complete with junction box, circular box, elbows, bends, couplers and other accessories as required by chase cutting on wall through partition or over false ceiling, The work includes making good all damages to original finish, painting etc. as required.	Mtrs.	390		
2	<u>TELEPHONE SOCKET</u>				

B.O.Q AND ESTIMATE FOR CIVIL,FURNISHING,FURNITURE FIXTURE, ELECTRICAL AND COMPUTER WORK FOR SHYAMNAGAR BRANCH UNDER GREATER KOLKATA OF BANK OF BARODA.

Sl.No.	Description Of Works	Unit	Qty	Rate	Amount
				Rs.	Rs. P.
2.1	Supply and fixing on furniture / partition recessed type telephone socket outlet (twin RJ 11) with mounting box & front plate as shown in the drawing complete with chase cutting, mending good damage etc. as required .	Each	2		
3	<u>TELEPHONE JUNCTION BOX</u>				
3.1	Supply and fixing of 25 pair telephone junction box " Krone" make on wall with hinged cover and screwed type tag strips complete with chase cutting, mending good all damages etc.all complete as required.	Each	1		
4	<u>TELEPHONE WIRING</u>				
4.1	Supplying and laying of 2 - pair 0.61 mm dia. PVC insulated telephone cables through pre- laid rigid PVC conduit as shown in the drawing or otherwise as directed by the consultant from Telephone Junction Box to telephone socket outlet including interconnection mending good all damages etc. as required to be completed in all respect.	Mtrs.	50		
4.2	Supplying & laying of 25 pair 0.61 mm dia Armoured Telephone cable in underground or on wall surface as per site requirement.	Mtrs.	10		
5	<u>COMPUTER DATA WIRING</u>				
5.1	Supplying and laying of CAT – 6 e cables through pre-laid rigid PVC conduit as shown in the drawing or otherwise as directed by the consultant from server to HUB, HUB to Computer Data Socket including interconnection mending good etc. as required to be completed in all respect.	Mtrs.	210		
6	<u>COMPUTER DATA SOCKET</u>				
6.1	Supply and fixing on wall/furniture/partition recessed type make Computer data socket (RJ 45) with suitable mounting box & front plate as shown in the drawing complete with chase cutting, mending good etc. as required.	Each	8		

B.O.Q AND ESTIMATE FOR CIVIL,FURNISHING,FURNITURE FIXTURE, ELECTRICAL AND COMPUTER WORK FOR SHYAMNAGAR BRANCH UNDER GREATER KOLKATA OF BANK OF BARODA.

Sl.No.	Description Of Works	Unit	Qty	Rate	Amount
				Rs.	Rs. P.
7	<u>T.V. WIRING</u>				
7.1	Supply and erection of T.V. socket in MS Box	No.	1		
7.2	Supply and installation of T.V cable in 25mm dia PVC Conduit	Mtr.	12		
7.3	Supply and installation of T.V. Spliter	No.	1		
PART-`G' TOTAL CARRIED TO GENERAL SUMMARY					-
PART-H STRUCTURAL LAN CABLING WORK					
1	24 Port Jack Panel Make:-D-Link	No.	1		
2	Mounting cord 7' 0"make D-Link	No.	8		
3	Mounting cord 3' 0"make D-Link	No.	8		
4	Labeling of each IO point patch panel end to end	No.	8		
PART-`H' TOTAL CARRIED TO GENERAL SUMMARY					-
<u>TOTAL GENERAL SUMMARY OF COMBINED INTERIOR WORK</u>					
PART - 'A' : CIVIL AND ALLIED WORKS				-	
PART- 'B' : FURNISHING WORK				-	
PART- 'C' : FURNITURE AND FIXTURE WORK				-	
PART -' D' : POWER DISTRIBUTION				-	
PART - 'E' : SUPPLY AND INSTALLATION OF LIGHT FITTINGS AND FAN				-	
PART - 'F' : COMPUTER POWER WIRING				-	

B.O.Q AND ESTIMATE FOR CIVIL,FURNISHING,FURNITURE FIXTURE, ELECTRICAL AND COMPUTER WORK FOR SHYAMNAGAR BRANCH UNDER GREATER KOLKATA OF BANK OF BARODA.

Sl.No.	Description Of Works	Unit	Qty	Rate	Amount
				Rs.	Rs. P.
	PART- 'G' : TELEPHONE AND COMPUTER SYSTEM WORK			-	
	PART- 'H' : STRUCTURAL LAN CABLING WORK			-	
	GROSS VALUE			-	
	Add CGST				
	Add SGST				
	(If quote GSTIN then mention GSTIN No. must)				
	GSTIN No.				
	NET VALUE				
	Total Rupees in Word:				
Place:				Signature Authorised Signatory with Seal	
Date:					