

**TENDER**  
**Bank of Baroda, Asset Recovery Management Branch (ARMB), Jabalpur**  
**Interior Furnishing, Electrical , and Air Conditioning Works**

**TENDER DOCUMENT**  
**(Terms, Conditions & Drawings)**

**PROPOSED**  
**Interior Furnishing, Electrical , and Air Conditioning Works**  
**for**  
**BANK OF BARODA**  
**at**  
**Asset Recovery Management Branch (ARMB) Jabalpur**  
**Block No-10, 2<sup>nd</sup> Floor, JDA Building, Civic Centre, Marhatal, Jabalpur (M.P.) 482002**

**ASHISH SHRIVASTAVA**  
(Chartered Architect & Interior Designer))  
**KUSHI AND ASSOCIATES**  
Architects, Interior Designers, Government Approved.Valuers  
11, Swastik complex, Russel crossing,Jabalpur-482 001  
Email – [kushiarchitect101222@gmail.com](mailto:kushiarchitect101222@gmail.com)

**Name of Bidder :-**

**Signature and seal of Bidder :-**

**Date:**

---

**Seal and signature of Contractor**

**Page 1 of 50**

## TENDER

### Bank of Baroda, Asset Recovery Management Branch (ARMB), Jabalpur Interior Furnishing, Electrical , and Air Conditioning Works

#### BANK OF BARODA- REGIONAL OFFICE, JABALPUR

Sealed tenders on item rate basis are invited in enclosed form from competent Contractor having good technical & financial capacity for the work of Interior Furnishing, Electrical and Air Conditioning Works 's in Branch premises for Bank Of Baroda at Asset Recovery Management Branch (ARMB) Jabalpur Block No-10, 2nd Floor, JDA Building, Civic Centre, Marhatal, Jabalpur (M.P.) 482002

**Value of Furnishing work is Rs 26,56,691/-  
(Twenty Six Lakh Fifty Six lakh Six Hundred Ninty One only)**

**COMPULSORY NOTE :- Successful lowest Bidder with very Low Quoted Final Tendered Amount (If difference is more than 10 % of estimated value of work) will have to Submit a PERFORMANCE GUARANTEE (as decided by the Bank) with the Bank in the form of FD/DD/BG in Banks favor. The deposited Amount in the form of DD/BG with the Bank shall be released to the selected lowest Bidder after successful completion of furnishing work , if completed satisfactorily .**

- |  |   |  |
|--|---|--|
| 01. Issue of tender documents  | : | 01.02.2025   |
| 02. Last date of receipt of tender document                              | : | 21.02.2025 up to 15.00 Hrs.  |
| 03. Opening of Technical bids  | : | 21.02.2025 at 15:30 Hrs .  |
| 04. Opening of Financial bids  | : | Only Eligible Tenderer shall be informed<br>(Via E- Mail/Telephone) separately   |
| 05. Place of submission of bids  | : | The Regional Head, Bank of Baroda, Regional Office-<br>Regional Office (Jabalpur Region): Plot No- 1170,<br>First Floor, Shiv Moola Tower, Main Road, Wright<br>Town, Jabalpur-482002 (M.P.) INDIA                         |
| 06. Date of commencement   | : | 3 days from issue of work order.   |
| 07. Date of completion of work   | : | 30 days from issue of work order.  |
| 08. Period for settlement of final bill                                  | : | 30 days from date of issue of completion certificate   |
| 09. Retention percentage   | : | 8% (Eight percentage) from each running bill.  |
| 10. <u>Earnest money deposit (Refundable)<br/>( with Important note)</u> | : | <u>Rs 27,000/- (Rs. Twenty Seven Thousand Only)</u><br><u>(Note:- The Bidders having Registration in MSME are<br/>exempted form EMD deposit . They must attach the<br/>verified copy of MSME Registration certificate)</u> |
| 11. Security deposit   | : | @ 2 % of contract value including EMD before<br>awarding the work.   |
| 12. Release of retention money/ earnest<br>money                         | : | Earnest money after completion of work and<br>certification of final bill.<br>Retention mney after defect liability period.  |
| 13. Value of work for interim certificate                                | : | Rs.5,00,000/- (Rupees Five Lakh minimum)   |

## **TENDER**

### **Bank of Baroda, Asset Recovery Management Branch (ARMB), Jabalpur Interior Furnishing, Electrical , and Air Conditioning Works**

14. Liquidated damages for non-completion of work within the date of completion : If any delay in execution of the works is attributable to the acts or omissions and commissions of PMC, BOB shall be entitled to recover liquidated damages at the rate of 1 % of the total fees per week of delay limited to maximum of 10% of the total actual fees payable for which the PMC agrees hereby that it shall not raise any objection or dispute.
15. Defect liability period : 12 months from the date of completion certificate issued by the Bank Architect.
16. Cost of tender document : Rs. Nil
17. Interested bidder may obtain further information from the office of consultant /Architect.
18. Bank reserves the right to reject wholly or part of any or all tenders received without Assigning any reason whatsoever, Also Bank reserves the right to split the work and place the order to more than one party.

**Contractor's Signature**

**TENDER**  
**Bank of Baroda, Asset Recovery Management Branch (ARMB), Jabalpur**  
**Interior Furnishing, Electrical , and Air Conditioning Works**

**SUBMISSION OF TENDER**

The tenders are to be submitted in separate envelopes each sealed and clearly identified as to envelope number and contents as indicated below. All the envelopes shall be contained in a large envelope “ **Tender for Interior Furnishing, Electrical and Air Conditioning Works in branch premises for Bank of Baroda at Asset Recovery Management Branch (ARMB) Jabalpur Block No-10, 2nd Floor, JDA Building, Civic Centre, Marhatal, Jabalpur (M.P.) 482002** and are to be submitted at **Regional office of Bank of Baroda- 1<sup>st</sup> Floor, Shivmula tower, Wright Town, Jabalpur (M.P.)- 482002** ( Email– [rm.jabalpur@bankofbaroda.com](mailto:rm.jabalpur@bankofbaroda.com) / [pe.jabalpur@bankofbaroda.com](mailto:pe.jabalpur@bankofbaroda.com) ) . Each tenderer will be issued one set of tender documents with schedule of quantities (one set) and drawing. Tenderer will have to return all the documents and drawing issued to them while submission of their tender duly stamped and signed as per instruction.

**ENVELOPE NO. 1 –Technical Bid**

Envelope no. 1 shall contain Technical details of contractor and EMD.

Contractor shall submit :-

- (1) GST Number & Pan number and other KYC documents.
- (2) MSME Registration Certificate verified copy.
- (3) Experience of having successfully completed similar works during last -5- years ending last day of month previous to the one in which applications are invited should be either of the following: -
  - A) Two similar completed works costing not less than the amount equal to 60% (i.e. Rs.15,94,014.60) of the estimated cost. Or
  - B) One similar completed work costing not less than the amount equal to 80% (i.e. Rs.21,25,352.80) of the estimated cost.

The Contractor should submit Performance Certificate from the previous employer in support of executing similar works failing which the tender shall not be considered.

- (4) Similar work means interior furnishing / renovation works of same nature /magnitude carried out for Govt/Public Sector Organizations, banks, public sector financial institutions, involving furnishing, electrification, air conditioning, office automation.
- (5) Average financial turnover during the last -3- years, ending 31st March of the previous financial year, should be at least 30% of the estimated cost.
- (6) Copy of Electrical Licence : In addition to above, the criteria regarding satisfactory performance of works, personnel, establishment, detail of infrastructure, equipment etc may be incorporated in the technical bid.
- (7) Completion certificates of work orders.
- (8) Earnest Money Deposit (EMD) : crossed demand draft DD/Banker’s Cheque payable at Jabalpur, MP of Rs.27,000/- ( Twenty Seven Thousand only) drawn in favor of Bank of Baroda, Regional Office Jabalpur.

\*Vendors having valid MSME Registration certificates are exempted from submitting EMD amount.

**TENDER**  
**Bank of Baroda, Asset Recovery Management Branch (ARMB), Jabalpur**  
**Interior Furnishing, Electrical , and Air Conditioning Works**

**ENVELOPE NO. 2 – Financial Bid**

Envelope no. 2 shall contain tender documents and rates for Schedule of quantities, each page and correction duly signed by tenderer including form duly filled in rates in figures and words both. This envelope will be super scribed “Envelope No. 3 Tender document for Interior Furnishing, Electrical and Air Conditioning Works in branch premises for Bank of Baroda , Asset Recovery Management Branch (ARMB) Jabalpur Block No-10, 2nd Floor, JDA Building, Civic Centre, Marhatal, Jabalpur (M.P.) 482002

**Both sealed/envelope bids should be placed in separate envelopes, which should be marked "Technical Bid envelope" and "Financial Bid envelope" respectively, and the reference details of the information/advertisement should be provided. Both sealed envelopes should be enclosed in one big size sealed envelope and the envelope should be labeled Bank of Baroda, Asset Recovery Management Branch (ARMB), Jabalpur.**

Tender will be available for download only from the website of Bank of Baroda  
<https://ifsc.bankofbaroda.in/tenders>

The applicant's name, address, email id and mobile number should be written on the tender and Sealed Tender must be dropped in a tender box placed at “Regional Office- Regional Office (Jabalpur Region) Plot No- 1170, First Floor, Shiv Moola Tower, Main Road, Wright Town, Jabalpur-482002 (M.P.) INDIA.” by 15:00 Hours on 21.02.2025

Tender should be addressed to The Regional Head, Bank of Baroda, Regional Office- Regional Office (Jabalpur Region): Plot No- 1170, First Floor, Shiv Moola Tower, Main Road, Wright Town, Jabalpur-482002 (M.P.) INDIA.

**Technical Bids will be opened at 15:30 Hours on 21.02.2025**

**Financial Bids: Only Eligible Tenderer shall be informed (Via E-mail/Telephone) separately.**

**TENDER**  
**Bank of Baroda, Asset Recovery Management Branch (ARMB), Jabalpur**  
**Interior Furnishing, Electrical , and Air Conditioning Works**

**Performa -1**

Work costing not less than the amount equal to 50% (i.e. Rs.15,94,014.60) of the estimated cost.

S.No	Name of work / project with address	Name and full postal address of Owner	Contract amount	Stipulated time of competition	Present status of the project	Any other information

Note :

1. Information has to be filled up specifically in this format. Please do not write any remark.

**TENDER**  
**Bank of Baroda, Asset Recovery Management Branch (ARMB), Jabalpur**  
**Interior Furnishing, Electrical , and Air Conditioning Works**

**Performa -2**

Work costing not less than the amount equal to 80% (i.e. Rs. 21,25,352.80) of the estimated cost.

S.No	Name of work /project with address	Name and full postal address of Owner	Contract amount	Stipulated time of competition	Present status of the project.	Any other information

Note :

1. Information has to be filled up specifically in this format .Please do not write any remark.

**TENDER**  
**Bank of Baroda, Asset Recovery Management Branch (ARMB), Jabalpur**  
**Interior Furnishing, Electrical , and Air Conditioning Works**

**PROJECT INFORMATION**

**1.1**

<b>i</b>	<b>Owner</b>	<b>BANK OF BARODA , REGIONAL OFFICE, JABALPUR</b>
<b>ii</b>	<b>Architect</b>	<b>ASHISH SHRIVASTAVA ( KUSHI AND ASSOCIATES),11, Swastik complex, Russel chowk, Jabalpur (M.P.)</b>
<b>iii</b>	<b>Site</b>	<b>Branch Premises of Bank of Baroda – Asset Recovery Management Branch (ARMB) Jabalpur Block No-10, 2nd Floor, JDA Building, Civic Centre, Marhatal, Jabalpur (M.P.) 482002</b>
<b>iv</b>	<b>Work</b>	<b>Interior Furnishing, AC Fitting &amp; Electrical Work's of Bank Of Baroda,Asset Recovery Management Branch (ARMB) Jabalpur Block No-10, 2nd Floor, JDA Building, Civic Centre, Marhatal, Jabalpur (M.P.) 482002</b>

**1.2 SITE CONDITION:**

Tenderer shall visit the site to check the actual site condition prevailing at site. The tenderer shall visit the site and acquaint himself fully of the conditions and no claims what so ever will be entertained on the plea of ignorance or difficulties involved in the execution of work or for carriage of materials, storage, stacking etc., of material. The contractor shall also acquaint himself with existing electrical layout and position of electrical point.

**1.3 SCOPE:**

The work consists of Interior decoration which includes construction of counters, cash counters, partitions, cabinets, false ceiling, electrical wiring, supply & fixing of electrical fixtures like lights, fans, bell, computer wiring, A.C. wiring , earthing, distribution boards, switch boards, etc., in branch premises, some premises may include civil work also.

All work during its progress and upon completion shall confirm to the lines, elevation and grades, as shown on the drawings furnished by Architect, should any detail essential for completion of work be omitted from the drawings and specifications, it shall be the responsibility of contractor to inform the Owner/ Architect and to furnish and install such details with and ready for use.

Owner/ Architect may in their absolute discretion issue further drawings & or written instructions, directions in regard to:

- (a) The variation, alteration, modifications of the design, quality or quantity of work or substitution of any work.
- (b) The removal from site of any defective material brought thereon by the contractor.
- (c) The demolition, removal and/or re execution of any work executed by the contractor.
- (d) The rectification & making good of any defects under clauses hereinafter mentioned and defects arising during the maintenance period.
- (e) The rates of items not mentioned in the schedule of quantities shall be fixed by the Owner in consultation with the Architect as provided in the clause of variation.



## **TENDER**

### **Bank of Baroda, Asset Recovery Management Branch (ARMB), Jabalpur Interior Furnishing, Electrical , and Air Conditioning Works**

**1.4 AGREEMENT:**

The successful contractor may be required to sign agreement as may be drawn up to Suit local conditions and shall pay for all stamps and legal expenses etc.

**1.5 GOVERNMENT AND LOCAL RULES:**

The contractor shall confirm to the provisions of all the local bye- laws and act relating to the work and to the regulations etc., of the Government and local authorities and of any company with whose system the structure is proposed to be connected. The contractor shall give all notices required by the said Act, Rules, Regulations and Bye-laws and pay all fees payable to such Authority/ Authorities for execution of the work involved. The cost, if any shall be deemed to have been included in his quoted rates, taking in account all liabilities for Licenses, fees for footpath encroachment and restoration etc., and shall indemnify the Employer against such liabilities and shall defend all actions arising from such claims or liabilities.

**1.6 TIME OF COMPLETION.**

The total work shall be completed as per the stipulated period, in all respect. The work shall not be considered as complete until the Owner / Architect has certified in writing and the defect liability period shall commence from the date of such certificate.

**1.7 EXTENSION OF TIME:**

If in the opinion of the Employer/ Architect the works be delayed (a) by reason of any exceptionally inclement weather, or (b) by reasons of instruction from the Employer in consequence of proceedings taken or threatened by or disputes, with adjoining or neighboring owners or (c) by the works, or delay, of other contractors or tradesmen engaged or nominated by the Employer and not referred to in the specification or (d) by reason or authorized extra additions or (e) by reasons of any combination of workmen or strikes or lock out affecting any of the building trades or (f) from other causes which the Employer may consider are beyond the control of contractor, the Employer at the completion of the time allowed for the contract shall make fair & reasonable extension of time for completion in respect thereof. In the event of the Employer failing to give possession of the site upon the day specified above, the time of completion shall be extended suitably and no claim or extra rate shall be given.

**1.8 REMOVAL OF IMPROPER WORK:**

The employer shall during the progress of work have power to order in writing from time to time the removal of work within such reasonable time or times as may be specified, in the order of any materials which in the opinion of the Employer/ Architect are not in accordance with specification or instructions, the substitution or proper re-execution of any work with materials or workmanship not in accordance with the drawings and specifications or instructions. In case the contractor refuses to comply with the order the Employer shall have the power to comply and pay other agencies to carry out the work and all expenses consequent thereon or incidental thereto as certified by the Employer/ Architect shall be borne by the contractor. No certificate which may be given by the Architect shall relieve the contractor from his liability in respect of unsound work or bad materials.

**1.9 DAMAGE TO PERSON AND PROPERTY:**

The contractor shall be responsible for all injury to the work or workmen to persons, animals or things and for all damages to the structural and/ or decorative parts of the property which may arise from the operations or neglect of himself or of any sub contractor or of any of his or a sub

## **TENDER**

### **Bank of Baroda, Asset Recovery Management Branch (ARMB), Jabalpur Interior Furnishing, Electrical , and Air Conditioning Works**

contractor's employees, whether such injury or damage arise from carelessness, accident or any other cause whatsoever in anyway connected with the carrying out of this contract. The clause shall be held to include inter-alia, any damage to buildings whether immediately adjacent or otherwise, and any damage to roads, streets, footpaths, or ways as well as damages caused to the buildings and the works forming the subject of this contract by rains, wind or other inclemency of the weather. The contractor shall indemnify the Employer and hold harmless in respect of all and any expenses arising from any such injury or damages to persons or property as aforesaid and also in respect of any acts of compensation or damage consequent upon such claim. The contractor shall reinstate all damages of every sort mentioned in the clause, so as to deliver the whole of contract works complete and perfect in every respect and so as to make or otherwise satisfy all claims for damages to the property of third parties.

**1.10 VALIDITY:**

The contractor should note that the offer shall be valid for a period of 3 months from the date of opening of the quotation by the Bank.

**1.11 SECURITY:**

The Interior decorator contractor will make his own arrangements for the security of his materials of furnishing & decoration, electrical, etc., or any other material at site and the Bank will have no liability of any nature against the security.

**1.12 POWER SUPPLY:**

The power supply required will be made available by the owner for the work of Interior decoration.

**1.13 ELECTRICAL WORK:**

For electrical fixtures and light points required as per drawings the contractor has to draw the wires from existing position of light points, power points where ever and if available. The contractor shall submit the certificate from electrical contractor holding required license from M.P.E.B. and shall also get the old/ new meter, additional connection if required. Any charges towards the deposit/ replacement of meter or for any additional load shall however be borne by the Bank but rest all or any other charges shall be borne by the Contractor himself.

**TESTING & COMMISSIONING:**

Before the lighting/ power installation is made alive the Contractor shall carry out tests enumerated below in presence of Employer/ Architect or his authorized representative. All testing equipments necessary to carry out the tests shall be arranged by the Contractor and the test results recorded on approved proforma. Nothing extra shall be payable for testing.

01. Measure insulation resistance of each circuit without lamps being in place and it should be less than 5 mega ohms to earth.
02. Before energizing, measure insulation resistance of the cable from phase to phase and that from phase to ground. Insulation resistance of the bus bars at the lighting panel from phase to phase and from phase to ground shall be measured before energizing the panel and should comply latest IS codes.
03. Current and voltage of all phase shall be measured at the lighting panel bus bars with all circuits on the fixtures and also in all switch boards.

## **TENDER**

### **Bank of Baroda, Asset Recovery Management Branch (ARMB), Jabalpur Interior Furnishing, Electrical , and Air Conditioning Works**

04. Check the earth continuity for all socket outlets. A fixed relative position of the phase & neutral connection inside the socket shall be established for the sockets.
05. The earth electrodes shall be tested for earth resistance by means of standard earth tester. The resistance between the earthing system and the general mass of earth shall not be greater than 1 ohm.
06. While crossing the expansion joints of building, conduits shall be provided with flexible pipe and shall not be more than 250mm, at both the ends of conduit, proper flexible couplings shall be provided and earth wire shall be properly connected to earthing terminal of coupling.
07. Contractor should quote after site visit only. In case for cable trench, street light pole, pit, earthing pit, etc., or any place where Contractor has to dig the earth in hard strata or rock he has to do so at quoted rates only for item. No blasting shall be allowed for such digging.
08. For earthing of street light tubular pole earth spirit shall be used & 8 SWG G.I. wire as per standard specifications.

#### **1.14. VARIATION / DEVIATION :**

The contractor may when authorized and shall when directed in writing by the Employer add and or omit, or vary the works given in the drawings or described in the specifications of included in the priced schedule or quantities. The contractor on his own accord shall make no addition, omission or variation without such authorization or direction. A verbal authorization or direction by the Employer shall when confirmed correctly by the contractor in writing within 3 days shall be deemed to have been given in writing.

The price of all such additional items will be worked out on basis of rates quoted for similar items in the contract wherever existing or on engineering rate analysis based on prevalent fair price of labor, material and other components as required.

#### **2.0 COMMERCIAL TERMS:**

##### **2.1 PAYMENTS:**

All bills shall be prepared by the Contractor in the form prescribed by Owner/ Architect, accompanied by detailed measurement in support of the quantities of work done. The Architect shall issue a certificate after due scrutiny of contractor's bill. The owner shall make the payment within 7 days of the date of certified bill by the Architect, after making deduction as per clauses.

All running bill shall be treated as advance payment only. However each running bill shall not be of value less than Rs.5,00,000/-

##### **2.2 RETENTION AMOUNT:**

Retention money shall be deducted from progressive running bills @ 10% of the gross value of each running bill.

##### **2.3 INCOME TAX: (Item 2.3 (a) not applicable for empaneled contractors.)**

(a) The contractor shall furnish income tax clearance certificate along with tender.

## **TENDER**

### **Bank of Baroda, Asset Recovery Management Branch (ARMB), Jabalpur Interior Furnishing, Electrical , and Air Conditioning Works**

(b) As per prevailing rate of income tax notification, shall be deducted from the payment of each running bill for which required certificate shall be issued by the owner.

#### **3.0 INSTRUCTION TO CONTRACTOR'S & GENERAL TERMS AND CONDITIONS: (Item 3.1 to 3.7 not applicable for empaneled contractor's.)**

- 3.1** Each contractor has to furnish the following details regarding their financial capacity & experience along with the tender.
- 3.2** Class of registration of firm and the registration year (enclose photo copy of the registration certificate).
- 3.3** Agency with whom registered.
- 3.4** Value of work for which registration has been made (if registered with various agencies giving details or registration to above in case of all agencies).
- 3.5** The name of partners and detailed bio- data of each partner (enclosed copy of partnership deed) in case of firm. In case of company, its memorandum of Article of Association is to be enclosed. In case of Proprietary, bio- data of proprietor is to be enclosed.
- 3.6** Date of registration of firm.
- 3.7** Details of number of technically qualified employees engaged by your firm and their bio-data.
- 3.8** Architect will undertake periodic supervision of Interior decoration work and will ensure the quality of work and will check measurement s of the running bills.
- 3.9** The Architect will check all running bills submitted by the contractor within a period of 15 (fifteen) days from the receipt of the same & will recommend for payment.
- 3.10** All the finishing materials like laminates, tapestry, rexin, colors for color scheme, lighting fixtures will have to be got approved by the Architect before implementation.
- 3.11 EXPERIENCE:** (Item 3.11 not applicable for empaneled contractors)  
The contractor should have minimum 3 years Interior decoration experience and should have decorated similar type of work in the name of company on whose behalf the contractor is holding this tender. The contractor should submit the details of works executed and works in hand.
- 3.12** Each and every page of the specification and schedule of quantities etc., should be signed by the contractor before submission, as a token of acceptance, correction if any should be attested.

## **TENDER**

### **Bank of Baroda, Asset Recovery Management Branch (ARMB), Jabalpur Interior Furnishing, Electrical , and Air Conditioning Works**

- 3.13** Rates quoted should be in figures as well as in words and there should not be any over writing as far as possible.
- 3.14** Bank shall not be responsible in any way for an interruption, failure of power supply and the same shall not be considered as a reason for the delay in the completion of the work awarded.
- 3.15** The quantities specified are indicated for the purpose of estimate only. During the actual execution of Interior decoration work specified Bank shall be at liberty to vary ( delete/ reduce/ increase) the quantum of any item of work or execute through any other agencies, as per their discretion, and the contractor shall have to carry the work as per rates quoted by them, and the contractor shall be not entitled for any extra compensation.
- 3.16** No escalation on any account of labor, material or any enhancement of statutory forces by the Government to employees of the contractor etc., shall be allowed. No enhancement in case of any type of levy imposed by the Government on any of the raw material used for Interior decoration work shall be allowed.
- 3.17** **GST WILL BE PAID EXTRA AS PER GUIDELINES.**
- 3.18** **POWER OF ATTORNEY:**  
The quotation should be signed by any authorized person/partner who has the power of attorney to sign the contract as also for entering into an agreement with the respect, to the above, should be submitted along with the quotation.  
Submission of quotation shall be treated as the acceptance of these terms and conditions and any counter terms shall not be accepted.
- 4.0** **DRAWINGS INSTRUCTION AND MEASUREMENT:**  
All work shall be done according to the detailed drawings of the Architect. Measurements shall be taken of actual work done, as per schedule of items.
- DRAWINGS:**  
The drawings as listed under the schedule of drawings are the part of the tender and the contractor shall strictly adhere to the same. The contractor shall read the working drawings carefully while quoting the rates. If necessary additional details, drawings shall be issued at the time of execution. The contractor shall provide the furnishing items as per the drawings, deviations shall be paid on the basis of the analysis approved by the Architect.
- 4.1** **SAMPLES:**  
Samples of materials used in each item of work shall be submitted by the contractor at his own cost for the approval of the architect, and the contractor will be required to perform all work under this contract in compliance with the samples at his own cost.
- 4.2** **STORAGE:**  
Safe, dry and proper storage and security shall be the responsibility of the contractor.

## **TENDER**

### **Bank of Baroda, Asset Recovery Management Branch (ARMB), Jabalpur Interior Furnishing, Electrical , and Air Conditioning Works**

**5.0 RIGHT TO REJECT BIDS:**

Bank reserves the right to accept or reject any or all the tenders in full or part or to waive any informally , minor deviations and omissions without assigning any reasons, right to reject conditional tenders and also relax any contract condition at its discretion.

**5.1 RIGHT TO ACCEPT:**

Bank is not in any way bound to accept the lowest or any quotation and reserves to itself, the right to accept any or in whole or any part of the quotation or portion of the quantity offered and reserves the right to negotiate with any /all the contractors.

**5.2 RIGHT OF OWNER TO DETERMINATE/ TERMINATE CONTRACT:**

Bank shall at any time be entitled to determinate the contract if in the opinion of the Owner, reduction of the work becomes necessary owing to paucity of funds or from any other cause whatsoever.

The cost of approved materials at the site at the current market rates or original purchase rates whichever is lower as verified and decided by Bank and the value of such work done to date by the contractor shall be paid in such occurrence.

**5.3 FORCE MAJOR:**

Any delay or failure of the performance of either party here to shall not constitute default hereunder or give rise to claims for damages if any to the extent such delay or failure of performance is caused by occurrence such as Acts of God or the public enemy, expropriation or confiscation of facilities by Government authorities, Act of war, rebellion or sabotage or fire, flood, explosion or illegal strikes.

**6.0 SITE ORDER BOOK:**

The contractor shall maintain site order book at site and will have to submit the same at the time of applying for completion certificate.

All instruction changes, deviations, additions or alterations be recorded and duly signed by contractor, In charge officer of the Bank, and Architect in the site order book of contractor which will form a part of document.

**6.1 COMPLETION CERTIFICATE:**

On completion of entire interior decoration work the contractor shall be eligible to apply for completion certificate. The In charge officer of the Bank, shall issue the completion certificate within 15 days after receiving the letter from the contractor along with the following documents on recommendation of the Architect.

(a) The total working drawings issued to the contractor according to which the work is executed.

(b) Site order book if any duly signed by the Architect and In charge officer of the Bank and the contractor or his representative.

(c) Any other drawings issued by Architect during execution.

(d) All measurement books/ bills duly signed by In charge officer of the Bank.

**6.2 DEFECT LIABILITY PERIOD:**

On completion of the work at site as certified by the Architect and the Engineer In charge the contractor shall be responsible against the manufactured and installation for the furnishing and decoration as executed by him for a period of 12 months. He shall rectify any defects pointed

## **TENDER**

### **Bank of Baroda, Asset Recovery Management Branch (ARMB), Jabalpur Interior Furnishing, Electrical , and Air Conditioning Works**

by In charge Officer of the bank & ensure proper performance of the job done by him till such time.

#### **7.0 EXTRA ITEMS:**

If necessary the contractor shall execute any other item of work not covered up by the schedule of quantities of item and the working drawings which shall be paid to the contractor as extra item. Rates of such extra items shall be settled on the basis of ( a) on the basis of market rate and decision of Regional Manager of Bank and will be final and binding on the recommendation of the Architect. Before execution of such extra item prior approval of item and rate must be taken by the contractor from the In charge / Architect.

#### **8.0 COMPENSATION FOR DELAY:**

The times allowed for carrying out work as entered in the contract shall be strictly observed by the contractor and shall be reckoned from the date on which the order to commence work is given to the contractor. The work shall throughout the stipulated period of the contract be proceeded with all due diligence (time being deemed to the essence of the contract of the part of the contractor) and the contractor shall pay as compensation an amount of 1 % of the total fees per week of delay limited to maximum of 10% of the total actual fees payable, on the amount of the estimated cost of the whole work as shown in the contract, every week, that the work remains un commenced or un furnished after the proper dates , provided always that the entire amount of compensation to be paid under the provisions of this clause shall not exceed 10% of the work order.

#### **9.0 ARBITRATION:**

All disputes or differences of any kind whatsoever which shall at any time arise between the parties here to touching or concerning the works or the execution or maintenance there of this contract or the construction remaining. Operation or effect thereof or to the rights or liabilities of the parties or arising out of or in relation there to whether during or after determination for closure or breach of contract ( other than those in respect of which the decision of any person is by the contract expressed to be final and binding) shall after written notice by either party to the contract to the other of them and to Employer herein after mentioned be referred for adjudication to a sole Arbitrator to be appointed as hereinafter provided.

For the purpose of appointing sole Arbitrator referred to above, the Employer will send within thirty days of receipt of the notice, to the contractor a panel of three names who shall be presently unconnected with the organization for which the work is executed.

The contractor shall on receipt of the names as aforesaid select any one of the persons name to be appointed as sole Arbitrator and communicate the name to the Employer within thirty days of receipt of the names. The Employer shall there upon without any delay appoint the said person as sole Arbitrator. If the Contractor fails to communicate such selection as provided above within the period specified, the competent authority shall make the selection and appoint the selected person as sole Arbitrator. If the Employer fails to send to the contractor the panel of three names as aforesaid within 30 days of receipt of the panel and inform the Contractor accordingly, the contractor shall be entitled to appoint one of the persons from the panel as the sole Arbitrator and communicate his name to the Employer.

If the Arbitrator so appointed is unable or un willing to act or resigns his appointment or vacates his office due to any reason what so ever another sole Arbitrator shall be appointed as aforesaid.

## **TENDER**

### **Bank of Baroda, Asset Recovery Management Branch (ARMB), Jabalpur Interior Furnishing, Electrical , and Air Conditioning Works**

The work under the contract shall, however, continue during the arbitration proceedings and no payment due or payable to the contractor shall be withheld on account of such proceedings.

The Arbitrator may from time to time, with the consent of parties, enlarge the time for making and publishing the award.

The Arbitrator shall give a separate award in respect of each dispute in accordance with the terms of the contract and give a reasoned award. The venue of arbitration shall be such place as may be fixed by the Arbitrator in his sole discretion.

The fees if any of the Arbitrator shall, if required to be paid before the award is made and published, be paid half and half by each parties. The cost of the reference and of the award including the fees, if any, of the Arbitrator who may direct to and by whom and in what manner, such costs or any part thereof shall be paid and may fix or settle an amount of costs to be paid.

**The award of the Arbitrator shall be final and binding on both the parties.**

Subject to aforesaid the provisions of the Arbitration Act 1940 or any statutory modification or re-enactment thereof and the rules made there under, and for the time being in force, shall apply to the Arbitration proceedings under this clause.

The Employer and the Contractor hereby also agree that arbitration under clause shall be a condition precedent to any right to action under the contract with regard to the matters hereby expressly agreed to be so referred to Arbitration.



## TENDER

**Bank of Baroda, Asset Recovery Management Branch (ARMB), Jabalpur  
Interior Furnishing, Electrical , and Air Conditioning Works**

### **BANK OF BARODA (FOR INTERIOR FURNISHING WORKS) TECHNICAL SPECIFICATION OF MATERIAL TO BE USED**

S.No.	ITEM	SPECIFICATION	TRADE NAME
01.	Block board IS : 1659	19 mm thick ( MR grade)	Nuwud,Century,Asian, Greenply or Duro.
02.	Plywood IS : 303	6mm, 8mm, 12mm ,18mm & 25mm thick ( MR grade)	Nuwud,Century,Asian, Greenply or Duro.
03.	Pre laminated board	12mm	Novapan, Greenlam,
04.	Laminate	1mm thick	Formica,Sunmica or National,Merino
05.	Glass	10mm, 12 mm Toughen glass	Modi, Saint Gobin
06.	Aluminum	16 gauge	Man Aluminum or Jindal.
07.	Adhesive	SH, SR & SPEEDX	Fevicol, Jivanjor, Anchor
08.	Hardware fittings	Locks, handles, screws,hinges, drawer channels, magnetic ball catcher , Floor spring etc.	Superior quality like Godrej, Nettelfold, Ebco,Ozone, Dorma
09.	Entrance door	Patch fitting	Ebco, Ozone.
10.	Paint	Oil bound distemper, Premium plastic emulsion paint, synthetic enamel paint	Asian, Berger, Nerolac.
11.	Foam	6mm, 25mm, 50mm, 75mm, 100mm thick free from defects	U-foam, MM foam or equivalent minimum 40 density.
12.	Rubber foam	50mm, 75mm & 100mm thick free from defects	Dunlop, prestige or equivalent.
13.	Tiles	Vitrified & Glazed	Nitco, Kajaria , Somany or Johnson
14.	Vertical blinds	10mm wide	Vista, Trac, Mac.
15.	KOREAN- Table top	12mm thick	Polyacrylic 12mm thick stone (Plain White KOREAN)
16.	Gypsum false ceiling	12.5 mm thick	gypsumboard (IS2095-1982) or Heavy duty Commercial 2'x2'
17.	Calcium silicate false ceiling	Size595x595mm of approved texture, design and patterns having NRC(Noise Reduction coefficient) of 0.50 (minimum)as per IS8225:1987	Aerolite , Cerama Guard or Newton make

## TENDER

### Bank of Baroda, Asset Recovery Management Branch (ARMB), Jabalpur Interior Furnishing, Electrical , and Air Conditioning Works

#### BANK OF BARODA (FOR ELECTRICAL AND AC WORKS) TECHNICAL SPECIFICATION OF MATERIAL TO BE USED

S.No.	ITEM	SPECIFICATION
01.	MCB, MCCB	MDS (legrand), L&T, Havells, Schneider,ABB,Siemens
02.	DB's (double door)	MDS (legrand), L&T, Havells, Schneider,ABB,Siemens
03.	Copper conductor ,PVC insulated wires ( Fire resistant)	Polycab, Finolex, Anchor, RR cables, KEI, Havells
04.	M.S./PVC conduit	BEC, Steel Kraft, AKG, Crown.
05.	Telephone wires	Polycab, Delton.d link
06.	Modular switch & socket	MDS Legrand, Anchor L&T,MK, Elleys, ROMA
07.	Telephone socket	MDS legrand, Anchor L & T
08.	Ceiling fans & Wall Fans	Crompton, Khaitan. BAJAJ ,USHA, Havells , Orient
09.	Exhaust Fans	Crompton, Khaitan. BAJAJ ,USHA, Havells, Orient
10.	Fittings & Fixtures (LED, Tubelight, Downlighters )	Wipro, Philips, Crompton, Havells, Osram, Halonix
11.	AC Unit Voltage Stabilizers	V-Guard , Microtek
12.	Air conditioner ( 3 star) – Split Type & Cassette Type AC's	2.0 Ton ,1.5 Ton & 1.0 Ton - Capacity Cassette & Split A.C's with remote.(Voltas, Carrier, Bluestar , Daikin)

**TENDER**  
**Bank of Baroda, Asset Recovery Management Branch (ARMB), Jabalpur**  
**Interior Furnishing, Electrical , and Air Conditioning Works**

**LETTER SUBMITTING TENDER**

**To,**  
**The Asst. General Manager**  
**Bank of Baroda, Regional office**  
**Jabalpur (M.P.).**

**Sub: Tender for Interior Furnishing, Electrical and Air Conditioning Works of Asset Recovery Management Branch (ARMB) Jabalpur , Civic Centre Jabalpur (M.P.)**

**Dear Sir,**

Having examined the drawing, specifications, schedule of quantities relating to works specified in the memorandum here in after set and having visited and examined the site of the works specified in the said memorandum and having acquired the requisite information relating there to as affecting the tender. I/We hereby offer to execute the works specified in the said memorandum within the time specified in the said memorandum at the rates mentioned in the attached schedule of quantities and in accordance with the specifications in all respect, designs, drawing and instructions in writing referred to in condition of tender the Articles of Agreement, special conditions, schedule of quantities and condition of contract and with such materials as are provided for, by and in all other respects in accordance with such conditions so far as they may be applicable.

**MEMORANDUM**

- (a) **Description of work: Interior Furnishing, Electrical and Air Conditioning Works of Asset Recovery Management Branch (ARMB) Jabalpur , Civic Centre Jabalpur (M.P.)**
- (b) **Earnest Money : Rs. 27,000/-**
- (c) **Completion time : 30 Days( Thirty days)**

1. Should this tender be accepted, I/We hereby agree to abide by and fulfill the terms and provisions of the said conditions of contract annexed here to so far as they are applicable or in case of default will pay to Bank the amount mentioned in the said conditions.

2. I / We deposited a sum of \_\_\_\_\_ as earnest money in the form of Demand draft bearing No. \_\_\_\_\_ dated \_\_\_\_\_ drawn in favour of DGM Bank of Baroda, Bhopal, which is not to bear any interest. should I / We fail to execute the contract when called upon to do so I / We do hereby agree that this sum shall be forfeited by the Bank.

3. Our Bankers are:

4. The name of partners of our firm are:

(Sig. of the contractor & seal)

**TENDER**

**Bank of Baroda, Asset Recovery Management Branch (ARMB), Jabalpur  
Interior Furnishing, Electrical , and Air Conditioning Works**

**FINANCIAL BID for Furnishing, Electrical, and Air Conditioning Works of Proposed  
Asset Recovery Management Branch (ARMB) Jabalpur Block No-10, 2nd Floor, JDA Building,  
Civic Centre, Marhatal, Jabalpur (M.P.) 482002**

**SUMMARY OF TENDER QUOTED AMOUNT :-**

S.NO.	PART	SUB PART	DESCRIPTION	AMOUNT (Rs.)
1	A	I	BRANCH - FURNISHING WORK	
2	B	II	BRANCH – ELECTRICAL WORK	
<b>TOTAL = A+B</b>				

**Name of Bidder :-**

**Signature and seal of Bidder :-**

**Date:**

**Place:**

## TENDER

**Bank of Baroda, Asset Recovery Management Branch (ARMB), Jabalpur  
Interior Furnishing, Electrical , and Air Conditioning Works**

**Bill of Quantities for Proposed Interior Furnishing of Bank of Baroda,  
Asset Recovery Management Branch (ARMB) Jabalpur  
Block No-10, 2nd Floor, JDA Building, Civic Centre, Marhatal, Jabalpur (M.P.) 482002**

S.No	Item and Specification	Qty.	Unit	Rate	Amount
1	<b>ENTRANCE DOOR</b>  Providing and fixing frameless fully glazed 12 mm Thick toughened float glass fixed Over floor spring and opening shall be min 30".with necessary patch fittings (Dorma make) including cutting, making holes, cutouts in the glass of required shape and size to BWR IS 303 date fittings and fixing the fittings in floors, soffits, jams including necessary fixtures, screws, sealant wherever required and SS cover over patch fittings.Rate shall include necessary etching film / LOGO, approved patch fitting locking systems, 1 pair of 4' long S. S.(C Shape) Handles of approved make,floor springs, and any necessary hardware items.(DORMA MAKE Top Pivot - PT 24, Top Patch Fittings - PT 20, Bottom Patch fittings - PT 10, Floor Spring should be of BTS 75 V, Corner lock with strike plate and Euro Profile Cylinder - US 10, Handle - TG 9300 EQ - S 25mm dia X 1200mm length) complete as per attached drawings specifications and manual standard under supervision of bank Architect.	7.00	S.mt		
2	<b>FIXED FULL HEIGHT GLAZING PARTITION OVER TW FRAME AT FRONT – (MEETING HALL FRONT AND AGM FRONT )</b>  Providing and fixing fully glazed 12 mm thick toughened float glass fixed with TW bottom and top frame & necessary patch fittings (Dorma make) including cutting, making holes, cutouts in the glass of required shape and size to BWR IS 303 date fittings and fixing the fittings in floors, soffits, jams including necessary fixtures, screws, sealant wherever required and SS cover over patch fittings.Rate shall include necessary etching film / LOGO, and any necessary hardware items.(DORMA MAKE Top Pivot - PT 24, Top Patch Fittings - PT 20, Bottom Patch fittings - PT 10) full height laminated partition complete as per attached drawings specifications and manual standard under supervision of bank Architect.	15.00	S.mt		

## TENDER

### Bank of Baroda, Asset Recovery Management Branch (ARMB), Jabalpur Interior Furnishing, Electrical , and Air Conditioning Works

3	<p><b><u>FULL HEIGHT PARTLY GLAZED PARTITION</u></b> <b><u>(UP TO 2450 MM Height):-</u></b> <b>( MEETING HALL SIDE AND AGM SIDE PARTITION)</b></p> <p>Providing and fixing ( 910 mm height of lower portion should be wooden frame 600 mm c/c and remaining 1210 mm height of 12 mm toughened single piece glass of modifloat/ saint gobin make &amp; remaining 300 mm height should be wooden frame 600 mm c/c ) fitted with the teak wood frame in proper grooving of top &amp; bottom. The lower portion should be of teakwood frame work 75 mm thick to be fixed with self tapping steel screws to each other, with spacing at 600 c/c both ways as per the site requirements to be erected as per drawing. The lower and upper portion with 6 mm thick BWP Ply , finished with 1.00 mm thick approved shed of laminate. The teak wood framing should be fine finished and fitted properly to the wall and ceiling the vertical members. The glass should be single border etched as per Architects advice. All the above fittings with required beading for glass fixing should be in proper fitting and with melamine polish. Above all materials, necessary fittings, labour etc complete strictly as per the drawing.</p>	18.30	S.mt		
4	<p><b><u>AGM AND MEETING HALL DOOR'S</u></b> <b><u>( FULLY GLAZED)-</u></b></p> <p>Providing and fixing at site single leaf door of 2135(h) full of 12 mm thick toughen glass single piece glass of modifloat/ saint gobin make fitted with the teak wood finished frame in proper grooving of top, bottom size of 5"x2"and both side frame size of 4"x2". The teak wood framing should be fine finished with the provision of brass hinges, approved type of handles of any standard is make brass/ metallic handles including the godrej locking system. The Hyper make door closer/ floor spring as per required should be provided. The glass should be double border etched with the centre logo of the bank as per Architects advice. All the beading and other fittings if needed should be including all materials, necessary fittings, labour etc complete strictly as per the drawing. <b>(Note:-The ply, boards, laminates should be make of Green/Century/ Duro &amp;Glass should be make of Saint Gobin/Modi float)</b></p>	3.90	S.mt		

**TENDER**

**Bank of Baroda, Asset Recovery Management Branch (ARMB), Jabalpur  
Interior Furnishing, Electrical , and Air Conditioning Works**

5	<p><b><u>FLUSH DOORS</u></b> ( 3'-0" width x 7'-0" height) Flush door shutters with particle board beaded type core shall be manufactured with core of particle boards of Century Or MDF make conforming veneered. The beading shall be of solid timber of any of the species mentioned in Appendix A of IS : 2202 (Part 1)-1983§. The beading shall be to the full thickness of the door. The depth of beading all round shall be not less than 25 mm excluding the tongue for the joint. The beading shall be provided all round and shall be fixed by tongue and brew joint using BWP type adhesives conforming to IS : 848-1974‡, and the beading shall be further secured by additional screws of adequate length. The tongue shall not be less than 12 mm deep, and its width shall not be less than 1/3 of the finished thickness of the shutter. The timber used for beading for flush doors with decorative face shall preferably be of the same species as the face. All the four edges of the door shutter shall be square. The shutter shall be free from twist or warp in its plane. Both faces of the door shutter shall be sanded to a smooth even texture. If required by the purchaser, all surfaces of shutters which are required to be painted ultimately shall be covered evenly by brush painting with suitable priming coat. Shutters shall be Godrej make locks or latches. And hinjes of heavy duty bronze make with complete fitting complete strictly as per attached drawings specifications and manual standard under supervision of bank Architect.</p>	13.10	S.mt		
6	<p><b><u>HALF HEIGHT PARTITION (EACH CUBICAL TABLE UNIT AND IN CHARGE OFFICER )</u></b> Providing and fixing at site Half Height Partition with Partly glazed 10 mm thick toughened float glass ( 600 mm height from table top) with as per the design &amp; drawing of Conventional Furnishing type as provided in the Bank's Ambience Standardization Manual 75 mm thick consisting of double skin laminated finished partition on teak wood frame provided on both sides with 6mm water proof ply and finished with cedar finished laminate of 1.0 mm thickness, approved colour the top 300 mm height</p>	32.40	S.mt		

**TENDER**

**Bank of Baroda, Asset Recovery Management Branch (ARMB), Jabalpur  
Interior Furnishing, Electrical , and Air Conditioning Works**

	has to be provided with 10 mm thick float glass of approved made with etching and with all exposed edges polished finished. The Half Height Partition is to be made strictly as the drawings specification and design including all materials, labour etc. complete as per attached drawings specifications and manual standard under supervision of bank Architect. <b><u>Note:- The ply, boards, laminates should be make of Green/Century/ Duro</u></b>				
7	<b><u>WALL AND COLUMN PANELLING WITH LAMINATED FINISH-</u></b> INTERIOR- A tubular frame 50 x 38 x 1.2 mm at 600 mm c/c horizontally & vertically, anchored to the floor & the slab on top with skin on both sides of 9 mm thick BWR IS 303 grade plywood. Providing and fixing at site wall and columns paneling of tubular frame 50 x 38 x 1.2 mm at 600 mm c/c horizontally & vertically, anchored to the floor & the slab on top with skin on both sides of 9 mm thick BWR IS 303 grade plywood. The exterior surface to be finished with Laminate as specified in drawing enclosed. Exterior side Laminate finished over 6 mm commercial ply fixed over Aluminium sections per requirement. The 4" top & Bottom Skirting shall be made of 1" Red Laminate & 3" Blue Laminate completes strictly as per attached drawings specifications and manual standard under supervision of bank Architect. <b>Exterior- The exterior surface to be finished with Laminate as specified in drawing enclosed. Exterior side Laminate finished over 6 mm commercial ply fixed over Aluminium sections as per requirement. The rail of Rolling Shutter and top should be camouflaged by wooden box paneling whose exterior side to be finished with laminate.</b>	94.30	S.mt		
8	<b><u>GYPSUM FALSE CEILING IN HALL</u></b> Providing and fixing gypsum false ceiling Clear height of 8' shall be ensured between finished floor level and finished false ceiling level. The false ceiling must have provision of concealed wiring in conduit	36.20	S.mt		



## TENDER

### Bank of Baroda, Asset Recovery Management Branch (ARMB), Jabalpur Interior Furnishing, Electrical , and Air Conditioning Works

	<p>connecting the mainaccess Lock with panel in back room or storage</p> <p>Unit of Indian gypsumboard (IS2095-1982) or Heavy duty Commercial 2'x2' metallic frame with ceiling tiles equivalent make in 12.5mm thick Gypboard (POP) plain false ceiling with GI suspended from RCC slab/Beam as approved by Bank/ Architect including G.I. Parameter Channels of size 0.55 mm thick having one flange of 20 mm and another flange of 30mm an web 27mm along with parameter of ceiling, screw fixed to the brick wall/partition with the help of nylon sleeves and screws at 600mm C/C. The suspended G.I. Intermediate channels of size 45 x 0.9 mm thick with two flanges of 15mm each from the soffit at 1200mm C/C with GI cleats and steel expansion fasteners. Ceiling sections of 0.55 mm thick having web of 51.5 mm and two flanges of 26 mm each with lips of 10.5 mm are then fixed to intermediate channel with help of connecting clips and in direction perpendicular to intermediate channel at 457 mm C/C 12.5 mm Tapered edge Gyboard channel at 457 mm C/C in both the directions screwed fixed to the ceiling section with 25 mm dry wall screws at 230mm C/C screw, fixing is done mechanically with drilling machine and suitable attachment. Finally the boards are to be jointed and finished with jointing compound, paper tape and two coats of top coat, suitable for Gypboard (As recommended practice of India Gyp.) For light fittings in cutouts etc. are to be made with a frame of parameter channels of size 20 x 27 x 30 x 0.5mm thick supported suitably. Angle beads, edge bends control joints as recorded to be provided. The quoted rates to include all the above items, ceiling to be painted with minimum two coats of white color plastic emulsion paint including base preparation etc. complete strictly as per attached drawings specifications and manual standard under supervision of bank Architect.</p>				
9	<p><b><u>CALCIUM SILICATE FALSE CEILING</u></b></p> <p>Providing and fixing false ceiling at all heights with integral densified calcium silicate reinforced with fibre and natural filler false ceiling tiles of</p>	69.00	S.mt		

**TENDER**

**Bank of Baroda, Asset Recovery Management Branch (ARMB), Jabalpur  
Interior Furnishing, Electrical , and Air Conditioning Works**

	<p>Size 595x595mm of approved texture, design and patterns having NRC (Noise Reduction coefficient) of 0.50 (minimum) as per IS 8225:1987, Light reflectance of 85% (minimum). Non-combustible as per BS:476 (part-4), fire performance as per BS:476 (part 6 &amp; 7), humidity resistance of 100%, thermal conductivity &lt; 0.043 W/m K as per ASTM 518:1991, in true horizontal level suspended on inter-locking metal T-Grid of hot dipped galvanized iron section of 0.33mm thick (galvanized @ 120 grams per sqm including both sides) comprising of main-T runners of size 24x38 mm of length 3000 mm, cross-T of size 24x32 mm of length 1200 mm and secondary intermediate cross-T of size 24x32 mm of length 600mm to form grid module of size 600 x 600 mm, suspended from ceiling using galvanized mild steel items (galvanizing @ 80 grams per sqm) i.e. 50mm long, 8mm outer diameter M-6 dash fasteners, 6 mm dia fully threaded hanger rod up to 1000 mm length and L-shape level adjuster of size 85x25x 25x2 mm. Galvanized iron perimeter wall angle of size 24x24x0.40mm of length 3000 mm to be fixed on periphery wall/ partition with the help of plastic raw plug sat 450mm center to center and 40mm long dry wall S.S screws. The work shall be carried out as per specifications, drawing under supervision of bank Architect.</p> <p>With 15mm thick tabular edged light weight calcium silicate false ceiling tiles. Three Approved Makes for tender reference: 1) Aerolite , 2) Cerama Guard, 3) Newton complete strictly as per attached drawings specifications and manual standard under supervision of bank Architect.</p>				
10	<p><b>FULL HEIGHT WITHOUT GLAZED PARTITION WITH DOOR - ( ENTRY FOYER- AGM CABIN BACK ) :-</b> <b>FULL HEIGHT WITHOUT GLAZED PARTITION WITH LAMINATES AND LOGO OF BANK AS PER DRAWING :-</b> Supplying and erecting Full height partitions (upto max. 2800 mm. high ) as per drawing and conforming</p>	9.20	S.mt		

**TENDER**

**Bank of Baroda, Asset Recovery Management Branch (ARMB), Jabalpur  
Interior Furnishing, Electrical , and Air Conditioning Works**

	<p>to the following specifications :</p> <p><u>basic frame work</u> :</p> <p>teak wood frame work sections, treated with two coats of wood preservatives, 75 mm finished at 600 mm horizontal or vertical spacing as per site conditions.</p> <p><u>skin membrane</u> :</p> <p>6 mm thick BWR grade plywood on each face, with grooves formed as per drawing/instruction.</p> <p><u>finishing</u> :</p> <p>1.0 mm thick laminate sheet of same or combination shades as per instructions.</p> <p><u>Edge moulds</u> :</p> <p>All free top/end surfaces shall have polished teak wood skirting with NC lacquer finish.</p>				
11	<p><b>FULL HEIGHT WITHOUT GLAZED PARTITION WITH DOOR - ( BOTH RECORD ROOM AND OTS ) AS PER DRAWING :-</b></p> <p>Supplying and erecting Full height partitions (upto max. 2800 mm. high ) as per drawing and conforming to the following specifications :</p> <p><u>basic frame work</u> :</p> <p>teak wood frame work sections, treated with two coats of wood preservatives, 75 mm finished at 600 mm horizontal or vertical spacing as per site conditions.</p> <p><u>skin membrane</u> :</p> <p>6 mm thick BWR grade plywood on each face, with grooves formed as per drawing/instruction.</p> <p><u>finishing</u> :</p> <p>2.0 mm thick laminate sheet of same or combination shades as per instructions.</p> <p><u>edge moulds</u> :</p> <p>All free top/end surfaces shall have polished teak wood skirting with NC lacquer finish.</p>	41.20	S.mt		
12	<p><b>STORAGE -</b></p> <p><b>(a) Low Height Storage ( AGM AND ALL OFFICERS )</b> Providing and fixing at site storage cabinet 3’ High fully covered from all sides and 16” deep including necessary shelves as per the design and specifications with openable</p>	14.40	S.mt		

**TENDER**

**Bank of Baroda, Asset Recovery Management Branch (ARMB), Jabalpur  
Interior Furnishing, Electrical , and Air Conditioning Works**

	<p>shutters made up of 19mm BWP ply. The rear portion is to be closed with 8.0mm ply; the top shall have 19-25mm approved shade Granite single piece stone with front beveled edge. Front of the cabinet is to be finished with 1.0mm thick laminate of 6” wide metallic steel finish border at bottom with approved pattern with different colour laminated finish of approved shade &amp; colour with Proper Teak wood molding, beadings, and different colour laminate as per pattern in shutters and in skirting strictly as per the design, pattern, including all necessary fittings, such as locks, handles. The inside portion is to be properly painted with one coat of wooden primer and two coats of Luster finished synthetic enamel. The cost shall include all materials, labour, accessories etc. complete strictly as per attached drawings specifications and manual standard under supervision of bank Architect.</p> <p><b>(b) Full Height Storage</b> Providing and fixing at site storage cabinet 7’ High fully covered from all sides and 16” deep including necessary shelves as per the design and specifications with openable shutters made up of 19 mm BWP ply. The rear portion is to be closed with 8.0mm ply, Front of the cabinet is to be finished with 1.0mm thick laminate of 6” wide metallic steel finish border at bottom with approved pattern with different colour laminated finish of approved shade &amp; colour with Proper Teak wood molding, beadings, and different colour laminate as per pattern in shutters and in skirting strictly as per the design, pattern, including all necessary fittings, such as locks, handles. The inside portion is to be properly painted with one coat of wooden primer and two coats of Luster finished synthetic enamel. The cost shall include all materials, labour, accessories etc. complete strictly as per</p>	48.15	S.mt		
--	---	-------	------	--	--

**TENDER**  
**Bank of Baroda, Asset Recovery Management Branch (ARMB), Jabalpur**  
**Interior Furnishing, Electrical , and Air Conditioning Works**

	attached drawings specifications and manual standard under supervision of bank Architect. (Records)				
13	Providing & fixing at site 4” wide POP cornice molding at the existing ceiling corner all around the main banking hall with all finishing etc. complete strictly as per attached drawings specifications and manual standard under supervision of bank Architect. ( Refer- As per prescribed Manual by head office )	26.00	R.mt		
14	<p><b><u>PANTRY CABINET BELOW PLATFORM – GRANITE TOP :-</u></b></p> <p>Providing and fixing 750 mm High fully covered from all sides and 400 mm deep including necessary shelves as per the design and specifications with 18 mm thick Granite stone working top as approved colors and openable shutters made up of 18 mm plywood of BWP grade. The rear portion is to be closed with 6.0 mm BWP ply; Upper portion should have 150 mm height drawers &amp; Lower portion of cabinets moved on good quality drawer channels of ebco make or equivalents ( Modular ). The provision of drinking water tap make of “Jaguar” with all fittings at site. Front of the cabinet is to be finished with 1.0mm thick laminate and the inside portion is to be fixed with 0.80 mm thick white shade laminate. with Proper Teak wood beadings on edges as per the design, pattern, including all necessary fittings, such as locks, handles and opening panels or flap doors moved on SS finish “L” hinges. All the locks should be of Godrej make &amp; handle 100 mm long SS finished decorative handles at both panels. The cost shall include all materials, labour, accessories etc. complete.</p>	1	No’s		
15	<p><b><u>AGM &amp; IN CHARGE OFFICER TABLES WITH CREDENZA</u></b></p> <p>Providing and fixing at site 1820 ( L ) x 920 ( W ) x 760 (Ht) mm Officer’s table –</p>	2	Nos.		

**TENDER**

**Bank of Baroda, Asset Recovery Management Branch (ARMB), Jabalpur  
Interior Furnishing, Electrical , and Air Conditioning Works**

All exposed glass face to be machine polished. The table shall be made of 18MM commercial ply board, with 01 MM laminate as per drawing detail enclosed. The exposed side of Top shall be finished with 01 MM laminate as per drawing enclosed. The inside shall be French polished. The table shall be made of 18MM commercial ply board, with 01 MM laminate as per drawing detail enclosed.

**KOREAN:**

Polyacrylic 12mm thick stone (Plain White KORAEN) Providing and fixing (12mm thick) white polyacrylic stone (non-absorbent, non-porous solid surface composite material, belonging to the solid surface category) as per drawings/design complete in all respect including adhesives, buffing and cupboard below it having tea tray, sliding drawer unit (With sliding rails) make of (epco or hettich brand) , Provision is to be made for keeping CPU on trolley in inclined position beneath the table. The cost shall include Side credenza of site credenza as per drawings of size- 36” in length & 16” depth & 30” height with openable shutters fixed with bronze made hinges & godrej make locks with fully covered from all sides and 16” deep including necessary shelves as per the design and specifications with openable shutters made up of 18MM commercial ply board, with 01 MM laminate. The rear portion is to be closed with 8.0mm ply with approved pattern with Proper Teak wood molding, beadings, and different colour laminate as per pattern in shutters and in skirting strictly as per the design, pattern, including all necessary fittings, such as locks, handles. The inside portion is to be fixed with fevicol properly after one coat of wooden primer. The cost shall include all materials, labour, accessories etc. complete as per the design with front made up of 18MM commercial ply board, with 01 MM laminate openable shutters to be finished of approved shade with provision of keeping of computer with sliding keyboard as per design & specifications, all exposed surfaces to be finished with 1.0mm laminated finish and pattern of different colour laminate. The cost shall include all accessories

**TENDER**

**Bank of Baroda, Asset Recovery Management Branch (ARMB), Jabalpur  
Interior Furnishing, Electrical , and Air Conditioning Works**

	such as sliding rails, drawer locks etc. complete. The table is to be made with two different shades of laminate in skirting and design including all materials, labour etc. complete strictly as per the drawing. as per attached drawings specifications and manual standard under supervision of bank Architect.				
16	<p><b><u>OFFICER TABLES WITH SIDE CREDENZA</u></b> Providing &amp; fixing at site 1220 (LONG) x 600 (WIDTH) x 760 mm (h) Officers’s table All exposed glass face to be machine polished. The table shall be made of 18MM commercial ply board, with 01 MM laminate as per drawing detailenclosed. The exposed side of Top shall be finished with 01 MM laminate as perdrawing enclosed. The inside shall be French polished. The table shall be made of 18MM commercial ply board, with 01 MM laminate as per drawing detail enclosed.</p> <p><b>KOREAN:</b> Polyacrylic 12mm thick stone (Plain White KORAEN) Providing and fixing (12mmthick) white polyacrylic stone (non-absorbent, non-porous solid surface composite material, belonging to the solid surface category) as perdrawings/design complete in all respect including adhesives, buffing and cupboard below it having tea tray, sliding drawer unit (With sliding rails) make of (epco or hettich brand) , Provision is to be made for keeping CPU on trolley in inclined position beneath the table. The cost shall include Side credenza of site credenza as per drawings of size- 36” in length &amp; 16” depth &amp; 30” height with openable shutters fixed with bronze made hinges &amp; godrej make locks with fully covered from all sides and 16” deep including necessary shelves as per the design and specifications with openable shutters made up of 18MM commercial ply board, with 01 MM laminate. The rear portion is to be closed with 8.0mm ply with approved pattern with Proper Teak wood molding, beadings, and different colour laminate as per pattern in shutters and in skirting strictly as per the design, pattern, including all necessary fittings, such as locks, handles. The inside portion is to be fixed with fevicol properly after one</p>	14	Nos.		

**TENDER**

**Bank of Baroda, Asset Recovery Management Branch (ARMB), Jabalpur  
Interior Furnishing, Electrical , and Air Conditioning Works**

	<p>coat of wooden primer. The cost shall include all materials, labour, accessories etc. complete as per the design with front made up of 18MM commercial ply board, with 01 MM laminate openable shutters to be finished of approved shade with provision of keeping of computer with sliding keyboard as per design &amp; specifications, all exposed surfaces to be finished with 1.0mm laminated finish and pattern of different colour laminate. The cost shall include all accessories such as sliding rails, drawer locks etc. complete. The table is to be made with two different shades of laminate in skirting and design including all materials, labour etc. complete strictly as per the drawing. as per attached drawings specifications and manual standard under supervision of bank Architect.</p>				
17	<p><b><u>TRIPLE CHANNEL SLIDING WINDOWS</u></b></p> <p>Providing and fixing at site anodized coating aluminum section windows ( one with aluminium make mosquito net provisions ) to be made up approved shade aluminum sections and panel shall have 6 mm float glass. The external frame shall be of 100x50x2.0mm anodized aluminum Box section to be fixed in walls/ as per site with anchor fasterns and heavy duty mechanical screws. Inclusive of with standard aluminum clips to be made strictly as per the drawing. with 6 / 10 mm thick float glass, and approve arrangement, decorative type , all necessary fittings, all labor, materials, etc. complete.</p>	18.90	S.mt		
18	<p><b><u>MEETING TABLE :-</u></b></p> <p>( 1830 mm long x 1220 mm width x 760 Ht.) Providing &amp; fixing at site as per following specifications:- Polyacrylic 12mm thick stone (Plain White KORAEN) Providing and fixing (12mmthick) white polyacrylic stone (non-absorbent, non-porous solid surface composite material, belonging to the solid surface category) as perdrawings/design complete in all respect including adhesives, buffing etc. The Flat edges should be duly sealed with atleast 2 mm thick</p>	1	No's		



**TENDER**

**Bank of Baroda, Asset Recovery Management Branch (ARMB), Jabalpur  
Interior Furnishing, Electrical , and Air Conditioning Works**

	<p>PVC beading. For the corner half round table 2mm edge banded to be provided. The Edge profile should be Waterfall Edge with atleast 10mm radius on top edge and at least 5mm at bottom. Prelaminated particle Board (Interior grade) modesty panels with metal strip on all side, with levelers to take care of uneven floors. Wire Carrier: The Wire Carrier should be made from atleast 0.6mm thick CRCA (COLD ROLLED CLOSE ANNEALED), which should be painted with approved colour. Top of the table one nos of flip top box (epco or hettich brand) pop up box to be provided. while assembling cut out has to be taken as per the instructions of architect instructions. Understructure: The legs should be made from at least 25mm Plain Particle Board having a straight profile with half round edges and clad with at least 0.6mm thick Post Forming Laminate both side in same decor. The overall thickness of leg should be 26.2mm.(+/- 0.01mm) 6. Front Apron Panels: The Front apron panels should provide enough leg room and should be made from at least 18mm thick PLPB (Prelaminated particle board). Material To Be Used Substrate: The substrate should be made up of MDF of grade II as per IS 12406:2003. The PreLaminated Boards used should be of grade I Type II as per IS 12823:1990. As per attached drawings specifications and manual standard under supervision of bank Architect.</p>				
19	<p><b>DECORATIVE VENETIAN BLINDS FOR WINDOWS AT CIRCLE OFFICE AND CONFERENCE HALL</b> (8 windows):- Providing &amp; fixing of designer decorative blinds in Cloths for windows , make of Zebra or Deco. The rates shall inclusive of all material, labour, transportation complete.</p>	24.40	S.mt		
20	<p><b><u>DISPLAY BOARD-</u></b> Sizes- ( 1'-6" x 2'-0") Providing and supplying &amp; Fixed the Signage Board make of acrylic sandwich board in the standard RED &amp; BLUE format to display the to display the kind of sales and service support complete strictly as per attached drawings specifications and manual standard under supervision of bank Architect.</p>	4	No's		

**TENDER**

**Bank of Baroda, Asset Recovery Management Branch (ARMB), Jabalpur  
Interior Furnishing, Electrical , and Air Conditioning Works**

21	<p><b><u>ACP Shutter boxing with trap door –</u></b>                  Providing and Supplying at site in position 3mm thick ACP of approved colour &amp; make with framing of aluminum tube section of min. 2"x1" and 20 gauge 2'0"c/c both ways ACP to be in 2' width panels or distributed equally. Panel to be fixed to the frame with adhesive / mirror screws.joints to be finished with silicon based sealant. trap door will be 12mm thick ply finished with ACP etc. complete as per approved shade. complete strictly as per attached drawings specifications and manual standard under supervision of bank Architect.</p>	10.10	S.mt		
22	<p><b><u>FRONT ENTRY DISPLAY WITH LOGO: AS PER DRAWING AND FRONT VIEW (10'-9" LONG X 9' HEIGHT)</u></b>                  Supplying and erecting Full height partitions (upto max. 2800 mm. high ) as per drawing and conforming to the following specifications :  <u>basic frame work</u> :                  teak wood frame work sections, treated with two coats of wood preservatives, 75 mm finished at 600 mm horizontal or vertical spacing as per site conditions.  <u>skin membrane</u> :                  6 mm thick BWR grade plywood on each face, with grooves formed as per drawing/instruction.  <u>finishing</u> :                  3.0 mm thick laminate sheet of same or combination shades as per instructions.  <u>edge moulds</u> :                  All free top/end surfaces shall have polished teak wood skirting with NC lacquer finish.  <b><u>Note:-The ply, boards, laminates should be make of Green/Century/ Duro )</u></b></p>	9.00	S.mt		
23	<p>Providing and fixing at site decorative planter of 750 mm dia as per drawing in 19 mm thick BWP ply finished with 1.0 mm thick steel finished laminate of approved color standard make excluding cost of artificial plants. But including the G.I Trough, sand and marble stone pieces etc. complete strictly. With provision of different color of laminates skirting/ design.</p>	6	No's		
			<b>A</b>	<b>TOTAL</b>	

**TENDER**  
**Bank of Baroda, Asset Recovery Management Branch (ARMB), Jabalpur**  
**Interior Furnishing, Electrical , and Air Conditioning Works**

<b>CIVIL WORKS</b>					
1	<p><b><u>PLASTIC EMULSION PAINTING</u></b>  <b><u>(Records room, pantry , UPS, ots, both toilet surface area including gypsum ceiling area)</u></b></p> <p>Providing and applying plastic emulsion /luster paint to wall and ceiling surface.</p> <p>The existing surface to be scrapped out and the new surface shall be prepared with Birla putty to make the surface in line and level.Two coats of primer to be applied to the prepared surface. Finally the surface to be finished with three coats of plastic emulsion /luster paint (in white color) on wall and ceiling. The rate shall include scrapping, leveling &amp; preparing the surface. Primer coat + (minimum) 2 coats to get evenly spread quality finish (roller finish) of approved make, quality &amp; finish shall be provided.</p> <p>The cost shall include all materials, labour etc. complete. (Area All four side Walls) complete strictly as per attached drawings specifications and manual standard under supervision of bank Architect.</p>	195.00	S.mt .		
2	<p><b>ENEMAL PAINT</b></p> <p>Applying one or two coat of Enamel paint on steel , iron made door, window, and main gate channel with shutter with premier properly sand papered to gives neat smooth &amp; silk finish, the cost shall include all materials, labour etc. complete.</p>	145.00	S.mt .		
3	<p>Providing, supplying &amp; applying the anti-termite treatment in three coats of approved ISI product with all repairing work with cement mortar in 1:6 ratio if any. The anti termite treatment should be applying after rubbing the existing surfaces at all walls &amp; ceilings complete in all respect</p>	234.00	S.mt .		
4	<p>Providing &amp; Fixing Vitrified tiles flooring in entire area of approved make and colour with border and design in approved colour as required 2mm thk. 605 x 605 mm size over a 1:3 cement mortar bedding of 20mm thick. Including filling of colour cement joint,</p>	128.0	S.mt .		

**TENDER**  
**Bank of Baroda, Asset Recovery Management Branch (ARMB), Jabalpur**  
**Interior Furnishing, Electrical , and Air Conditioning Works**

	levelling and cleaning the same after completion of work. Make of grade-1, kajariya or Somany brand completion in all manner.				
5	New toilet ( male, female and UPS ) construction- 4” thick brick wall including both side plaster – New dado tiling to the wall of ceramic tiles (8”x8”) make of Nitko or kajariya (28.00 S.mtr) , Anti skid floor tiling ( 16.00 s.mtr) , 3 No’s ventilators of MS Square bars, ( 2’x 1’-3”) Uropian WC ( 2 no’s ) ,1no’s Urinal & 2 no’s of 12” Wash basin make of Johnson and Johnson with all concealed upvc pipes & 4 TAPS of jaguar make with all fittings and fixtures as approved by bank as per CPWD SOR. ( Please refer drawings)	1	Job		
			<b>B</b>	<b>TOTAL</b>	
		<b>A+B</b>		<b>TOTAL</b>	
	<b>Add 18% GST</b>				

**GRAND TOTAL ( A+B) =**

Date:-

Place:-

Signature with Rubber Stamp of Contractor

**TENDER**

**Bank of Baroda, Asset Recovery Management Branch (ARMB), Jabalpur  
Interior Furnishing, Electrical , and Air Conditioning Works**

**Bill of Quantities of Electrical Work of Bank of Baroda ,  
Asset Recovery Management Branch (ARMB) Jabalpur  
Block No-10, 2<sup>nd</sup> Floor, JDA Building, Civic Centre, Marhatal, Jabalpur (M.P.) 482002**

<b>ELECTRIC WORK</b>					
<b>SUB HEAD : 01 : INTERNAL WIRING</b>					
1	<b>POINT WIRING :</b> The rates for the point wiring shall include providing and fixing of following : <ul style="list-style-type: none"><li>a. Wiring of the point of any length from distribution board to point outlet including m.s. conduit with 1.5 sqmm Standard copper conductor PVC insulated.</li><li>b. Earthing of all switch box and all outlet boxes fitting.</li><li>3<sup>rd</sup> Pin plug with 1.60mm *16 gauge) copper wire.</li><li>c. Modular switch / sockets of Standard make with necessary modular series cover plate and MS Boxes</li><li>d. Embedding all conduits in walls, laying in slabs, false ceiling or in floors including all accessories cutting and refilling the chase with cement mortar.</li><li>e. This includes sub main wiring.</li><li>f. Providing, fixing, switches, sockets, M.S. boxes (1.6mm thick) draw boxes, G.I. Pull wires (where required). brass screws, ceiling rose / connector etc.</li><li>g. Adopting separate and independent system of wiring for lighting, power (normal and essential supply). Wiring for following points using PVC insulated copper conductor wires of 850V/1100 V grade in 16 SWG M.S. conduit concealed/ exposed including switches &amp; sockets as above.</li><li>h. Providing wiring (supply, fixing testing &amp; commissioning etc.) for light point / fan point/ exhaust fan point / call bell point etc. with 1.5 sqmm copper conductor PVC insulate in recessed / surface 16 swg stove enameled steel conduit, with accessories, modular switches ceiling rose, bulb holders etc. fitted in standard concealed sheet steel boxes including 1.5 Sqmm PV insulated</li></ul>	94	Nos.		

**TENDER**  
**Bank of Baroda, Asset Recovery Management Branch (ARMB), Jabalpur**  
**Interior Furnishing, Electrical , and Air Conditioning Works**

	copper earth wire etc. complete as required (Wire colors red, black, green) (This Item specially used for light point. fan point. Exhaust point etc) 1.1. Providing and fixing one light point controlled by one switch including fan point with stepped regulator.				
2	Supply, fixing, testing & commissioning of 2 sets of 3 pin PIN 6 Amp. socket with switch (modular type) on separate board fitted in concealed sheet steel boxes with 1.5sqm PVC insulated Copper wire (For UPS output)- (Apart from the normal UPS Points and data points additional UPS Power Point + data Point have to be provided for Automation)- 10+10=20	20	Nos		
3(a)	Supply & fixing of 32 Amp Metal socket with 32 Amp SPMCB with 4.0 sqmm PVC insulated copper wire for individual AC point all labors, materials etc. complete.	7	No's		
3(b)	Providing, supplying and installation the concealed 25mm dia Drain pipe from AC unit inside to branch to the outdoor of premises as instructions by Architect – Make Finolax of drain pipe etc.	116	R.mtr.		
4	Supplying and laying of Extra copper refrigerant piping with nitrile rubber pipe insulation, both of size as specified by the manufacturer suitable for 1.0 TR/ 1.5/2.0 TR Split type AC and 2.0/3.0 TR Cassette AC (From Indoor to outdoor Units) Beyond 10 M.				
4.1	For 1.0 TR & 2.0 T Split unit – from main unit to outdoor unit.	86	R.mtr.		
5	Suitable IS/BIS standard Cable of 1.1-2.2 KV, Multi strand, FRLS 2- 4 C / 1.5/2.5 -6.0 Sqmm) as per design requirement of Peak load calculation of specific ACs system installed at site with 1”/1/2”/2” PVC conduit pipe between indoor/outdoor unit				
5.1	Supplying and laying of Extra Electrical interconnecting control cable from indoor to outdoor of size as specified by the manufacturer suitable for 1.0 TR/ 1.5/2.0 TR Split type AC.	110	R.mtr		
6	<b>Air Conditioning Works - AC installation 1.0 TR/ 1.5/2.0 TR Split type AC (Shifting)</b>	7	No's		

**TENDER**

**Bank of Baroda, Asset Recovery Management Branch (ARMB), Jabalpur  
Interior Furnishing, Electrical , and Air Conditioning Works**

7	<b>AUTOMATIC VOLTAGE CONTROLLER</b> Stabilizer shall be Automatic version with copper coil transformer and the voltage selection range shall be minimum depending on lowest peak recorded average in a month. Precise output voltage range (130V-170V to 240V -270 V). Ensure the rating of Stabilizer shall be in accordance with max rated power of ACs considering instantaneous peak load fluctuation. Providing and fixing 5 KVA Stabilizer with 3-4 step relay and input voltage range of 130-270 V and output to be 230-240 V (Blue bird/ Logic state/ Inline/ V-Gaurd/Equivalent Reputed Make) (copper winding).	7	No's		
8	<b>MS-STAND (POWDER COATED)</b> Providing and fixing of lockable caging for outdoor unit grouted on wall or on roof with open able shutter made of 10 X 10 mm MS square bars placed vertically @ 5" c/c welded with 40 X 3 mm MS flat all- round. The frame shall be of angle 35mm*35mm and it shall be fixed to wall or roof with proper MS bracket to tackle the weight of outdoor unit. Item includes all necessary hardware, priming coat, synthetic enamel paint, hanger, clamps other accessories etc. All complete as per approval and instructions of the employer. Size shall be adequate for AC outdoor size & sufficient space around the outdoor suitable for servicing purpose for Outdoor unit.	7	No's		
<b>SUB HEAD 02: MAINS &amp; DISTRIBUTION SYSTEM</b>					
9	<b><u>U.P.S. DISTRIBUTION BOARD FOR OUTGOING SUPPLY-</u></b> Supply, Installation, Testing and commissioning of the surface / recess mounting following way Double door MCB D.B. Single phase distribution board (Consumer unit) for single phase out going with IP 422 protection incl. UPS of make Luminous/ Numeric/ Switching Electronics or Equivalent. Batteries of Yuasa/ Panasonic/Exide/AVO or equivalent. (For 3 KVA	1	No		

**TENDER**  
**Bank of Baroda, Asset Recovery Management Branch (ARMB), Jabalpur**  
**Interior Furnishing, Electrical , and Air Conditioning Works**

	UPS with batteries mounted on MSFrame.) The followings accessories – a) 1 No. SPN MCB DB 12 way b) 1 No. 25 amp DP MCB c) 10 Nos. SP MCB 6 amp. Including Electrical connection, earthing, making good all the damages, painting, cleaning the site, etc. complete as per site requirement and as directed.				
10	Supply & fixing 40 A TPN MCB with enclosure for UPS Incomer	1	No.		
11	<b><u>DISTRIBUTION BOARD &amp; MAIN BOARD</u></b> a) Supplying, fixing in position, testing and commissioning of following type of 1.6mm thick sheet steel enclosed wall mounted dust and vermin proof, factory fabricated from b) MCB manufacturers indoor type distribution board with hinged cover (double door) with locking arrangement with copper phase bus, neutral and earth bars complete as required suitable for use at 3 phase 440 V/single phase 250V 50c/s supply.				
	<b>INCOMER</b>				
11.1	1 Nos. MCCB 100 Amp. 100 A TPN insulated Aluminum Bus Bar 1 Set+100A TPN A1 bus bar no on load c/ SW 100A 2 Nos. MCB 63A(TPN) 2 No. MCB 40A (TPN)	1	No		
11.2	LDB (4x4 TPDB – double door) I/C 63 A( ) O/G SP-7 Nos. 10 A, SP-5 Nos-32 A SET AS ABOVE	1	No.		
12	<b>POWER CABLE</b> Supply, laying, testing and commissioning of the following 110 Volt grade L.T. A1 Conductor armored cable inner and outer sheathed along with the two ton of G.I. Earth wire etc. i/c termination at both ends. (This item specially used for main panel to UPS.) A. under ground The excavation of trench shall be of size 30 cm				



**TENDER**

**Bank of Baroda, Asset Recovery Management Branch (ARMB), Jabalpur  
Interior Furnishing, Electrical , and Air Conditioning Works**

	(w) x 85 cm (d) in all type of soil / murum / rock/ concrete / etc. And laying cable on a bedding of minimum 7.5 cm riddled soil or sand at the bottom of the trench and covering it with additional riddled soil or sand of minimum 7.5 cm and protecting it by means of tiles / second class brick ( no in one meter) or slabs Back filling.				
	B. On surface S/Fixing the cable on wall / column / beam / ceiling/ above false ceiling / existing trench etc. incl. S/f of saddles/ spacers (wherever required as per site conditions) and two run of G.I. Earth wire along with the cable, making good all the damages, i/c termination at both ends.				
12.1	a) 3.5C x 16 sqmm (with 08 SWG G.I. Wire)	87	m		
12.2	b) 3.5C x 25 sqmm (with 08 SWG G.I. Wire)	61	m		
12.3	c) 3.5C x 10 sqmm (with 08 SWG G.I. Wire)	94	m		
	i) Suitable for 15 -20 kilowatt loaded branch Electricity Board to main meter box. Main meter Box to main panel. ii) suitable for 25 kilowatt to 30 kilowatt loaded branch				
<b>EARTHING</b>					
13	CHEMICAL EARTH STATION ( One for branch electrical work & One for UPS system ):- Installation, Testing , commissioning of CHEMICAL EARTH STATION Based on Earthing Electrode with inbuilt copper strip/GEL/GAF based. Should have resistance < 1 Ohm and should be < 2V between neutral and earth. Suitable electrode be used as per the site requirements. Earth enhanced compound powder (Gel) with hardener to be provided minimum 20Kg per site/ Back Fill/Site Filled compound (BFC/BSC)- 100 Kg. Earthing Warranty for 5 years. The electrode should be minimum 60mm dia and 3 Meter length or 80mm dia and 2 Meter length. Dedicated earthing for computer systems, with all respect as per your required specification.				
13.1	Included to above item - Construction of earth pit chamber incl. Necessary brickwork, concrete, plastering S/F of CI cover of size 12" x 12" complete as per drawing (enclosed herewith)	2	No		

**TENDER**  
**Bank of Baroda, Asset Recovery Management Branch (ARMB), Jabalpur**  
**Interior Furnishing, Electrical , and Air Conditioning Works**

13.2	Included to above item no-8- Providing and fixing 2 X 8 SWG dia. Cu earth wire in PVC conduit on surface or in recess for loop earthing along with the existing surface/ recess cable as required.	61	Mt.		
13.3	Included to above item no-8- Supplying and laying 25 x 3mm copper strip direct on wall / in ground with screws and washer including soldering / welding com.	69	Mt.		
<b>SUB HEAD 03 : TELEPHONE SYSTEM</b>					
14	Supplying lying / fixing of the following rigid PVC non metallic conduit 1.6 mm wall thickness of approved make on surface (wall/column/beam/ceiling etc.)/ in concealed manner i/c with all m.s. accessories like bends tees, junction boxes etc. including necessary breaking and cementing the flow if required, completed as required Supplying, drawing, testing and commissioning of 0.61 mm dia Telephone cable tinned copper conductor, P.V.C. insulated and sheathed, fire retarding, anti termite, color-code twisted Paris and rip cord in existing pipe/trench/tray/ beam/column/floor etc. with all necessary materials i/c connect connections, identification by numbering.				
14.1	Supply and fixing of modular type Telephone Outlets (RJ – 11) with suitable size M.S./PVC modular boxes complete as required along with double outlet with shutter.	2	No.		
14.2	Supplying and fixing of crone type telephone tag block, suitable for the multi core telephone cable and shall accommodate tin-plated phosphor bronze connectors, the connectors shall splice buskined cables up to 0.61 mm dia and shall be terminate both inc. incoming and outgoing lines. the tab blocks shall be mounted inside, fabricated 15 swg G.I. Box of suitable size with removable hinged covers and locking arrangement and shall be fully accessible. The item is inclusive of providing and fixing of G.I. box boxes in surface / recessed system etc. as required complete a) 20 pair tag thick.	2	No		

**TENDER**  
**Bank of Baroda, Asset Recovery Management Branch (ARMB), Jabalpur**  
**Interior Furnishing, Electrical , and Air Conditioning Works**

<b>SUB HEAD 04: COMPUTERS NETWORKING</b>					
15	a) Wiring for computer networking from Jack Panel in data rack to computer workstation with Cat-6 computer cable in PVC conduits of size 20/ 25 mm including providing ferrules at both ends and termination at both ends including providing & fixing frame for Cat-6 with shutter, RJ 45 outlet, faceplate and mounting box complete of modular type, This work includes supply and laying of CAT-6 cable in PVC conduits throughout the length, from the I/O hub to the point.				
	b) One Port along with supplying, laying/fixing of the following rigid PVC non metallic conduit 1.6mm wall thickness of approved make on surface (wall/ column / beam/ceiling etc.) in concealed manner including all accessories like bends, tees, junction boxes etc. including necessary breaking and cementing the floor if required, complete as required. <b>( 15 a+ 15 b)</b>	18	Nos.		
15.1	Supplying and fixing 9 U (Rack with glass door, opening in the front power panel 1 (horizontal), cable manager 1 lock & key).	1	No's		
15.2	Supplying and fixing Patch Cord-2 Meter- (DBPS Mounting Cord)	1	No's		
15.3	Supplying and fixing Patch Cord-1 Meter	1	No's		
15.4	Supply and fixing of 1.6 mm thick G.I. Box along with RG 6 T.V Co axial socket with Cover Plate.	1	No's		
15.5	Testing of UTP cabling with scanner for all the nodes.	1	Job		
15.6	Providing & fixing to the new premises the Signage new wiring of 3x4mm & copper flexible wire & PVC conducting of ISI ,Havells, or Finolex make complete with all accessories like saddles, bends etc.	No's	Per Job		

**TENDER**  
**Bank of Baroda, Asset Recovery Management Branch (ARMB), Jabalpur**  
**Interior Furnishing, Electrical , and Air Conditioning Works**

<b>SUB HEAD 05 : FITTINGS</b>					
16	<b>ELECTRICAL AND LED FITTINGS</b>				
16.1	Supply, laying, testing and commissioning of Recessed mounting mirror optics luminaries LED ( 36 Watt ) of Wipro/Bajaj/Crompton /Philips complete with its electronic driver fittings etc in all manner - size- mm- 2'x2" including fixing & as per all respect etc.	20	Nos		
17.	Supply, fixing, testing and commissioning of 18 Watt round natural white LED down lighter inclusive of enclosed control gear box, matt finish reflector and die cast aluminum ring make of Wipro/Bajaj/Crompton /Philips complete in all manner	19	Nos		
18	Supply and fixing of 450 mm dia METAL energy saving wall mounted fan completed in all respect make of Orient / Crompton greaves / Philips including fixing & as per all respect etc.	21	Nos.		
19	Supply and fixing of LED ( T-5) 20 W tube 4'-0" make of Crompton greaves Wipro/Bajaj/Crompton /Philips make,	10	No's		
20	Supply and fixing of the 300 mm METAL Blade exhaust fan of Crompton greaves / Philips make, including making hole in the wall for fixing and making up for the civil damages etc. as required. including fixing & as per all respect etc.	3	Nos.		
		<b>A</b>		<b>TOTAL</b>	
	<b>Add 18% GST</b>	<b>B</b>			

**GRAND TOTAL = A+B =**

Date:-

Place:-

Signature with Rubber Stamp of Contractor

**TENDER**  
**Bank of Baroda, Asset Recovery Management Branch (ARMB), Jabalpur**  
**Interior Furnishing, Electrical, and Air Conditioning Works**

**INTERIOR FURNISHING DRAWING**

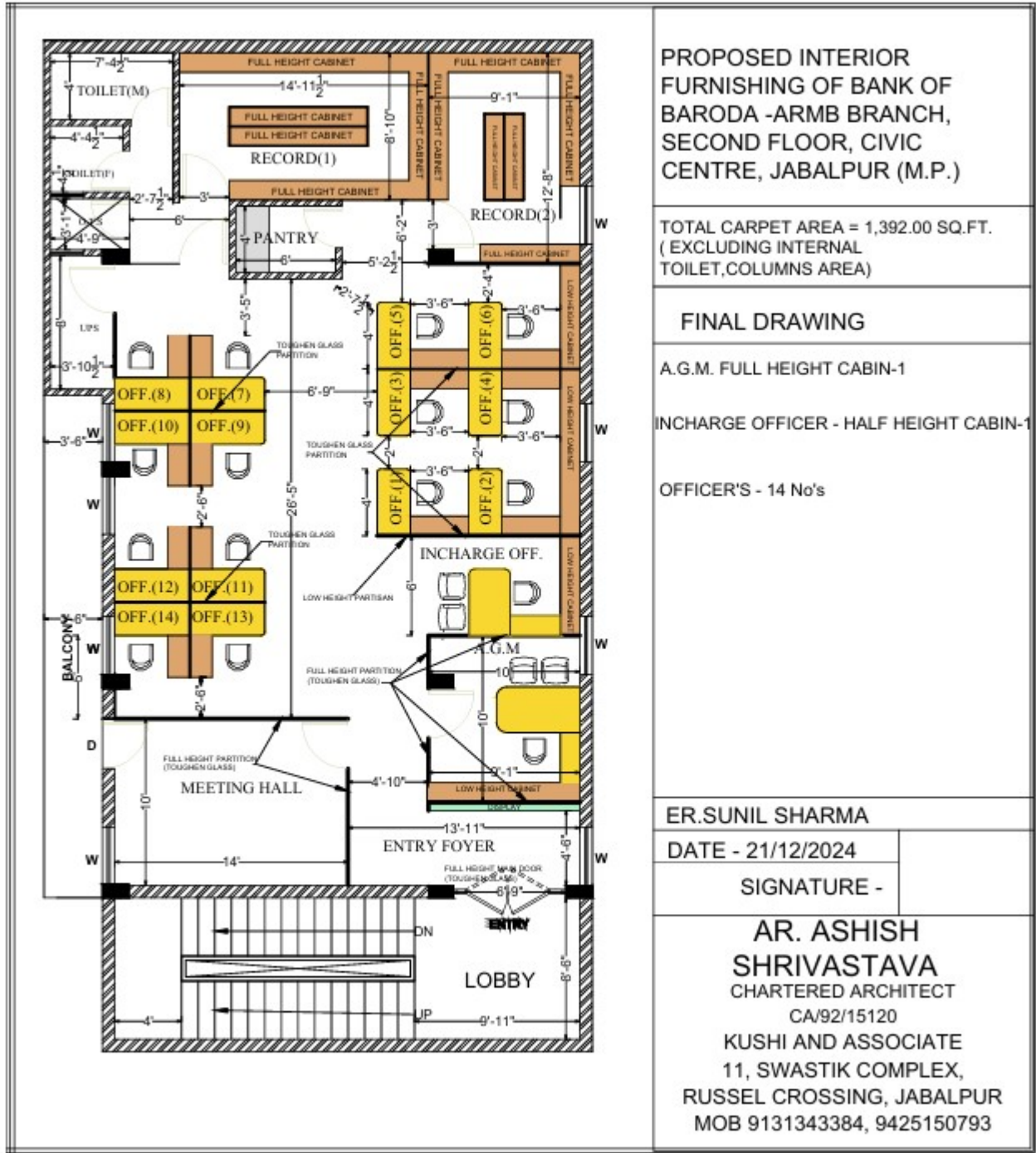

**TENDER**  
**Bank of Baroda, Asset Recovery Management Branch (ARMB), Jabalpur**  
**Interior Furnishing, Electrical, and Air Conditioning Works**

**FALSE CEILING DRAWING**

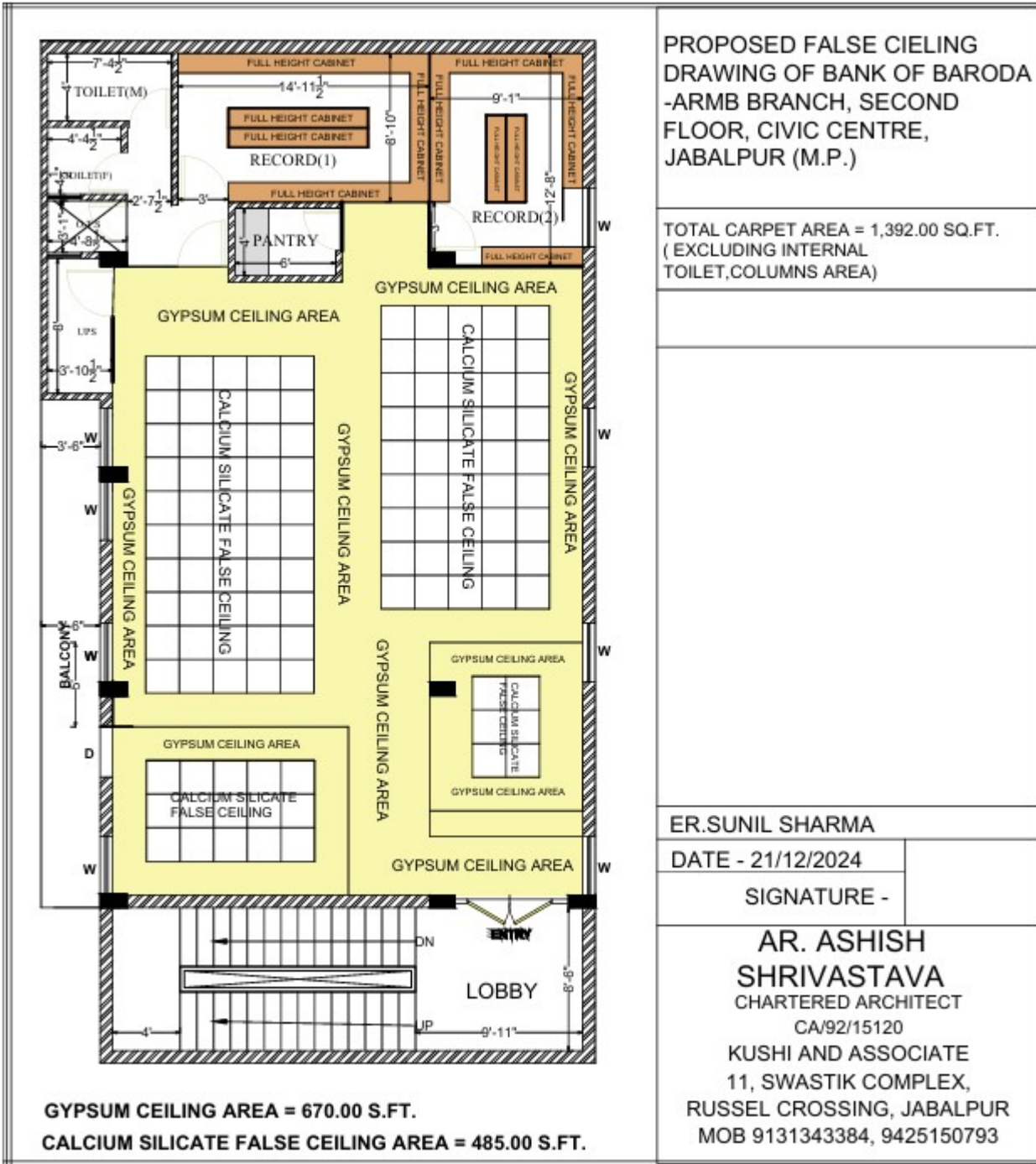

**TENDER**  
**Bank of Baroda, Asset Recovery Management Branch (ARMB), Jabalpur**  
**Interior Furnishing, Electrical , and Air Conditioning Works**

**ELECTRICAL AND AC LAYOUT DRAWINGS**

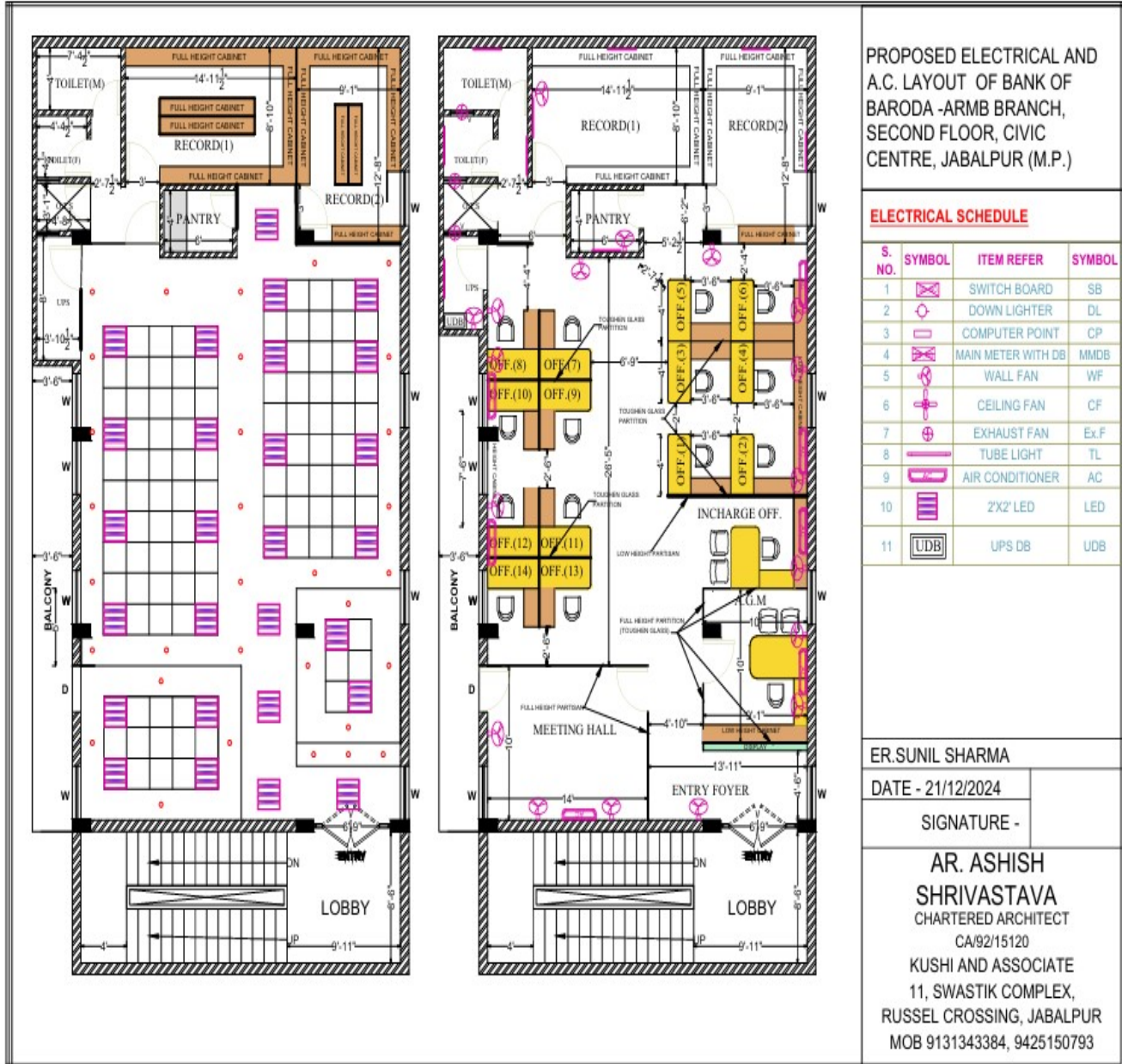

**TENDER**  
**Bank of Baroda, Asset Recovery Management Branch (ARMB), Jabalpur**  
**Interior Furnishing, Electrical , and Air Conditioning Works**

**MAIN ENTRY LOBBY VIEW**





**TENDER**  
**Bank of Baroda, Asset Recovery Management Branch (ARMB), Jabalpur**  
**Interior Furnishing, Electrical , and Air Conditioning Works**

**VIEW FROM PANTRY AREA**



**TENDER**  
**Bank of Baroda, Asset Recovery Management Branch (ARMB), Jabalpur**  
**Interior Furnishing, Electrical , and Air Conditioning Works**

**VIEW FROM MEETING HALL**

