



बैंक ऑफ़ बड़ौदा *Bank of Baroda*



**BANK OF BARODA
REGIONAL OFFICE, CUTTACK**

**TENDER DOCUMENT
FOR
ELCTRICAL, LAN DATA CABLING WORKS OF JAGATPUR BRANCH.**

NAME OF THE TENDERER:

ADDRESS OF THE TENDERER:

DATE OF TENDER PUBLISH: From **17.02.2025 to 03.03.2025**

DATE OF SUBMISSION OF TENDER: **03.03.2025 upto 3.00 PM**

DATE OF OPENING OF TENDER: **03.03.2025 at 3.30 PM**

PLACE OF SUBMISSION OF TENDER:
THE REGIONAL MANAGER
BANK OF BARODA,
REGIONAL OFFICE,
CUTTACK

CONSULTANT

**M/s. CURVES ARCHITECTURE
Plot no- 33, Bankers Enclave,
Palasuni, Bhubaneswar
Mobile - 9438562471**

TENDER NOTICE

Sealed Tenders are invited from the Electrical Contractors having current IT clearance, GSTIN. & valid electrical contractor license. Having experience of similar nature works, and not involve any Civil Suits / Litigations aroused during execution of the contracts in the last 5 years for the following works:-

- 1) Name of the work : Electrical, Data cabling work of
JAGATPUR BRANCH
- 2) Location of the work : JAGATPUR,CUTTACK
- 3) Tender documents should be down loaded from bank website.
- 4) Time of completion : 15 Days
- 5) Earnest money : Rs. 5000.00
- 6) Cost of Tender documents : NIL
- 7) Defect liability period : 1 year after actual completion of work
(i.e issue of completion certificate)
- 8) Initial Security Deposit : 2 % of executed value of work.
- 9) Retention Money : 10% of gross value of each Bill.
- 10) Liquidate damage : 1.0 % of the tender value per week
Subject to Maximum 10% of the tender value.
- 11) Eligibility/Pre-qualification of Contractors: Experience of having successfully completed similar works during last 7 years ending last day of the month previous to the one which applications are invited should be either of the
 - a. 3 similar completed works costing not less than the amount equal to 40% of the estimated cost. OR,
 - b. 2 similar completed works costing not less than the amount equal to 50% of the estimated cost
 - c. 1 similar completed works costing not less than the amount equal to 80% of the estimated cost
- 12) Tenderers might be called upon before the final awarding of contract for any clarifications regarding the quoting of the tenders
- 13) The Earnest money shall be refunded to the unsuccessful tenderers within fifteen days without any interest.
- 14) The employer will not be bound to accept the lowest tender and reserves the right to reject any or all tenders without assigning any reason thereof.
- 15) Tenderer must have our Bank empanelment letter with class higher than work value estimated from Patna Zone only and company must be from Odisha only.**

For & on behalf of
BANK OF BARODA
REGIONAL OFFICE, CUTTACK.

DOCUMENTS FURNISHED BY THE TENDERER.

Tender should be submitted in single bid system only.

Note:Composite tender will not be entertained.

ENVELOPE CONTENT DETAIL.

Envelope shall contain the following documents.

- 1) Forwarding letter with mentioning the cost of Tender value arrived at with quoted rates & tender paper technical volume.
- 2) Earnest money deposit furnished in the form of Crossed Demand Draft/ Banker's Cheque drawn in favor of BANK OF BARODA and payable at CUTTACK for the amount indicated in the Notice of Invitation to Tender.
- 3) Bank's empanelment letter from Patna Zone only
- 4) Valid Electrical contractor license (HT / MV) having experience of similar nature for the works. In case of third party license, authorization from the license holder on the stamped paper duly Notarized must be submitted.

(Bank has the right to verify the documents with originals at the time of opening of tender)
- 5) Work order / Completion certificate as per eligibility of similar works done during last seven years .The tender will be rejected if all the documents above said are absent.
- 6) Any comment which the tenderer desires to make in the form of a statement as brief as possible and with reference to the items.
- 7) This envelope shall be endorsed on the outside face **“TENDER FOR ELECTRICAL, LAN DATA WORK OF BANK OF BARODA JAGATPUR BRANCH”**

बैंक ऑफ बरोडा
Bank of Baroda

GENERAL INSTRUCTIONS TO TENDERERS

- 1) The term “**Employers**” or “**Bank**” shall mean “**BANK OF BARODA**”, or its authorized representatives at The Regional Office, CUTTACK.
- 2) The term “**Architect(s)**” shall mean “**M/s Curves Architecture**. Who are the Architect Consultant to the Employer for this project & having office at Plot, 33, Bankers Enclave, Palasuni, Bhubaneswar? or its authorized representatives.
- 3) The term “**Contractor**” shall mean the **successful tenderer** to whom the Contract shall be awarded.
- 4) The “**Works**” shall mean the Electrical, data cabling works at JAGATPUR **Branch**.
- 5) The Contractor should quote the rates in figures and words. Any corrections or Over-writing should be initialed/signed by the Contractor.
- 6) The Contractor should submit the tenders with seal and signature on each Page.
- 7) Tender should be submitted in sealed covers with all requisite documents as desired with the top of the envelope superscribed as “**SEALED TENDER for Total Electrical, LAN data cabling works for JAGATPUR Branch**.”
- 8) The Contractors should submit the cost of the main items as per tender specifications. Further modification after awarding of the contract shall be not allowed unless there is specific instruction by the Bank/Architect to change specifications.
- 9) The contract is time-bound and the works are to be completed within the time limit specified in the notice inviting tenders.
- 10) Additional Performance Security shall be deposited by the successful bidder when the bid amount is seriously unbalanced i.e. less than the estimated cost by more than 15%. In such an event, the successful bidder will deposit the additional performance security to the extent of the differential cost of the bid amount & 85% of the estimated cost. (***Additional Performance Security = 85% of the Estimated Cost – Bid Amount***)
- 11) Additional Performance Security shall be deposited by the successful bidder when the bid amount is front loaded i.e. if the quoted value is 15% higher than the estimated rates, the bid shall be evaluated as unbalanced bid and additional performance security of 10% shall be retained on the amount of quoted value.
- 12) The additional performance security as per clause 10 & 11 shall be furnished by the bidder before execution of the work in shape of Demand Draft or Fixed Deposit Receipt at any Nationalised bank pledged in favour of **Bank of Baroda, CUTTACK** which will be over and above the security deposit and EMD.. ***The additional Performance Security must be pledged within 5 days of opening of the tender or else the tender will be cancelled and the EMD of the contractor will be forfeited.***
- 13) The Contractor shall be penalized if the work is not completed within the scheduled time, the Bank will be entitled to charge liquidated damages @ 1% of the accepted contract sum per week, subject to a maximum of 10% of the accepted contract sum.
- 14) The decision of Employer and the Architect is final and binding.

TERMS & CONDITION

- 1) Unless otherwise mentioned, all works are with no allowance for Lapse waste. Unless otherwise described or measured separately, price for all the items shall include all necessary straight & curved edges.
- 2) Any damage to the work before the site is handed over, is to be replaced or made good at the expense of the contractor to the entire satisfaction of the Architect/Bank.
- 3) Income Tax as applicable shall be deducted at source as per the Income Tax Act/Rules.
- 4) The quantities indicated are subject to change. The payment of the bill shall be made as per the actual measurement as certified by the architect but not exceeding the total value quoted in the tender form.
- 5) The Architect or any officer of the Employers will be free to inspect the work at the site during the period of execution. Any suggestion of change or modification to improve the quality of work will be carried out subject to prior approval of the competent authority of the employers and that of the Architect.
- 6) In case of failure to take up the work even after accepting the work order, or leaving the work incomplete, or for defective work not rectified, or violation of the terms and conditions, the earnest money deposit will be forfeited.
- 7) For any item of work not covered or any unforeseen items of work, payment will be made according to the rates approved for similar nature of work, the costing done by the Architect, as per current PWD schedule of rates, or as per analysis of material cost, labour rate and profit to the Contractor at 10%. The Contractor must obtain prior approval in writing before undertaking such additional works.
- 8) The tenderers shall sign each & every page of the tender documents including the drawings attached here to.
- 9) The amount is to be quoted in figures as well as in words. In case the rates quoted in words and in figures are in variance, the amount written in words shall be taken as final.
- 10) The Contractor shall make their own arrangement at their own cost for storing materials, plants, tools etc. The employers will not be liable for security of the Contractor's materials.
- 11) No tools or plants will be issued by the bank.
- 12) The Employer / Architect reserves the right to accept or reject any tender without assigning any reason whatsoever and the said decision shall be final and binding upon the tenderer.
- 13) In case of breach of contract by the Contractor for slow progress of works or any other claim of damage, the Employer or the Architect may have the power to rescind the contract without furnishing further reasons thereof.
- 14) The Architect/ Employer shall have the power to ask the contractor to furnish the sample/ color / test certificate from any Govt. /Authorized agent for any materials used/ to be used in the Works, the expenditure of which is to be borne by the Contractor.
- 15) The Employer shall be not be liable for any damages or compensation payable as a consequence of any accident or injury to any workman or other persons in the employment of the Contractor or any sub-contractor.
- 16) On completion of the Works, all rubbish, debris, materials, tools, Laborers, etc. to be removed by the contractor from the site and the contractor will hand over the site clean & clear & in usable condition within 3 days of completion of the works. Failing this, the employer may dispose the materials at the cost of the contractor.
- 17) In case of any dispute, the matter will be referred to the **Regional Manager, Bank of Baroda Regional Office, CUTTACK.**
- 18) The Contractor shall not submit any work bill until he completes the Project completely, as certified by the Architect Consultant.
- 19) The rates quoted in the tender shall exclude GST but include other taxes, no escalation of rates will be allowed under any circumstances.

SPECIAL TERMS AND CONDITIONS

1. Completion Period : 15 Days
2. Date of Commencement : 2 days from the date of issue of the work order or the date on which the contractor is instructed to take possession of the site, or the date of your acceptance of the work- order, whichever is later?
3. Defect Liability Period : One year after actual completion of work.
4. Initial security deposit (ISD) : 2 % of accepted value (Including EMD).
5. Limit of variation : 100% without any change in price if work is done within six months of the contract and with prior consent of Architect / Consultant.
6. Additional items : For items where unit rates are not available, contractor shall provide proper cost break-up and proceed only after approval/consent. Any sample to be made for approval shall be at the Contractor's cost.
7. Validity of tender : Three month after the opening of the tender.
8. Rules/ Regulations : The contractor shall have there responsibility of complying with the local shops/establishments Act and other labor/ minimum wages Act and shall keep all such records/ accounts on payment of wages / attendance as deemed necessary. 9. Arbitration As per the standard arbitration clause Under the jurisdiction of Odisha.
10. Organization : The contractor shall employ competent / qualified supervisor /Engineer-in-charge who shall be responsible for the day to day work and coordinate as necessary with the Architect's supervisor. Any workman found guilty of misconduct/theft shall removed from the site.
11. Damage to property : Any damage to the Bank's property during the work period will be recovered from the contractor.
12. Deduction : Income tax at source as per Act.
13. Terms of payment : 100% Payment after completion of Project.
14. Billing Procedure : All measurements shall be recorded in Duplicate on standard measurement sheets Prepared jointly by the Architect's Site Engineer & The Contractor's Representatives duly signed by them. All Bills shall be submitted along with this Checked measurement sheets.
15. Time schedule of work : The Contractor must submit before the Commencement of work, a Bar chart showing the date of commencement & the date of completion of each item of Work as mentioned in the Schedule of Quantities.
- 16) Release of TSD : 100% after the Defect liability period. Retention money will not bear any interest.
17. General : The rates should be quoted considering necessary Scaffolding & staging work, Removal of debris as & when necessary, In view of restriction of Local concern Authority.

LIST OF MATERIALS (ELECTRICAL & DATA WORK)

01. 11 KV (UE) 3 Core, ZLPE : CCI/INCAB/RETCO.
armoured cable (ISI marked).
02. 11 KV cable termination. : INCAB/ CCI/M-SEAL.
03. 100/500 KVA, 11/0.433 KV : OEU/KT PVT. LTD./KEO/ALPHA.
DYN-II, 0NAN Type cooling.
04. LT switch board panel. : L&T / MDS / HAVELLS
05. Switch fuse/fuse switch : L&T / HAVELLS/ LEGRAND.
units.
06. Protective Relays. : English Electric/GEC/Seimens/L&T.
07. TV meter with MDI. : GEC / AE/ LEGRAND.
08. Voltmeter and Ammeter. : A.E / Equivalent or MDS.
09. Voltmeter and Ammeter : Kaycee / MDS / L&T.
Selector switch.
10. HRC Fuse. : Havell / L&T / LEGRAND.
11. HRC fuse base and carries. : Havell / L&T/ LEGRAND.
12. 1.1KV grade PVC insulated : INCAB / NICCO / RR.CABLE/RETCO.
& sheathed/ insulated
aluminium wire and flexible
cord (ISI marked).
13. 1.1 KV grade PVC insulat : CCI/INCAB / RETCO./ RR KABLE
ed armoured aluminium cable
(ISI marked).
14. 1.1KV grade PVC insulated : Finolex /Havell's./ RR KABLE
Copper wire and flexible cords.
15. RCCB/ELCB/MCCB. : L&T / LEGRAND/ HAVELL'S
16. Switch fuses with rewirable : L&T/ LEGRAND/ HAVELL'S
fuses.
17. Isolator. : L&T / LEGRAND/ HAVELL'S
18. Changeover Switch. : L & T / LEGRAND/ HAVELL'S
19. MCB Distribution Board. : MDS / L&T/LEGRAND/HAVELL'S
20. MCB/MCB type Isolator. : MDS / L&T/ LEGRAND/HAVELL'S
21. 30/32A DP molded Isolat : HAVELL'S / LEGRAND/ L & T.
-ing Switch.
22. 15/5 Amp switch & plug : CRABERTEE / LEGRAND/ GREAT WHITE
Socket.

23. 15/5Amp modular switch : CRABERTEE / LEGRAND/ GREAT WHITE
And socket.
24. 15/5 Amp piano key type : CRABERTEE / LEGRAND/ GREAT WHITE
Switch/flushed type plug
Socket.
25. Ceiling Rose. : ANCHOR / CONA / GREAT WHITE.
26. Buzzer/Call Bell. : CONA / L.K FUGA
27. Data wire : DLINK / AMPS / RR KABLE
28. I.O box : DLINK / AMPS / LEGRAND
29. Electrical fitting fixtures : SYSKA, CROMPTON, WIPRO (LIGHT),
CROMPTON / BAJAJ/ORIENT (FAN)
30. AC : CARRIER, HITACHI, DAIKIN



बैंक ऑफ बरोडा
Bank of Baroda

**BOQ FOR ELECTRICAL & DATA WORK FOR BANK OF BARODA , JAGATPUR
BRANCH**

SL.No.	DESCRIPTION OF ITEMS	UNIT	QUANTITY	RATE	AMOUNT
	1. WIRING TO POINTS				
1	Recess conduit wiring to light, ceiling fan, exhaust fan points with (2x1.5 sq mm + 1(1x1sqmm) PVC single core copper wire in PVC/ Super polythene pipe with galvanized iron junction & switch boxes & clip in type 6 Amp modular type switches with all accessories, T&P & as directed by the Engineer-in-charge.				
	i) Primary (1 light/fan controlled by one switch)	Nos.	45.00		
	ii) Secondary point (2 lights controlled by 1 switch)	Nos.	40.00		
	iii) Primary point (wall fan controlled by 1 switch and one sockets) 5 Amp.	Nos	12.00		
2	A. Recess conduit wiring to 6 Amp plug socket with switch on existing board as above	Nos.	5.00		
	B. Recess conduit wiring to 5/15 Amp plug socket with switch on separate board as above.	Nos	10.00		
3	Recess conduit wiring to call bell point with one gong bell of 6" dia placed at strategic point with 6 Amp switch bell push clip in type modular type fixed on G.I. boxes placed at skirting level for emergency use, the wiring details are as per Sr .no. - 01. The places as located in drawing & as per direction of Engineer-in-charge.	Set	1.00		
4	The supply to above will be given from 16 Amp switch placed in a modular box at the entrance of the Bank building, which can be operated by Guard. The M.S. box should have hinged door with locking arrangement. The cable in the wall & flooring is to be recessed properly & passed through 1" PVC pipe. The size of the box 200mm x 150mm x 100mm, made out of 18 SWG CRCA sheet properly painted with 2 coats of primer & above it 2 coats of enamel	Set	2.00		

	paint. The box contains 16 Amp switch-1 no. & 6 Amp switch- 1no. & 6 Amp socket- 1no. (all flush type) & as per direction of Engineer- in-charge.				
5	Supply of all required materials and wiring to circuits/ submains with following number and sizes of PVC insulated 1100 volt grade standard copper wire run inside pre-laid PVC conduit pipe of ISI mark as required and copper wire as earth continuity conductor and complete in all respect including making good to all damages caused and as per the direction of Consultant and Engineer-in- charge.				
	A. Recessed wiring with 2x(1x2.5sqmm) +1x(1x1.5sqmm) copper wire	Mts	240.00		
	B. Recessed wiring with 2x (1x4sqmm) + 1x (1x2.5sqmm) copper wire	Mts	190.00		
	C. Recessed wiring with 4x (1x10sqmm) + 1x (1x6.0sqmm) copper wire	Mts	55.00		
6	Suppling ,fixing and testing of indoor wall mounted type distribution board of door type of approved make .				
	L.D.B	Set	2.00		
	12 way DP DB Incoming 1 No. 32A DP MCB Out going 10 No. 6-10 A SP MCB				
7	Supply of all required materials and wiring to AC plug point with 2 (1x4sqmm) PVC insulated copper wire run inside screw type PVC conduit pipe with ISI market laid on surfaced/recessed of wall/ceiling alongwith 1 (1x2.5sqmm) PVC insulated copper wire as earth continuity conductor complete in all respect including with use of 1.5 TR AC starter, concealed metal boxes with cover, wire, 20A SPN metalclad plug socket, metallic switch box for plug, junction box etc complete with making good the damages caused as required and as per direction of Engineer in charge.	Nos.	10.00		
2.COMPUTER WIRING					

1	Supply of all required materials and wiring to circuits/ submains with following number and sizes of PVC insulated 1100 volt grade standard copper wire run inside pre-laid PVC conduit pipe of ISI mark as required and copper wire as earth continuity conductor and complete in all respect including making good to all damages caused and as per the direction of Consultant and Engineer-in-charge.				
	A. Recessed wiring with 2x(1x2.5sqmm) +1x(1x1.5sqmm) copper wire	Mts	240.00		
	B. Recessed wiring with 2x (1x4sqmm) + 1x (1x2.5sqmm) copper wire	Mts	190.00		
2	Supplying & fixing of UPS input DB company made & wired with double door arrangement OF APPROVED make) with following arrangement. Incoming 63 amp TPN MCB– 1 no	SET	1.00		
3	Supplying & fixing of UPS output DB company made & wired with double door arrangement OF APPROVED make) with the following arrangement. Outgoing 40 Amp DP MCB – 2 nos. (1main & 1 spare).	SET	1.00		
4	Suppling ,fixing and testing of indoor wall mounted type distribution board of door type of approved make .				
	C.D.B	SET	1.00		
	10 way SPN DB Incoming 1 No. 32A DP MCB Out going 8 No. 6-10A SP MCB				
5	Supplying & fixing of computer terminal boxes made of G.I. fitted with (3nos. of 6 Amp switches + 3 nos. 6Amp socket), all clip in modular type & as per direction of Engineer-in-charge.	Set	16.00		

6	Providing and fixing of chemical earth electrode made out of 50mm dia class-B Asahalock or equivalent 2m length with copper plate made out of 600x600x3.15 mm tinned copper plate along with one number 40x5mm tinned copper strip grazed with the plate buried vertically with top edge of the plate at a depth of 1500 mm with arrangements for termination of copper strip of earth continuity conductor including cost of charcole, salt foreign soil, water pouring arrangements brick masonry enclosure on top with R.C.C cover complete with labour and material as per direction of Engineer-in-charge	Set	1.00		
7	Supply of all required materials & wiring to clip in modular type 15 /5 amp socket points controlled by 1 no 15 amp switch complete in all respect including making good to damages caused as per direction of EIC for Hub connection supply .	Nos	4.00		
8	The earth lead by 8sq.mm PVC single core copper wire in GI pipe to connect from earth electrodes to UPS outgoing earth bus & as per direction of Engineer-in-charge.	Mts	55.00		
4.0	Master Control: Supply, Installation, Testing, and Commissioning of 160 Amp TPN Main switches of following capacity (IS 13940 Part 3/1993) on existing surface / wall mounting and complete with HRC Fuse links,interconnections, earthing, etc. as required as per direction of Engineer in Charge.Make-SEIMENS/HPL/ANCHOR/L&T/HAV ELS/C & S/ RK	set	1.00		
3. FITTINGS AND FIXTURES					
1	Supply,installation and testing of LED light fittings of size 2'-0"x2'-0" ,39 watts with all accessories complete assembly of Philips.	Nos.	20.00		
2	Supply,installation and testing of spot light LED fittings (1x15wt) with all accessories complete assembly of Philips as required as per direction of Engineer in charge.	Nos.	32.00		

3	Supply,installation and testing of single tube lights patty fittings (1x36wt) of surface mounting with all accessories complete assembly of Philips (MODEL No. TMS 021/136 LPF) as required as per direction of Engineer in charge.	Nos	14.00		
4	Supply,installation and testing of Focus light LEDfittings (1x3wt) with all accessories complete assembly of Philips as required as per direction of Engineer in charge.	Nos.	4.00		
5	Supply,installation and testing of small size spot light mirror optics, LED in the wooden ceiling with all accessories complete assembly of Philips as required as per direction of Engineer in charge.	Nos.	-		
7	Supply,installation and testing of strip light with all accessories complete assembly of Philips as required as per direction of Engineer in charge.	Mtrs.	-		
8	Providing and fitting of 450 mm sweep Wall fan of approved make .	Nos.	10.00		
9	Providing and fitting of 1200 mm sweep celing fan of approved make .	Nos.	2.00		
10	Providing and fitting of 400 mm sweep Exhust fan of approved make .	Nos.	4.00		
11	Providing and fitting of call bell of approved make .	Nos.	1.00		
	4. PHONE WIRING				
1	Supply of all required materials & laying of the following sizes of phone wires of approved make inside the approved size PVC conduit complete in all respect as per instruction of EIC .2 pairs telephone wires.	Mtrs.	100.00		
2	Supply , fixing , testing of phone point with suitable GI boxes with phone , socket complete in all respect as per direction of EIC.	Nos.	5.00		
2.0	4. GLOW SINAGE BOARD POINT WIRING				
	Supply of all required materials and wiring to circuits/ submains with following number and sizes of PVC insulated 1100 volt grade standard copper wire run inside pre-laid PVC conduit pipe of ISI mark as required and copper wire as earth continuity conductor and complete in all				

	respect including making good to all damages caused and as per the direction of Consultant and Engineer-in-charge.				
1.0	Concealed wiring with 2x (1x2.5sqmm) + 1x (1x1.5sqmm) copper wire (PANEL to.Glow sign board)	Mts	45.00		
A	Supply,installation and testing of timer with contactor (L&T / Legrand) make controlling the glowsign board with all accessories complete as required as per direction of Engineer in charge. The system will be apart of the panel board.	Nos.	-		
5. MAIN PANEL BOARD					
1	Supply, delivery, installation , testing , commissioning , of L&T indoor wall,floor , mounted , type distribution boards made out of 2 mm thk. CR sheet metal duely acid treated premised & painted with 2 coats of enamel paint compartment arrangement for each equipment & bus bar chamber on the top of the panel running horizontal through out its length duly lamp , vermin proof having provision cable by conduit entry , earthling stud as per specification mentioned below duly factory wired confirming to the relevant ISS & as per special condition of contract , making good the damages M.S. Cubical type Panel board should have hinged door at the front. The panel shall be provided with all accessories & following arrangements complete in all respect & direction of EIC (before fabrication of panel board drawing is to be approved by Engineer-in-charge). Incoming- 1No 125 A TPN SDF with HRC switch 125A bus bar 63 A Change over Out going- 5Nos 32 A DP MCB for A.C 1Nos 40 A DP MCB for LDB/PDB 1Nos 63 A FP MCB for UPS 1-500 Amp. Meter with selector	Set	1.00		

	switch Phase indicator lamp	Volt meter			
2	Earthing as per I.E. rules with 40mm dia G.I. pipe of 3 mt. Long perforated on all sides with arrangements of light , termination of 600x600x3mm copper plate & 19x3 G.I flat firmly connected to plate with copper nut & bolt , washer etc . The earth pit should be filled with alternate layers of charcoal, salt & soil. The brick masonry chamber is to be covered with CI cover of minimum 300mm x 300mm size with all accessories & as per direction of Engineer-in-charge.	Nos.	1.00		
3	Supplying & fixing Earth lead with 8nos. of GI wire.	Mtrs.	55.00		
6.LOCAL AREA NETWORK (LAN)					
1	Recess wiring with Cat-6 Lan cable with PVC conduit	Mtrs.	320.00		
2	Supply and fixing of Cat-6 IO box with cover for LAN	Nos.	16.00		
3	Supply and fixing of Cat-6 Patch chord 2 mtr long	Nos.	16.00		
4	9U Data Rack-D-Link	Nos.	1.00		
5	24 Port 10/100Switch-D-Link	Nos.	1.00		
TOTAL					

બંક ઝાંખ બંદોલ
Bank of Baroda

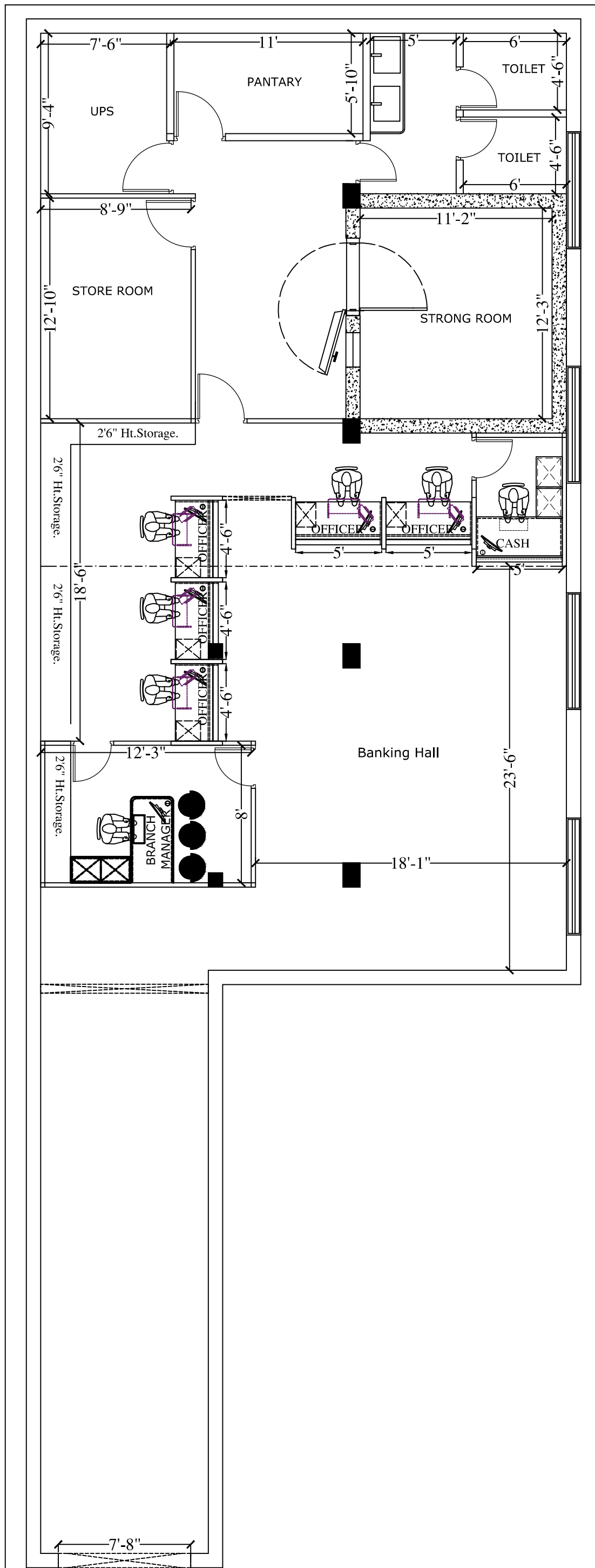

OP - IV

Title -
**PROPOSED LAYOUT PLAN OF BOB
 JAGATPUR BRANCH**



Drawing No -
 Drawn By - S.S.SETHY
 Date - 07.09.24 Scale - N.T.S



CURVES ARCHITECTURE
 AR, CHINMAYA RANJAN DAS
 PLOT NO-33, BANKER'S ENCLAVE
 PRACHI VIHAR, PALASUJ, BHUBANSWAR
 PH-9438562471
 e-Mail-curves.architecture@gmail.com

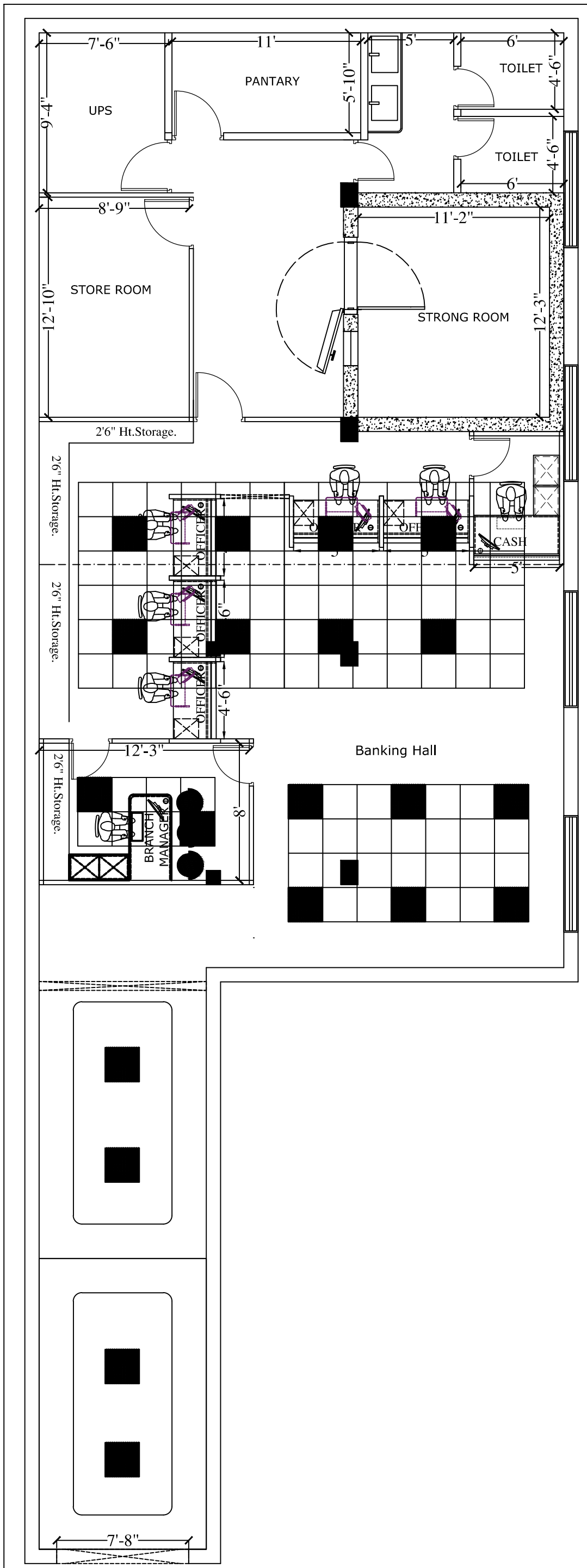

QP - IV

Title -
**PROPOSED LAYOUT PLAN OF BOB
 JAGATPUR BRANCH**



Drawing No -
 Drawn By - S.S.SETHY
 Date - 07.09.24 Scale - N.T.S



CURVES ARCHITECTURE
 AR.CHINMAYA RANJAN DAS
 PLOT NO-33, BANKER'S ENCLAVE
 PRACHI VIHAR, PALASUT, BHUBANESWAR
 PH-9438562471
 e-Mail-curves.architecture@gmail.com