

# **PRICE BID**

VOL-II

TENDER DOCUMENT

FOR

FURNISHING OF  
**BARODA ACADEMY**

AT

**LUDHIANA**

OFFICE OF THE  
GENERAL MANAGER  
BANK OF BARODA, ZONAL OFFICE  
3<sup>RD</sup> Floor, Surya Complex, Opp PAU Gate No1 Ferozepur Road  
Ludhiana, Punjab. -141001

e-mailid: [pe.zoludhiana@bankofbaroda.com](mailto:pe.zoludhiana@bankofbaroda.com)

ARCHITECTS :

**GURDEV GROUP OF ARCHITECTS**

SCO 1094-95, SECTOR 22-B,

CHANDIGARH - 160 022

PHONE : 0172-2712201

MOBILE : 094170-08450

Time and Date of receipt of tenders: Till 4.00 PM on or before **29.01.2025**

Time and Date of opening of Technical Bids: At 5.00 PM on **29.01.2025** or  
as decided

**TENDER FOR THE FURNISHING OF BARODA ACADEMY LUDHIANA****SPECIFICATIONS / BRANDS / MAKE OF ITEMS TO BE USED.**

<b><u>DESCRIPTION</u></b>	<b><u>BRAND</u></b>
a) Board / Ply :	ARCHID, Green Ply, Duro, Century
b) Laminate 1mmth. :	Merino, Formica, Sunmica, Aica, Greenlam, Century, AICA
c) Door Closer / Floor spring :	Everite, Doorking, Ozone/Dorma for Toughened glass doors
d) Drawer & Keyboard, Slide Rails :	Earl Bihari, Ebco
e) Glue for fixing commercial Board / Laminate :	Fevicol (Pidilite)
f) Glass :	Triveni, Modi Float
g) Mortice Latch & Lock :	Godrej, Harrison
h) Vertical Blinds :	VistaLevelor / Mac.
i) Tapestry/leather foam :	Harmony, Vimal, Bhor
j) Aluminium Sections :	Jindal/Mahavir/Hindalco
k) False Ceiling :	India Gypsum
Grid ceiling :	Armstrong 2'x2'
l) Synthetic Enamel :	Asian, Nerolac, ICI
m) Emulsion Paint/Plastic Paint :	Asian, Nerolac, ICI
n) MCBs :	Havells, L&T make
o) DB's :	Havells, L&T make
p) Switch & Socket :	Havells / L&T, Anchor Penta(Modular)
q) Pipe (PVC) :	Uniplast, D-Plast, AKG
r) Telephone Cable :	Delton
s) Wires :	Havells, Finolex, R.R. Kabels, Polycab
t) Cables :	Grandley, ICC, R.R. Kabels.
u) Fans :	Khaitan, Crompton, Orient
v) Mirror Optics/LED's :	Crompton, Philips
w) Spot light & light fittings :	Crompton, Philips

**CONTRACTOR****BANK OF BARODA****TENDER FOR THE FURNISHING OF BARODA ACADEMY- LUDHIANA**

<b>A</b>	<b>FURNISHING WORKS</b>	<b>ESTIMATE</b>
----------	-------------------------	-----------------

S No	DESCRIPTION	QTY	UNIT	Rate	Amt
1	<b>PPGI METAL SHEET FALSE CEILING:</b> Providing & fixing in position false ceiling in Armstrong 600 x 600 mm PPGI Metal microlook lay-in standard perforated tiles silhouette 38 made of 120 gsm pre-painted galvanised iron, Grade-GPL as per IS277 (2018) with coating durability as per IS 4246 color as approved by Bank/architect with 15mm exposed grid system ( <b>Grid frame shall have black groove at bottom</b> ) by Armstrong Co. with suspenders. Making necessary framework for A.C. ducting, if any, and necessary cutouts for diffusers and light fittings, taping and finishing to proper line & level, including making grooves and trap doors for A.C. unit .	1650	Sqft.		
2 i	Providing & Fixing false ceiling at 9'-0" ht. of India Gypsum Ltd. (GMFSC-4.1) / POP using 12.5mm thick Gypboard / POP & chicken-mesh, paper tape, jointing compound, G.I. Sections marked "Gypsteel" to be placed at 4'-0" C/C in one direction and at 1'-6" C/C in other direction. The false ceiling shall be finished properly after cutting / making holes for fixing light fixtures including three coats of oil bound distemper paint etc. complete as per drgs.	2700	Sqft.		
ii	Making Cove in Gypsum ceiling (Rft x 1'-6")	710	Sft.		
3 i	<b>TOUGHENED GLASS DOORS &amp; PARTITION:</b> Providing & fixing 12 MM thick toughened glass for door and fixed glazing, with complete patch fittings such as handles, lock and L-brackets etc. The job shall also include etching design.	260	Sqft		
ii	Providing & Fixing of Floor Springs of approved make	4	Nos		
4	Providing and fixing wooden partition made of internal frame of alum sections of size 1.75"x1.75" placed at 2'-0" c/c vertically and horizontally finished with 9mm thick commercial ply on both sides with 1.00 mm thick laminate on both sides with horizontal grooves. These partitions shall have 5.00 mm thick glass (etching as per design) above 2'-6" ht. or 4'-0" ht with beading 1/2"x1 1/2" . The rate of partition shall include providing & fixing wooden door finished with laminate on both sides and partly glass, but with complete hardware required such as latches, stopper. The low ht. partition shall have rubber-wood / teak-wood gola of size 3" x 3/4" which shall be polished as per shade reqd.				
(i)	Low ht. partitions with 12 mm thick glass.	50	Sqft.		
(ii)	Full ht partition with 5mm th. Glass.	550	Sqft.		
(iii)	Full ht partition without Glass.	2152	Sqft.		
(iv)	Cost Mortice locks	12	No		
(v)	Cost of Multipurpose locks for storages, drawers etc.	40	No		
(vi)	Cost door closers.	10	No		
(vii)	Cost floor springs.	0	No		
viii	P/F 2" thick thermocol as sound insulation in wooden ppartitions of class rooms.	0	Sqft		

5(i)	P/F wall paneling on alum section frame 1" x 2" placed @ 2'-0" c/c horizontally & vertically @ 1'-0" C/C, finished with 9mm thick commercial ply, <b>1.00 mm thick laminate</b> as per design, the paneling shall be closed with 2" x 1" hard wood beading	1170	Sqft.		
ii	P/F wall paneling as <b>box paneling</b> , made with 19mm thick commercial ply, 1.00 mm thick laminate as per design.	220	Sqft		
iii	Providing & fixing in position wooden <b>teak wood/Cedar wood veneered ply 4mm th wall paneling</b> with base frame work of alum. Sections / soft wood sections as per design and melamine polished.	450	Sqft		
iv	Providing & fixing in position wooden <b>teak wood/Cedar wood veneered ply 4mm th (raised wall paneling with sides taper/slope)</b> with base frame work of alum. Sections / soft wood sections as per design and melamine polished.	0	Sqft		
v	Providing & fixing Charcol ceiling.	350	Sqft		
vi	P/F <b>Teak wood battens</b> of size 3"x5" to be fixed in false ceiling to be melamine polished.	0	Rft.		
6	<b>Tables with 1½" thick post-form factory made Tops:</b> Providing & fixing office tables with/without drawer and storage below of size 2'-4½" (wide), 2'-6" (high) with the provision of key board, with sliding channels of Ebco, complete (full length & width) shelf for CPU at bottom and foot rest. The table shall be made of 19mm thick commercial board; 1mm thick laminate on (inside & outside) with rubber -wood gola of size 1 ½" x ¾" polish, side golas etc., with hardware such as hinges, catchers and handles. Inside of drawers, storage cabinet portion shall also be finished with 8mm thick laminate of approved color.				
i	TABLE = 6'-0" X 2'-9" (Principal Table)	1	No		
ii	TABLE = 4'-6" X 2'-6"/2'-3"	4	No		
iii	TABLE = 4'-0" or below 4'-0"X 2'-3"/2'-0" with side drawer & storage below	3	No		
iv	TABLE = 5'-0" X 2'-3"/2'-0" with side drawer/s below	4	No		
v	TABLE = 7'-0" X 2'-3"/2'-0" with side drawer/s below	4	No		
vi	Dining tables of size 4'x2'	0	Nos		
viii	Dining tables of size 6'x2'	0	Nos		
ix	P/F Wooden & laminated AC Box frames 4'x4' for indoor cassette AC units.	10	Nos		
x	P/F Laquered glass on cols.	0	Sqft		
7	<b>Side Rack with 1½" thick post-form factory made Tops:</b> Providing and fixing side rack, 2'-3" ht. as per design. These racks shall have two drawers with storage below and be made of 19mm thick commercial board; 1mm thick laminate (inside & outside) with rubber - wood gola of size 1 ½" x ¾" polish, side golas, handles, catchers, hinges etc. Inside of drawers, storage cabinet portion shall also be finished with 8mm thick laminate of approved color.	18	Rft.		

8	<b>Deputy General Manager Table 7'X3'-6"</b> Providing & fixing Dep. General Manager table 2'-6" ht. as per drgs. having drawer/s, storage cabinet, key board, with sliding channels of Ebco, foot rest, space for CPU & Monitor, all as per drg. / design, the table shall be made with 19mm thick com. Board finished with <b>4mm th veneered ply to be polished</b> , & hardware, such as handles, catchers, hinges etc. shall be shall be provided as per requirement. Inside of drawers, storage cabinet portion shall also be finished with 0.8mm thick laminate of approved color.	0	No		
9 i	<b>STORAGE CABINETS: with 1½" thick post-form factory made Tops:</b> Providing and fixing storage cabinets low ht and full ht x 16" (Deep) along the walls/partitions, as per interior drawings, using 19mm board ply for carcass, shutters, vertical and horizontal partitions, 6mm ply for the back and 1mm High Gloss laminate of approved shade on vertical and horizontal visible surfaces. The shutters shall be overlapped on the carcass and shall be provided with EBCO hinges. The width of the shutter shall be between 12" to 15" as per the site conditions. All the exposed edges of the board shall be provided with wooden lipping 19mm x 3mm, duly PU polished/deco painted in desired shade. The inner surface shall be provided with 0.8mm thick laminate of desired shade, design and gloss. The cabinet shall be complete with handles, knobs, locks and magnet catchers etc. to the satisfaction of the Architect/Engineer.	450	Sft.		
ii	<b>STORAGE CABINETS HAVING RAISED PANELS OF TEAK WOOD:</b> Providing and fixing storage cabinets low ht and full ht x 16" (Deep) along the walls/partitions, as per interior drawings, using 19mm board ply for carcass, shutters, vertical and horizontal partitions, 6mm ply for the back and 3mm teak faced veneer ply of approved shade on vertical and horizontal visible surfaces. The width of the shutter shall be between 12" to 15" as per the site conditions. All the exposed edges of the board shall be provided with wooden lipping 19mm x 3mm, duly PU polished/deco painted in desired shade. The inner surface shall be provided with 0.8mm thick laminate of desired shade, design and gloss. The cabinet shall be complete with handles, knobs, locks and magnet catchers etc. to the satisfaction of the Architect/Engineer.	0	Sqft		
10 (i)	Providing & fixing notice board of size 2'-6"x 4'-0" acrylic sandwiched.	2	No		
11 (i)	Providing and fixing 18mm thick MDF Jali computerized cut design in front of tables, counters, False ceiling and wall panels. Back side of this jali will have milky white acrylic sheet with yellow colored LED 4' long tube lights at every 2'-0" C/C in both directions.	60	Sqft.		
12	<b>BEVELLED MIRROR:</b> P&F Bevelled Mirror (12"x12") to be fixed diagonally paneling on RCC Col./wall as per design.	100	Sqft		
13	P/F Zebra blinds of vista / Mac of approved shade / colour.	175	Sqft.		

14	Painting work on walls (internal / external walls) with special repairs & cemented ceiling, toilets, strong room, stationery pantry, with oil bound distemper paint and enamel paint on shutters and grills. (whole premises) Berger, Nerolac, Asian.	3500	Sqft		
15	<b>WALL PAPER:</b> Providing and laying wall paper as per sample approved.	600	Sqft		
16	<b>TEXTURE PAINT:</b> Providing and laying texture paint of "Heritage" Co. "Rustic type" as per colour scheme.	100	Sqft		
17	<b>MDF JAALI:</b> Providing and fixing 12/18mm thick MDF Jali computerized cut design on columns. Back side of this jali will have milky white acrylic sheet with yellow colored LED 4' long tube lights at every 2'-0" C/C.	0	Sqft		
18	Construction of 4.5" th brick wall for toilets & electrical room.	450	Sqft		
19 i	Construction of 9" th brick wall.	40	Sqft		
ii	Making RCC lintols 9"x9" over doors openings	1	Nos		
20i	Cement plastering on new brick masonry.	1100	Sqft		
ii	Making RCC lintols 4.5"x6" over doors openings	2	Nos		
21	P/F laminated Flush doors with hard wood chowkhats, complete hardwares req.	3	Nos		
22 i	P/F vitrified wall tiles of size 4'x2' in toilets & kitchen walls with reqd chemical / cement, joint filling with the matching grout.	350	Sqft		
ii	P/F wash basin.	2	Nos		
iii	European WC with cistern of CERA / Hindustan / Parryware Flair Model / equivalent.	1	Nos		
iv	Seat cover	1	Nos		
v	Jet spray for WC	1	Nos		
vi	Towel Rail 2'-0" long	1	Nos		
vii	Soap Dish	1	Nos		
viii	Mirrors of 18"x24"	1	Nos		
ix	Small body taps (Parryware Model No. G1404A1 / equivalent)	1	Nos		
x	Long body taps (Parryware Model No. G1405A1 equivalent)	1	Nos		
xi	Angle Valves / Stop Cocks (Parryware Model No. G1453A1 / equivalent)	1	Nos		
xii	PVC Connection pipes	3	Nos		
xiii	Waste pipes for Sink complete	3	Nos		
xiv	Waste pipes for Wash Basin complete	2	Nos		
xv	Double Bowl SS Sink for kitchen	1	Nos		
xvi	Urinals with waste pipe	4	Nos		
xvii	Toilet paper holder	3	Nos		
xviii	Chimney for kitchen	1	No		
xix	25 (5-star) Litre gyser for kitchen	1	No		
xx	Dismantling of existing 1 no. toilets 4'-6"x6'-6" & disposal of its malba.	1	Job		

23	P/F sewerage PVC pipes 4" & 3" for the disposal of <b>4 no urinals &amp; 1 kitchen</b> , which shall include elbows, T-joints, P-S Traps for W.C.'s Floor traps for wash basins. These waste pipes shall be connected into the existing manholes at G.F. in rear courtyard. the job shall include the repair of walls, lanter and flooring of the building.	1	Job.		
24	P/F water supply cPVC pipes 1" & 1.25" for water supply for <b>4 urinals &amp; 1 kitchen</b> , which shall include elbows, T& cross-joints, hexa joints etc. These pipes shall be connected from the existing nearby toilets / pipes.	1	Job.		
25	P/F S.S. logo of size 2'xx2'-3"	0	Nos		
26	P/F S.S. "LUDHIANA ZONE".	0	Sq. inch		
27	P/F wooden flooring AC4 grade in principal room.	0	Sqft		
28	P/F Synthetic nylon carpet.	0	Sqft		
29	P/F vitrified tiles flooring tiles of 33"x33" on existing floor as per color shade approved of Marbonite/Johnson/Kazaria/Somany.	0	Sqft		
30	Constn of RCC kitchen slab 2" thick 2'-0" wide.	50	Sqft		
31	P/F Italian marble on kitchen counter	60	Sqft		
32	<b>BOB</b> <b>LOGO:</b> Providing , making to shape and size ( as per the design provided) and fixing to position BOB logo made out of ACP / Acrylic sheet of bank color (pre approved) fixed to position with aluminium framework with required screws, nutts bolts and hooks etc. of size 2' x 2', including outer frame finished with teak wood vinear ply with cove for lighting as LED strip. Below logo, the bank's name shall be written in golden / orange ACP sheet letters as per design.	8	Sqft		
33	P/F BOB small logo's of acrylis/plastic on each tables of size 6"x6"	4	Nos		
34 i	P/F M.S. rolling shutters 8'x8'on entrance with complete fittings such as central floor lock M.s. Cover.	1	Nos		
ii	P/F M.S. rolling shutters 6'x8'on entrance with complete fittings such as central floor lock M.s. Cover.	1	Nos		
	<b>TOTAL</b>				
<b>B</b>	<b>ELECTRICAL WORKS</b>				
26	<b>ELECTRICAL POINTS</b> : Providing laying, fixing & testing of electrical points including wiring fire retardant PVC insulated copper wire flame guard multi-strand copper conductor from MCB's to switches and switches to fixture, plate type switches, socket & M.S. Modular boxes with rust proof treatment size to accommodate the required nos. of switches & sockets plus circuit wiring from switches to lights/fans/fixtures etc. wherever required complete with earthing 1.00 mm <sup>2</sup> multi strand wire in 25mm dia. Unbreakable PVC conduit ISI marked with specials under floor / wall & above false ceiling or making truff under / along work – stations including chase cutting, disposal of melba away from the site and repair of the same with cement mortar, copper conductor wires only will be used of approved make.				

a)	Electrical wiring (1.5 to 2.0-ton AC) in PVC pipe embedded in wall / laid on ceiling frame for Air-Conditioning: P / F wiring from D/B to site of (outdoor) and indoor A/C Unit with 3-core 4mm sq. 1 run of 2.5mm sqmm fire retardant PVC insulated copper wire flame guard multi-strand copper conductor.	280	Mtr		
b)	Electrical wiring (3-ton AC) in PVC pipe embedded in wall / laid on ceiling frame for A i r - C o n d i t i o n i n g : P / F wiring from D/B to site of (outdoor) and indoor A/C Unit with 5-core 4mm sq. 1 run of 2.5mm sqmm fire retardant PVC insulated copper wire flame guard multi-strand copper conductor.	430	Mtr		
c)	15 Amp wiring with 2.5mm sq. fire retardant PVC insulated copper wire flame guard multi-strand copper conductor & metal clad enclosure sockets.	32	No		
d)	5 Amp plug point wiring with 1.5mm sq. fire retardant PVC insulated copper wire flame guard multi-strand copper conductor Plate switches, sockets, plugs. Etc.	90	No		
e)	Call-bell point wiring including Ding-dong bell with 1.5mm sq. fire retardant PVC insulated copper wire flame guard multi-strand copper conductor including plate switches, sockets, etc.	4	No		
f)	Wall Fan (5amp. switch socket for wall fans), lights & exhaust fan point wiring with 1.5mm sq. from D/B to switches & fittings fire retardant PVC insulated copper wire flame guard multi-strand copper conductor including plate switches, sockets, etc. (For payment no. of switches shall be counted).	190	No		
27 i	<u>Wiring &amp; fixing telephone point to be left from table to outside for the connection from BSNL or so:</u> Incl. Providing and fixing of PVC conduit in wall floor incl. Telephone cable, M.S. box and two pin telephone sockets on or R.J. - 11 plates out let incl. Testing and commissioning etc. as required.	10	No		
ii	P/F telephone krone box (20 pair)	0	no		
28	Signage wiring (material & labour) – P&F of 2x4mm and 1x1mm copper fire retardant PVC insulated copper wire flame guard multi-strand copper conductor PVC conduiting of ISI make complete with all accessories like Saddles, bends modular switches etc.	2	No		
29	Providing & Fixing 2' x 2' recessed mounted LED Luminaire LCTLR-36-CDL of Crompton or panel light.	42	No		
30	Providing & Fixing 15 W LED ROUND DOWNLIGHTER LCND-15-CDL of Crompton.	110	No		
31	Providing & fixing LED tube lights 1x36W of Philips.	15	No		
32 i	Providing & Fixing wall fans: Crompton Greaves / Orient / Bajaj / Havells.	40	No		
ii	P/ false ceiling fans of size 2'x2' to be fitted in drid ceiling.	0	Nos		
(ii)	Exhaust Fans 12" Dia /6" Dia to be fitted in PVC pipe: 1400 rpm (Double ball bearing) Heavy duty Crompton Greaves / Orient / Bajaj / Havells.	8	No		
(iii)	Providing & Fixing ceiling fans: Crompton Greaves / Orient / Bajaj / Havells. 4' dia.	1	No		



(iv)	Cost of modular regulators of Havells / Anchor ROMA makes.	1	No		
33	Providing & fixing main electrical dist. Board duly earthed, with all internal electrical and generator connections with 10 sq.mm multi strand copper wire, all hardware nickel coated, which shall include the following items.				
(i)	Amp Meter and voltmeter set	1	SET		
(ii)	Kit-kats 200 Amp. (3 Nos & 1 no neutral link)	1	Set		
(iii)	Aluminum bus bar 200 Amp proper tinned.	1	No		
iv	200 Amp. Main switch MCCB type.	1	No		
v	Aluminum bus bar 200 Amp proper tinned for generator panel	1	No		
vi	200 Amp. Main switch MCCB type for generator panel	1	No		
vii	100 Amp. Main switch MCCB for AC's & power D/B	2	No		
viii	63 Amp. Main switch MCCB	15	No		
ix	Change -over 200 Amp. 3-Phase of Havells make.	1	No		
x	8 way 3 phase MCB D/B (Lights D/B) with 63 amp TPN & 24 nos different rated MCBs / DP	4	Nos		
xi	8 way 3 phase MCB D/B (AC's & Power D/B) with 63 amp TPN & 24 nos different rated DPs	4	Nos		
xii	P/F metal Clads 32 Amp for AC's 1.5 & 2.0 ton capacity	8	Nos		
xiii	Making double-door powder coated M.S. Distribution board 4'x6' to accommodate Raw power panel	24	Sqft.		
	<b>UPS SUPPLY</b>	0			
xiv	Providing and fixing (MCB type) DP of 63 Amp of Havells make for UPS supply.	6	No		
xv	P/F single phase 12-way D/B with 1 no DP & 10 MCB's	4	No		
34	Providing & fixing main electrical cable 4-core al. cable armored from elect. pole to meter 70mm dia.	80	Mtr		
(i)					
(ii)	P/F generator wire/cable 35mm 4-core Alum. Cable armoured.	45	Mtr		
iii	P/F 16mm 4-core Alum. Cable from bus bar to light & AC/power D/B's.	260	Mtr		
iv	P/F 6mm 3-core with 2.5 mm 1 run of copper wire from UPS output to UPS D/B's D/B.	125	Mtr		
35	P/L copper pipe with 3 core 4 mm & 1 no interconnecting wire (communication wire) fire retardant PVC insulated copper wire flame guard multi-strand copper conductor complete insulation upto outdoor unit required for 1.5 ton/2.0 Ton split type A.C.s from from indoor to external units.	700	Rft.		
(i)					
ii	P/L copper pipe with 5 core 4mm fire retardant PVC insulated copper wire & 1 no interconnecting wire (communication wire) flame guard multi-strand copper conductor complete insulation upto outdoor unit required for 3.0 Ton Cassette type A.C.s from from indoor to external units.	900	Rft.		
(iii)	Providing and laying 25mm dia. PVC pipe heavy duty Diplast make for drainage of water of inside units.	800	Rft.		

36	Providing and fixing one no. amplifier (USB, Blue-tooth, Aux and Mic.) of Philips / Ahuja (DPA 570M, 50W RMS-75W Max. make and 10 nos. speakers for music in ceiling of Ahuja (CS-663T 6W/100 W 6" full range)make and wireless Mike of Ahuja make with 1.00 mm <sup>2</sup> copper wire in PVC 25mm dia pipe from the suggested place of control as per requirement.	1	Set		
37	Providing, supplying and erection Fire alarm system which shall include: 2-Zone panel of agni Make, 30 smoke sensors, 15 heat sensors with 2 Batteries with 12 Volt 7 AH, Manual Call Point, Auto Dialer, Armed cable: 2 core 0.75 mm etc.	0	Job		
38	UPS POINTS: P/L & testing electrical three point wiring /circuit wiring having individual circuits for computers with 2.5mm <sup>2</sup> fire retardant PVC insulated copper wire flame guard multi-strand copper conductor in unbreakable PVC conduits 25mm dia wall thickness 2mm thick with specials under floor / wall & above false ceiling including chase cutting, disposal of malba away from the site and repair of the same with cement mortar, incl. Switches & socket M.S. switch boxes with rust proof treatment size to accommodate the required nos. of Modular switches, sockets etc. & plate type sockets with indicator three in one plate including earthing with 1.00 mm <sup>2</sup> fire retardant PVC insulated copper wire flame guard multi-strand copper conductor complete in all respect.				
i)	Set of 6 amp. 4 sockets & 1 switch (Set of 4 Sockets shall be provided under the table and switch of these four sockets shall be provided on the above / side of table for easy access). Note: -The server shall have 2 sets of "output supply" from individual UPS.	60	Sets		
(ii)	UPS supply to tube lights: Point wiring / circuit wiring with 1.5mm sq. fire retardant PVC insulated copper wire flame guard multi-strand copper conductor from D/B to switches & fittings multi strand PVC copper wire including plate switches, sockets, etc. (for payment no. of switches shall be counted).	10	No		
(iii)	Providing and fixing 16 Amp 3-pin power tops with 4.00 mm <sup>2</sup> copper wire for UPS input	4	No		
39	GEL TYPE CHEMICAL EARTHING (Distance between each pit shall be min 1.5meter) (Generator + UPS + Raw Power = 3 nos) Supplying and installation of copper Gel Earthing station having length 3000 mm including bore-well, chamber with cover and all required civil allied works each earth pit to filled with 2 bags in 30 Kg pack of "Black-Fill Compound" (BFC) EARTHING CONDUCTORS: Wiring with 1x10 sqmm PVC insulated copper conductor wire of 650/1100 volts grade (Finolex make flame guard quality) as earth wire with concealed/exposed PVC pipe including making all the connections.	1	No		
40 (i)	Providing, laying, testing and commissioning CAT-VI/ Lucent / D-link computer networking cable in PVC conduit in floor or wall from server room to each table with I.O.'s (Socket)	70	No		

(ii)	Supplying of patch chords for computers 1m & 2m length.	70	No		
(iii)	Providing & fixing, testing and commissioning 24-port switch and patch panel with fan / M.S. rack.	3	No		
iv	P/F mass rack floor standing network rack/trolley 17U (600mmx600mm)	1	No		
<b>TOTAL</b>					
<b>C</b>	<b>AIR CONDITIONING WORKS</b>				
41 (i)	Providing, testing and commissioning 1.5 ton split A.C's 5-star of Carrier/Blue Star: indoor and outdoor units, M.S. stands, stabilizers, etc. complete.	5	No		
ii	Providing, testing and commissioning 2 ton cassette A.C's 3-star of Carrier/Blue Star: indoor and outdoor units, M.S. stands, stabilizers, etc. complete.	2	Nos		
iii	Providing, testing and commissioning 3 ton cassette A.C's non-inverter of Carrier/Blue 3 Star: indoor and outdoor units, M.S. stands, stabilizers, etc. complete.	8	Nos		
<b>TOTAL</b>					

**SUMMARY OF COSTS****FURNISHING OF BARODA ACADEMY AT LUDHIANA**

<b>S.N.</b>	<b>Particulars</b>	<b>Amount (in Rs.)</b>	
	<b>BARODA ACADEMY</b>		
	FURNISHING WORKS		
	ELECTRICAL WORKS		
	Total (A+B)		
	Discount, if any		
i	Total after discount		
	GST @ 18%		
	<b>Total with GST</b>		<b>1</b>
ii	AIR CONDITIONING WORKS		
	GST @ 28%		
	Total with GST		<b>2</b>
	<b>TOTAL (i + ii) without GST</b>		
	<b>TOTAL (1 + 2) with GST</b>		

Total Amount in words: Rupees

---

SIGNATURE and STAMP of CONTRACTOR

DATE:

**BRAODA ACADEMY PROPOSED LAYOUT.**

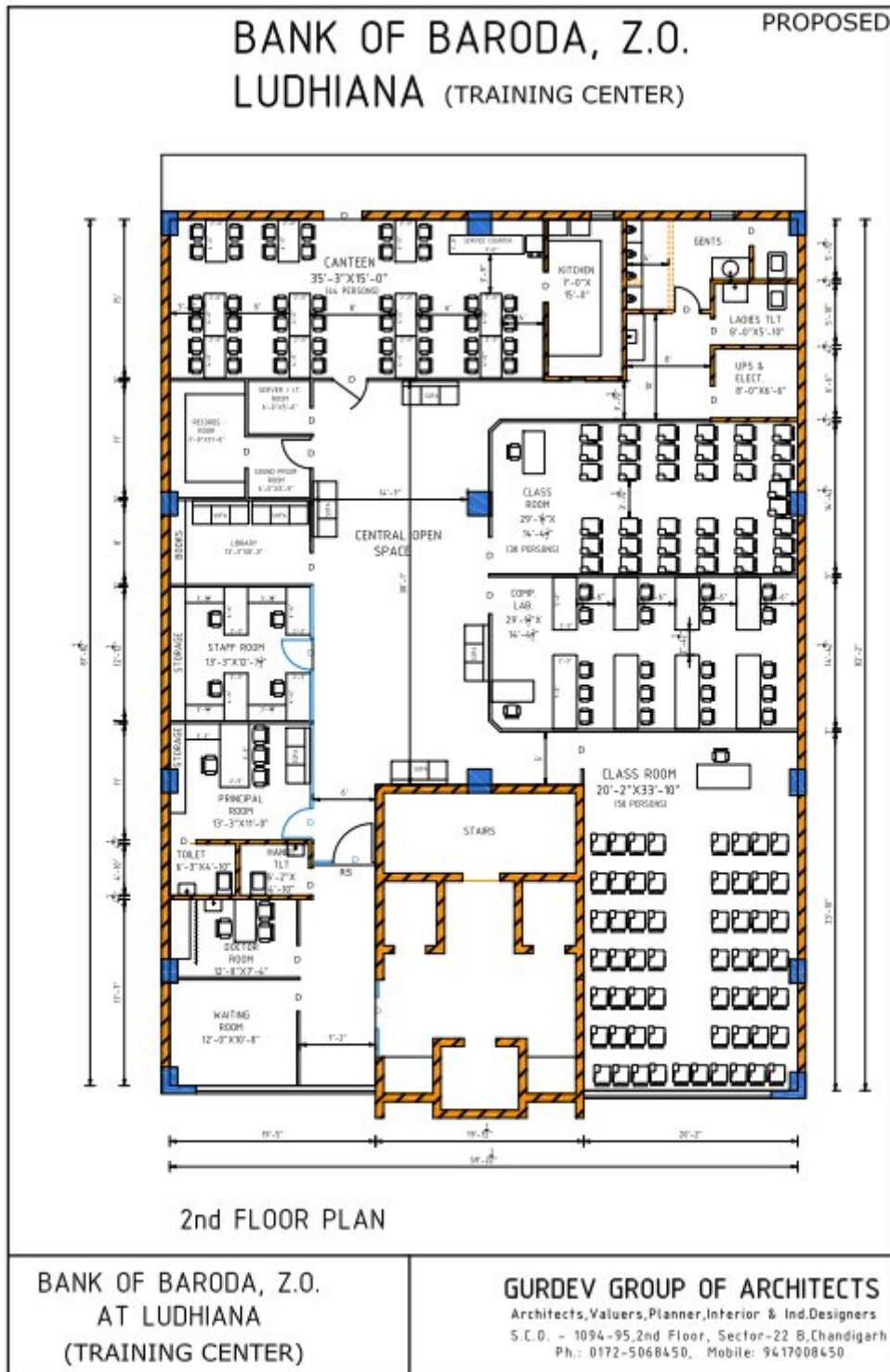

**BANK OF BARODA, Z.O.  
AT LUDHIANA  
(TRAINING CENTER)**

**GURDEV GROUP OF ARCHITECTS**  
Architects, Valuers, Planner, Interior & Ind. Designers  
S.C.D. - 1094-95, 2nd Floor, Sector-22 B, Chandigarh  
Ph.: 0172-5068450, Mobile: 9417008450

**BRAODA ACADEMY PROPOSED ELECTRICAL LAYOUT.**

