



REGIONAL OFFICE , KOTA

PART – I

TECHNICAL BID

**SPECIFICATIONS
&
CONDITIONS OF CONTRACT**

FOR THE

**INTERIOR FURNISHING, ELECTRICAL
& AC WORK**

SRINATHPURAM BRANCH, KOTA.

ARCHITECT

**YASH GARG DESIGNER'S ,
106, NANDPURI COLONY, MALVIYA NAGAR, JAIPUR
Mobile: + 91-9929595589
Email : ygdesigners@yahoo.in**

MEMORANDUM

- a) Tender Document : Interior, Furnishing & AC Works of **SRINATHPURAM BRANCH, KOTA.**
- b) Date of issue in Website : From **11.11.2024** to date of submission
- c) Last date of Submission of Tender : **02.12.2024** up to 3.00 p.m.
- d) Place of Submission of Tender : The Office of Regional Manager,
Bank of Baroda, Kota Regional Office,
first floor, Pukhraj tower, station road,
kota -324002
- e) Opening of technical bid By : **02.12.2024** at 4.00 p.m.
- f) Time of Completion of the Project : 45 Days from the date of Commencement
- g) Earnest money deposit : Rs. 47,800/- (Fourty seven thousand eight hundred rupees only) D. D. only in favor of **BANK OF BARODA** payable at **KOTA.**
(D.D. will be attached in technical bid only)
- h) Tender Form Fees : NIL /-
- i) Initial security deposit : 2% of the accepted value of tender (including earnest money) to be paid to the Bank within 7 days of the Intimation of acceptance of tender.
- j) Retention money : 10% of total amount (Including initial security deposit to be deducted from running bills if any).
- k) Date of Commencement : Either one week from the date of Acceptance letter or the day on which contractor is instructed to take possession of the site, whichever is later.
- l) Refund of total security : The initial security deposit comprising of EMD shall be refunded to the contractor along with accrued interest upon issue of certificate of virtual completion by the

Architect.

- m) Release of Retention money
 - a) 50% of the retention money will be released on completion of work and issue of virtual completion certificate by the Architect.
 - b) Balance 14 days after the end of defects liability period.

- n) Minimum value of work For interim certificates : 60% of work

- o) Minimum period of Submitting Interim bills : 25 days

- p) Defects liability period :12 (twelve) months from date of completion

TENDER NOTICE

To,

Dear Sir,

Sub: Interior Furnishing, electrical and AC works of Premises for Bank of Baroda,
SRINATHPURAM BRANCH, KOTA.

Bank of Baroda invites sealed tenders in two bid systems from experienced contractors, who possess the similar kind of work experience of furnishing, electrical and AC work in composite contract in PSU banks, Govt. Departments as per pre-qualification conditions defined herein under after.

Tender copies will be available for download only from the website of Bank of Baroda <http://www.bankofbaroda.com/tenders.asp> from 11.11.2024

The tenders may be submitted in the following manner:

Envelope No. 1 (Tender Fee and EMD):

Entity	Favoring	Amount	DD/Banker's Cheque payable at
Tender fee (Non Refundable)	Bank of Baroda	NIL/-	KOTA
EMD (Refundable)	Bank of Baroda	44,800/- Fourty four thousand eight hundred rupees only	KOTA

The Tenderer must also submit the Mandatory Information strictly in Bank's prescribed Performa. Technical Pre-qualification of the tenderer will be based on the Mandatory Information and supporting documents submitted along with the tender documents, as well as Architect & Bank's scrutiny of the same and/or inspection of works carried out by the Tenderer. Bank reserves the right to accept or reject any tender without assigning any reason whatsoever.

Envelope No. 2 (Technical Bid):

- **Mandatory Information (strictly in the Bank's prescribed Preform)**
- **Other supporting documents & credentials of the tenderer.**

Must not contain any commercial information. Any Commercial discloser in the Envelop no. 1 or 2 will disqualify the tenderer without any further scrutiny.

The tenderer shall submit the completed tender documents duly signed in an envelope marked with name of work.

Envelope No. 3 (Commercial Bid/Price Bid):

- **Commercial Bid/Price Bid.**

Tender Bids received in any form other than mentioned above will be disqualified. Main envelope which contains all envelopes together.

Sealed tenders in the prescribed tender form, with the tender fees and EMD, along with the Mandatory Information etc. and commercial bid (herein under after called as price bid), should be addressed to

**The Office of Regional Manager,
Bank of Baroda, Kota Regional Office,
First Floor, Pukhraj Tower, Station Road,
Kota -324002**

and super scribed "Tender for interior furnishing, electrical and AC work of Premises for Bank of Baroda, SRINATHPURAM BRANCH, KOTA.

Eligibility Criteria: -

I] Average financial turnover during the last 3 years, ending 31st March of the previous financial year, should be at least **30%** of the estimated cost (**7,17,300.00 /- Rs approx.**).

II] Experience of having successfully completed similar works during last 7 years ending last day of month previous to the one in which applications are invited should be either of the following: -

A] Three similar completed works costing not less than the amount equal to **40%** (i.e. **9,56,400/-**) of the estimated cost without g.s.t. amount.

Or

B] Two similar completed works costing not less than the amount equal to **50%** (i.e. **11,95,500 /-**) of the estimated cost without g.s.t. amount.

Or

C] One similar completed work costing not less than the amount equal to **80%** (i.e. **19,12,800/-**) of the estimated cost without g.s.t. amount.

III) The Contractor should submit Performance Certificate / completion certificate from the previous employer in support of executing similar works failing which the tender shall not be considered is compulsory.

IV] Similar work means interior furnishing / renovation works of same nature /magnitude carried out for Govt. Organizations, private sector banks, public sector financial institutions, PSU BANKS involving furnishing, electrification, air conditioning, and office automation.

V) Bidder should have their office / branch office in Rajasthan/ its nearby area of the project site.

VI) Tenderer /Bidder should have main activity as Contractor ship otherwise tender shall be rejected .Tender / Bidder should also to submit their Pan, GST Tax Registration No. and also submit documentation for the same.

VII) Bidder should have valid electrical licenses in their office / branch office in Rajasthan/ its nearby area of the project site.

In addition to above, the criteria regarding satisfactory performance of works, personnel, establishment, detail of infrastructure, equipment etc may be incorporated in the technical bid.

Sealed Tender must be dropped in a tender Box placed at “Bank of Baroda ,Regional Office KOTA” **not later than 3 p.m. on 02.12.2024.**

Tender should be addressed to
**The Office of Regional Manager ,
Bank of Baroda, Kota Regional Office,
First Floor, Pukhraj Tower, Station Road,
Kota -324002**

Tenders of the prospective bidders (TECHNICAL BID) will be opened at 4.00 p.m. on 02.12.2024.

Defect Liability Period shall be twelve (12) Months from the date of issuance of virtual completion Certificate of the works.

Validity of offer shall be 90 days from the date of opening of Bid. The Bank does not bind itself to accept the lowest or any tender and reserves itself the right to accept or reject any or all tenders, either in whole or in part, without assigning any reason for doing so.

INSTRUCTIONS TO TENDERERS:

1.0 Location:

1.1 **The site is located at SRINATHPURAM BRANCH, KOTA..**

1.2 Tenderers must get acquainted with the proposed work and study drawings, designs, specifications, conditions of contract and other conditions carefully before tendering. The Tenderer shall seek clarifications on any item, if required, prior to submitting his tender. No request of any change in rates or conditions for want of information on any particular point shall be entertained after receipt of the tenders.

1.3 The Tenderer is advised to inspect the site to ascertain the nature of site, access thereto, location, facilities for procurement of materials, labour rates and execution of the work. The Tenderer shall be deemed to have full knowledge of the site and drawings whether or not he actually inspects them.

2.0 Submission of Tender:

Sealed Tender along with price bid shall be dropped in the tender box kept at The Office of Regional Manager, Bank of Baroda, Kota Regional Office, First Floor, Pukhraj Tower, Station Road, Kota -324002 and as per details given here under. The rates shall be filled in the Schedule given in, of the tender document.

In case of any queries, the Tenderer may contact following:

Bank of Baroda : **PREMISES SECTION, KOTA
9887347312**

Architect : **YASH GARG DESIGNER'S,
106, NANDPURI COLONY, MALVIYA NAGAR,
JAIPUR. 9929595589**

2.1 The tender shall be submitted in single bid in a sealed envelope. The envelope containing the tender offer shall be duly super scribed with the name of work .

2.2 The Tenderer is requested to quote strictly as per the terms and conditions and specifications given in the tender document and not to stipulate any deviations. However, deviations, if unavoidable, should be indicated separately indicating the specific page number and clause number against which the deviations are made. Wherever specifications of certain works are not available they shall be deemed to be done as per relevant I.S code.

2.3 Addenda to this tender document, if issued, must be signed and submitted along with the tender document.

2.4 All pages to be initialed:

All signatures in tender documents shall be dated and stamped. All pages of tender documents shall be initialed at the lower right-hand corner or signed wherever required in the tender papers by the Tenderer or by a person holding power of

attorney authorizing him to sign on behalf of the Tenderer before submission of tender.

2.5 Rates to be in figures and words:

The Tenderer should quote in English both in figures as well as in words the rates and amounts tendered by him in the Schedule of Rates for each item and in such a way that interpolation is not possible. The amount for each item should be worked out and entered and requisite totals given of all items both in figures and in words. The tendered amount for the work shall be entered in the tender and duly signed by the Tenderer.

2.6 Corrections and Erasures

No corrections and alterations in the entries of tender papers shall be permitted. If any they shall be signed and dated in full by the Tenderer. Corrections with white fluid and overwriting are not permitted.

2.7 The tender shall contain the names, postal address of the residence and place of business of authorized person signing the tender and shall be signed in /his usual signature. Partnership firms shall furnish the full names of all Partners in the tender. It should be signed in the partnership name by all the partners or by duly authorized representative followed by the name and designation of the person signing. Tender by a Corporation shall be signed by an authorized representative, and a power of Attorney on their behalf shall accompany the tender. A copy of the partnership deed of the firm with names of all partners shall be furnished.

2.8 When a Tenderer signs a tender in a language other than English, the total amount tendered should, in addition, be written in the same language. The signatures should be attested by at least one witness.

2.9 Witness:

Witnesses and sureties shall be persons of status and propriety and their names, occupation and address shall be stated below their signatures.

3.0 Information required along with tender:

The following details are required to be submitted along with tender:

- a) List of Sub contractors to be employed.
- b) List of equipment proposed to be deployed for work.
- c) Site Organization chart with bio-data of Resident Engineer and key personnel proposed to be deployed at site.
- d) Income Tax Clearance and Sales Tax clearance certificates.
- e) Power of Attorney in the name of persons who has signed the tender document.
- f) BAR/PERT Chart.

g) Each Tenderer shall submit with his tender a list of large works of like nature he has executed giving details as to their magnitude and cost, the proportion of work done by the contractor in it and the time within which the works were completed. The Tenderer shall also submit along with his tender a list mentioning the names of manufacturers of specialized items.

4.0 Any printing or typographical errors/omission in tender document shall be referred to the Architect/Interior Designers appointed by the Bank and their interpretation regarding correction shall be final and binding on Contractor.

5.0 Transfer of Tender Documents:

Transfer of tender documents purchased by one intending Tenderer to another is not permitted.

6.0 Earnest money:

6.1 The Tenderer shall pay the amount of Earnest Money as mentioned in the Notice Inviting Tender, by Bank Demand Draft/Banker's Cheque payable to Bank of Baroda, at AJMER. No interest on Earnest Money deposited by the Tenderer shall be allowed. The Tenderer should attach the bank draft/banker's Cheque along with the tender failing which the tender will not be considered.

6.2 The Earnest Money of the unsuccessful Tenderers will be refunded in form of same DD Submitted by them within a reasonable period of time without any interest.

6.3 The Earnest Money deposited by the successful Tenderer shall be retained as part of Security Deposit.

6.3.1 The Security Deposit shall be forfeited if the Contractor fails to observe any terms and conditions of the Contract.

7.0 Validity:

Tenders submitted by Tenderers shall remain valid for acceptance for a period up to 90 days from the date of opening of tender. The Tenderers shall not be entitled during the period of validity, without the consent in writing of Bank to revoke or cancel his tender or to vary the tender given or any terms thereof.

8.0 Addenda:

8.1 Addenda to the tender document may be issued if required to clarify documents or to reflect modifications to the design or contract terms.

8.2 Each addendum issued by the Architect/Interior Designer will be distributed to each person or organization to which a set of tender documents has been issued. Each recipient will submit the same along with his tender. All addenda issued by the Architect/Interior Designer shall become part of Tender Documents.

9.0 Right to accept or reject tender:

- 9.1 The acceptance of a tender will rest with the Bank who does not bind themselves to accept lowest tender and reserve to themselves the authority to reject any or all the tenders received without assigning any reasons. They also reserve the right of accepting the whole or any part of the tender and the Tenderers shall be bound to perform the same at the rates quoted. All tenders in which any of the prescribed conditions are not fulfilled or are incomplete in any respect or there is any correction not duly signed and dated by the Tenderer are liable to be rejected. For this purpose Tenderer shall quote rates for various items which will be self sufficient to meet their whole costs for executing any / every item. No demand for variations in rates for items executed shall be entertained on the plea of the Bank deciding to delete, alter or reduce the quantities specified in respect of the any item.
- 9.2 The work may be awarded to one or more agencies duly splitting the work at the entire discretion of the Bank and the Architect/Interior Designer. The quoted rates shall hold good for such an eventuality.

10.0 Rates:

- 10.1 The Bank is not concerned with any rise or fall in the prices of materials and labor. The rates quoted shall include all costs, allowances or any other charges including any enhanced labour rates etc. which may become effective for any reason including those due to acts of Government/ Statutory Bodies enacted from time to time by the State and or the Central Government. Under no circumstances, shall the Bank be held responsible for compensation or loss to the contractor due to any increase in the cost of labour or materials etc. **G.S.T. WILL PAID EXTRA BY BANK**
- 10.2.1 The rate quoted in the tender shall also include electric and water consumption charges for construction and erection. If power and water are available at the site, the Contractor shall have to make his own arrangements to obtain the connections from the available sources at his own expense and maintain an efficient service of electric light and power and water and shall pay for the services consumed and maintain the installations at his own cost. If no power and water are available at the site, the Contractor shall have to make his own arrangements to obtain power and water connections and maintain at his own expense an efficient service of electric light and power and shall pay for the electricity consumed.
- 10.3 The rate quoted in the tender by the contractor should include cost of -3- sets of 10" x 12" Photographs done by a reputed professional photographer, of the completed work.
- 10.4 Contractor to include cost of pest control treatment of the entire site, including white ants, Roaches, rodents for one year from date of virtual completion of the contract.
- 11.0 Contractor to coordinate and assist the Architect/Interior Designer in obtaining all Statutory approvals including MMC, CFO and any other State and Central rules in force. Any expenses incurred in obtaining such approvals are deemed included in the rates quoted by the Contractors.
- 12.0 The entire interior work shall be guaranteed to be free from manufacturing defects, defective workmanship or materials and any defects that may appear within 12

months from the date of issue of completion certificate which in the opinion of the Bank/Consultants have arisen from bad manufacturing, workmanship or materials, shall upon intimation be made good by the Contractor at his own cost within the time specified. During the said period of 12 months the Contractor shall without any extra cost, carry out all routine and special maintenance of the Interior and attend to difficulties and defects that may arise. The Tenderer / Contractors shall associate with him during the execution and free service period, the operation and maintenance staff of the Bank.

13.0 Payments for the work to be executed under this contract shall be made as per the tender

Document and no variation in the mode of payment will be acceptable. The Tenderer shall guarantee that the work shall conform to the detailed specifications.

14.0 Signing of the contract:

a. The successful Tenderer shall be required to execute an agreement in the proforma attached with this tender document within 45 days from the date of receipt of the notice of acceptance of tender. In the event of failure on the part of the successful Tenderer to sign the agreement within the above-stipulated period. The Bank reserves the right to forfeit the earnest money/ security deposit and cancel the contract.

b. Until the Agreement is formally signed, the Work Order / Letter of Acceptance of Tender issued to the successful Tendered and accepted by him shall be operative and binding on the Bank and the Contractor.

15.0 On acceptance of the tender, the name of the accredited representatives of the Tenderer who would be responsible for taking instructions from the Bank shall be mentioned by the Tenderer.

16.0 If so decided, the Bank reserves the right to appoint PMC (Project Management Consultant) or any other agency to get the quality of works checked, measurements recorded, including certification of bills etc.

17.0 The Bank reserves the right to reproduce partly or fully the items executed on site anywhere in the country premises and no copyright claims shall be made by any contractor of any description from the Bank.

18.0 The Bank has the right to delete items, reduce or increase the scope of work without the contractor claiming any compensation for the reduction in the scope of work.

19.0 Notices to local bodies:

The contractor shall comply with and give all notices required under any law, rule, regulations or bye laws of parliament, state legislature or local authority relating to works. the contractor shall before commencing the execution of work issue a certificate to the bank / architect / consultant that he has obtained all the permission registrations and give all the notices as are required to be obtained or give in under law.

20.0 I / We hereby declare that I / We have read and understood the above instructions for the guidance of the Tenderers.

Witness _____

Signature of Tenderer

Address _____

Address _____

Date : _____

Date: _____

**LIST OF APPROVED MANUFACTURERS FOR DIFFERENT MATERIALS TO BE USED
IN THIS PROJECT**

Names of materials and finished approved by the Architect /Employer are listed below:
However equivalent materials and finished of any other specialized firms may be used, in
case it is established that the brands specified below are not available in the market are
subject to the approval of the alternative brand by the Architect. Original materials will be
delivered on site, no substitute will be allowed.

INTERIOR MATERIAL

S. NO.	ITEM	DESCRIPTION
1.	MDF / PLYWOOD/ BLOCK BOARD,	CENTURY/ ASIAN/ AICA-SUNMICA/ARCHID/ GREENPLY OR EQUIVALENT
2.	LAMINATE SHEET	Archidlam / National / Formica / Greenlam / Aica SUNMICA
3.	VENEER	Green / DURO / Century / Timex / Anchor or equivalent
4.	PARTICLE BOARD	Archidply /Greenlam/Century/ AICA-SUNMICA equivalent ISI make
5.	ACRYLIC SHEET	ICI, GE or equivalent ISI make
6.	MARINE GRADE PLYWOOD	Century, Greenply, Anchor, Orchid, Prince/ AICA- SUNMICA
7.	ADHESIVE	Fevicol / Aratdite/Anchor or equivalent
8.	SOLID SURFACES {CURION}	DUPOINT/HI-MAC/ STARON OR equivalent
9.	MARINE GRADE BLOCK BOARD	Century, Greenply, Anchor, Orchid or equivalent
10.	FLUSH DOORS	CENTURY / GREENPLY / ANCHOR/ ORCHID OR EQU.
11.	POLISH	ASIAN /DULEX OR EQU.
12.	LATEX	MM Foam or equivalent Ist make
13.	HIGH DENSITY FOAM	U Foam or equivalent ISI make
14.	LOCKS,	Godrej / Haffle / Hettich / Ebco or equivalent
15.	STORAGE HARDWARE	Godrej / Haffle / Hettich / Ebco or equivalent
16.	SCREWS, NAILS & OTHER ACCESSORIES	GKW / Nettle ford or equivalent
17.	FALSE FLOORING	Kebao , Armstrong , AMF or equivalent
18.	VINYL FLOORING	Armstrong ,gerftor, Eurotex ,
19.	CARPET	Unitex, Armstrong
20.	WOODEN LAMINTED FLOORING	Pergo / Armstrong / Euro / Squarefeet or equivalent
22.	HARDWARE FOR GENERAL STAFF AREAS	Dorma / Euro/ Ozone / Enox / Ebco /Hamco or equivalent
23.	HARDWARE FOR MAIN GLOSS DOOR	Dorma / Euro/ Ozone / Enox / Ebco /Hamco or equivalent
24.	DOOR CLOSERS	Dorma / Euro/ Ozone / Enox / Ebco /Hamco or equivalent
25.	FLOOR SPRINGS	Dorma / Euro/ Ozone / Enox Ebco /Hamco or equivalent

26	FLOOR SPRINGS FOR MAIN GLASS DOORS	Dorma / Euro/ Ozone / Enox / Ebco /Hamco or equivalent
27	ALUMINIUM SECTIONS FOR PARTITIONS	JINDAL / TATA STEEL OR EQU.
28	FALSE CEILING: GYPSUM	India Gypsum / Saint Gobin / Asia
29	FALSE CEILING: GRID{ AS APPROVED}	Armstrong / AMF or equivalent
30	FALSE CEILING: GRID{ METAL CEILING}	Unimech / AMF / Armstrong /
31	GI SECTIONS	Lndta Gypsum / Saint Gobin / Jinda\ or equivalent
32	ACOUSTICAL FALSE CEILING: MINERAL FIBER BOARD	Armstrong, Hunter Douglas / Peritex or equivalent
33	POP PUNNING	GYPROCK / INDIAN GYPSUM / BIRLA
34	PAINT	ASIAN / NEROLAC / DULEX / BERGER OR EQU.
35	EXTERIOR PAINT	ASIAN / NEROLAC / DULEX / BERGER OR EQU.
36	A.C.P. (INTERIOR & EXTERIOR)	Alstone / Eurobond / Alucobond
37	CYLICON	G E/ Dow coming / Wacer
38	ROLLING / VERTICAL BLINDS	Vista / Perltext / Wlnfab / Mac or equivalent
39	FROSTED FILM	Garware or equivalent
40	ALUMINIUM SKIRTING- 50MM	Jlndal or equivalent
41	WATER PROOFING	Pldillte or equivalent
42	HARDWOOD	Salwood / Teakwood /kapoor
43	AUTOMATED ROLLING SHUTTER	Gandhi automation / Toshi automatic systems /akash rolling shutter
44	GLASS	Saint Gobln / equivalent

PLUMBING MATERIAL

1	CP FITTING	Jaquar/Hindware or equivalent
2	SANITARY WARE	Hindware / Cera / Parrywar or equivalent
3	SANITARY FITTINGS	Jaquar/Hindware
4	GEYSER	Bajaj / Sphere Hot/ Crompton /racold vguard/ havells
5	STAINLESS STEEL SINK	Nirali / Diamond or equivalent
6	C.I. PIPE	Bengal Iron Corporation or equivalent ISI make
7	URINAL PARTITION GLASS	Merino / Saint Gobain/ Modi/ Asai
8	GI PIPE	Tata/ Jindal / Zenith or equivalent
9	CP FITTING	Pince /Astral or equivalent
10	PVC & CPVC PIPE	Pince /astrai or equivalent

CIVIL MATERIAL

1	Ceramic Tiles / Vitrified Homogenous Glazed Tiles	HR Johnson, Kajaria. Nitco, ASL or equivalent
2	Cement	Ultratech , ACC, JK Cement , Ambuja
3	Chemical Fasting {Tiles}	Pidlite, Fosroc, Eurokart

4	Steel	Sail, Tiscon, Ispat ,Tata
---	-------	---------------------------

ELECTRICAL MATERIAL

S. NO.	ITEM	DESCRIPTION
1.	Light Fixtures & Lamp	Philips / Wipro / Osram / Havells / Crompton g./halonix
2.	Ht Cable	Polycab/ Havells/HPL
3.	Modular Switches	ABB, Legrand, /MK/ ANCHOR/ ELLEYS/ ROMA
4.	Dlp Trunking	Legrand /Schneider
5.	Power Cable	CCI / SKYTONE/ UNIVERSAL/ LAPP/ TORRENT
6.	End Termination	RYCHEM/ MAHINDRA/ ELMEX
7.	Panel	CROMPTON/ L&T/ C&S
8.	Fan	CROMPTON/ HAVELLS/ BAJAJ/ USHA
9	Raceway & Alu. Trunking	TATA./ JINDAL/ ZENITH
10.	Casing & Caping	FINOLEX /CAP or Equivalent
11.	Weather Proof Socket Outlet With MCB	ABB/ MDS/ LEXIXC/ Neptune/ Elcon- Clipsil, Siemens, Schneider {Merin Gerin}
12.	Miniature Circuit Breaker	MDS/ LEXIS/ siemens/ HPL
13.	MCB distribution board in steel housing{ double door}	ABB / LEXIS/ siemens/ HPL
	DISTRIBUTION	
14.	MV Contractor/ Timer/ Relays/Starters	Legrand /Schneider{MG}/ ABB/ Siemens/ L&T
15.	Moulded Case Circuit Breakers	Legrand /Schneider{MG}/ ABB/ Siemens/ L&T
16.	SFU / FUSES	HPL /Schneider{MG}/ ABB/ Siemens/ L&T Siemens
17.	ACB	Schneider{MG}/ ABB / Siemens/ L&T
18.	Single Phase Preventer {Current Base}	L&T , Minilec
19.	Raising Mains & Tap Off {Power Coated}	Zeta, C&S, Siemens
20.	MV Switch Boards {Powder Coated}	Tricolite Electrical Industries, conlec Engineers Pvt. Ltd, Vidyut Control Pvt Ltd., Trinitron Milestone Switchgear, Unilec Ltd, Madhu E\ectrica\ Advance Electro Control Pvt Ltd.
	LOW TENSION SYSTEM	
21.	Light & Fan Wire	Polycab, Finolex, Hawells
22.	Telephone Wire	Delton, Skyline, Finolex, Rallison, Batra Henley
23.	Telephone Tag Blocks	Krone / Pouyet/ TVS
	Cable & Accessories	
24.	1100 volts grade cables	CCI, Universal, Fort Gloster, Polycab, RPG {Asian), Nicco
25.	Cable lugs	Dowells
26.	Cable compression glands	Peeco/ Comet
27.	Capacitor Bank ISI MARK	GE POWER / BHEL/ EPCOS/ L&T
28.	Lighting Arrestor	Altas / Alstom/ GE Power
29	Protection & Other Relay	ABB/ Siemens/ Schneider/ L&T/ Allen Bradley
	Internal Wiring Related Works	
30.	MCB/ RCCS/ Isolators {ISI} MARKED MCB DB	L&T Siemens/ Schneider/ Legrand
31	PVC CONDUIT	CAP/ BEC/ Seiko/ AKG
32	PVC Insulated Copper Wire ISI Marked	SKYLINE/ FINOLEX/ POLYCAB/ HAVELLS

33	TELEPHONE CABLE	SKYTONE/ DELTON/ NICCO/ POLYCAB/ FINOLEX
34	Switch, TV & Telephone Socket & Boxes {Modular Type}	CPL/ LEGRAND/ ABB/ ANCHOR
	MISCELLANEOUS ITEMS	
35	LIGHTING PROTECTION UNIT	Erico / Pheonix/ INDELEC
36	RELAYS	L&T/ ABB/ Siemens/ BCH
37	CONTRACTORS	I&T/ GE Power/ BCH/ Siemens/ ABB
38	CHANGEOVER SWITCH	C&S/ Havells/ L&T/ HPL
39	KWH,PF,FREQUENCY METER	BHEL/ AE/ Havells/ L&T/ ALSTOM
40	PUSH BUTTONS	L&T/ Siemens
41	TIMERS	L&T/ Legrand/ Schneider/Siemens/GE
42	TIMER SWITCH	L&T/ Legrand/ Schneider/Siemens/GE
	NETWORKING	
43	SWITCHES	Brocade/Cisco/ Digi-Link/ 3Com/ Nortel/ Foundry/ D-Link
44	PATCH PANEL, PATCH CORD & I/O	Digi-Link / TyCo(AMP) / Schneider/ D-Link
45	CABLE	Digi link/ Clipser/ National/ Polycab/ Lapp/ Finolex
46	RACKS	Comrack / HCL / Valrack / APW President
	MODULAR	
47	Extruded Aluminum Sections	Hindalco, Sant aluminum, Midi extrusions
48	Pre Laminted Particle Board	Action Tesa, Associate Décor, Asis, Century (interior grade -2
49	PVC Lipping	Rehau, Dolkin
50	Hinges/ Storage And Pedestal Locks/ Minifix Fittings / Sliding Channels Etc.	Ebco, hafele, Hettich or equivalent
51	8 mm Glass	Modi, Saint gobain, Asahi
52	Door Locks For Cashier Cabin	Godrej, Enox, Doorset, Ultra, Ebco
53	Hydraulic Door Closer	Yele, Enox, Everite, Ebco
54	Powder Coating	paramount, Narolac
55	Fabric For Panel	Response
56	Mdf	8mm / 10mm / 12mm / 18mm MDF

Date :

Place :

[To be signed by the Authorized
Representative of Tenderer holding
Power of Attorney]



REGIONAL OFFICE , KOTA

PART – II
FINANCIAL BID

SPECIFICATIONS
&
CONDITIONS OF CONTRACT

FOR THE

INTERIOR FURNISHING, ELECTRICAL
& AC WORK

SRINATHPURAM BRANCH, KOTA.

ARCHITECT

**YASH GARG DESIGNER'S ,
106, NANDPURI COLONY, JAIPUR
Mobile: + 91-9929595589
Email : ygdesigners@yahoo.in**

INTERIOR, FURNISHING WORK FOR BANK OF BARODA, SRINATHPURAM BRANCH, KOTA.

SCHEDULE OF QUANTITIES

PART A : INTERIOR FURNISHING WORK					
S.No.	ITEM	QTY.	UNIT	RATE (RS.)	AMOUNT
1	FALSE CEILING (GYPSUM BOARD) : Providing & Fixing gypsum board false ceiling system in 2 steps / In combination the grid ceiling Arm strong / Dycan tiles ceiling vertical profile using 12.5mm gypsum plaster board on G.I.metal frame work. The frame work made up of perimeter channels of 20X27X30X3657mm fixed on wall & partitions and ceiling sections of 80X26X0.5X3657mm as a cross member provided at 457mm c/c and the intermediate channel of 15X45X.09X3657mm as a main runner at 1220mm c/c suspended by means of G.I.angle 25X25X.05 mm from the existing ceiling by means of M.S. rawl plug with bolts/screws at 1200 mm c/c max. The joints of gypsum board to be taped 3 times and sealed with jointing compound. Finished with one coat of primer and min 3 coats colour or matching spectrum colour complete as per detail and specifications in drawing incl. allights, diffuser cuttings complete. Corner of ceiling is cobbled/ cornice.	645.00	Sq.FT		
2	FALSE CEILING (GRID) : Providing & fixing Grid false ceiling (armstrong or equivalent company product) of 12mm thick mineral fibre acoustic tiles with crisp finely granulated surface in bright colour Prima regular Fine Fissured RH 99 with Arm strong TL 24mm exposed grid Tee section, exposed face shall be powder coated (white), main runner shall be Tee-shape section with single rotary stitching of size 24x38mm , 3.6m long with cross runner of tee shape section with single rotary stitching of size 24x30mm @1.2m with 24x25mm runner @ 0.60m c/c, with Armstrong suspenders, perimeter channel of size 22x22mm (white) all complete in all respect as per manufacturer's specifications.	945.00	Sq.FT		
3	WOODEN PARTITIONS : Wooden partition system using an internal frame work of anti termite treated pine wood section of clear size 2" X 1.5" at 2'.0" c/c both ways with both ways a covering of 9mm commercial ply covered by combination of as per designed pattern laminate 1.0mm thick in approved shade- Formica / Green/ ARCHID or equiv. apprvd make with bands and combination with grooves etc. as per details. 3" x 1" chowkhats for doors, including provision of windows as per size with 5 mm thick etched as /design glass and beading 30 mm wide for fixing the window glass and covering the joints between partition and chowkhats etc. 1.25" X 1.25" T.W. moulding / second colour band as designed at skirting and at junction of false ceiling level. As per drawing and design in drawing. Same pattern door to be fixed in the partition with all hardware, tower bolts, stoppers, Mortise lock with SS Handles etc. Complete fine finish as per instructions of the Architects.				
a.	MANAGER ROOM PARTITION	110.00	Sq.FT		
b)	BACK SIDE PARTITION (FULL HEIGHT PARTITION)	295.00	Sq.FT		
C)	OFFICER SIDE PARTITION (LOW HEIGHT PARTITION)	90.00	Sq.FT		
4	SLIPS COUNTER / WRITING LEDGE :10 mm bevelled clear glass to SLIP counter 3'0" x 1'3" x 3'6" height with shelf and Pigeon holes to keep slips 19mm block board fabrication approved pattern laminated as per design in drawing with divisions below and shutter in front to create to boxes for mail, cleaning etc. with suggestion box made out of solid ply and finished with 1 mm thk laminate and inside should have enamel painted . 1" high slit is to be made in the front for letter and cheque box Laminate & enamel painted on the iside 1" thk slit to be made in the front for letter / cheque etc. the work should be as per direction .	1.00	NO.		
5	WALL PANELING ; providing and fixing of wall paneling with using 47 mm. x 37 mm .finished chir wood internal frame , 600mm c/c distance 9max) in both directions with steel fittings , using 9 mm. commercial ply on front face covered with 1.0thick lamintee in two shades . complete in all respect.	635.00	Sq.FT		
6	A.C.P PANELING ; Providing & fixing full height interior grade A.C.P. wall paneling 3 mm thick in two or more shades/ design fixed on 50 X 25 Aluminum frame at 600 centre to centre both sides horizontal & vertical. The paneling to be finished with silicon complete in all respects as per Bank/ Architect.	508.00	Sq.FT		
7	DOOR ; providing and fixing 32 MM thick flush door finished with 1 mm. laminate on both side . The item including providing and fixing 75 x 50 mm. t.w. choukhat . The edges of door to have 12 mm. t.w. lipping finished with laminate , fixing 8 mm. thk glass with tw beading . the lock (godrej) ,s.s. handles , hinges , stoppers , door closer of approved make etc. completed in all respect.	95.00	Sq.FT		
8	FILING CABINETS ; 19mm block board fabricated laminated front shutters cabinets with horizontal & vertical divisions for stacking of files as per design including all hardware- handles, catchers, stoppers, locks, hinges etc. of approved make and all insides enamel painted, all visible sides to be finished in approved pattern, style and shade laminate all board edges finished in TW beading french polished complete fine finish as per designs and as instructed by the architect/ bank.				
a.	low & full height cabinet (measurmnt of front only)	800.00	Sq.FT		
9	TOUGHENED GLASS WORK				
a.	TOUGHENED DOOR: P/F/M of 12 mm thick toughened frame less glass door including heavy duty floor spring , patch fittings , 12" TO 24 " S.S. HANDLES AS PER architect / bank complete.It includes all fittings required in automated sliding glass door , no other charged will provided to extra work.	70.00	Sq.FT		
b	TOUGHENED fixed section: P/F/M of 12 mm thick toughened frame less glass fixed section including heavy patch fittings ,.It includes all fittings required in automated sliding glass door , no other charged will provided to extra work.	365.00	Sq.FT		
C	TOUGHENED COUNTER GLASS: P/F/M of 12 mm thick toughened frame less glass fixed section including heavy patch fittings ,.It includes all fittings required in automated sliding glass door , no other charged will provided to extra work.	80.00	Sq.FT		

10	ACCESSORIES				
	P & F Hydraulic Door Closers	4.00	No.		
11	Providing & fixing in position '3M' make frosted glass film in stardust range fixed to glass as per pattern. Area of application to be measured as maximum length x maximum height of application on that particular piece of glass.	150	Sqft		
12	OTHER WORKS				
a	LOGO providing & fixing 12 mm th. Translucent arcyloc of required size with proper LED lighting behind. The cutting should be done on CNC MACHINE with proper edge polishing made of measurement -per number.	2	Nos.		
b	PIN Board OF APPROVED DESIGN & COLOUR	25	Sqft		
c)	laser / cnc cutting jali work for decorative: Providing And Applying of laser / cnc cutting jali work on mdf / steel as per approved by bank or architect. All mdf work will painted with deco paint and polish.	50	Sqft		
13	Providing & fixing wall paper on wall / partition as per approval of Architect & Engineer. Wall paper basic rate : Rs 1000/- per sqm	100.00	Sqft		
14	Providing & Keeping centre table made out of 18 /12 mm thick plywood & 6/12 mm thick the fleiply as per design . The top should be finished with edges of 2" thick the vertical sapport should be of 24" dia. Etc. complete with necessary hardware . The top surface with edges should be finished with 12 mm th. approved dupont corian solid surface etc. complete as per detailed drawing & instruction of Architect / engineer.	2.00	Nos.		
15	Notice Board -600 X 1200 MM	4	Nos.		
16	Notice board - 600 x 457 mm	4	Nos.		
17	P& F of 3 seater sofa as per design	2.00	Nos.		
18	DRESSING MIRROR FOR STRONG ROOM :- Providing and fixing dressing table made out of mirror of size 1' 6" x 3' 0" using 12mm thk. Comm. Ply with 6mm thk. clear Mirror fixed on the wall & tray of size 1'6"x1'6" with one drawer for cosmetics.	1.00	Nos.		
19	CARPET FOR STRONG ROOM	150	Sqft		
TOTAL (PART-B)					

PART - B : ELECTRICAL WORK					
S.No.	ITEM	QTY.	UNIT	RATE (RS.)	AMOUNT
1	POINT WIRING P & F light/ fan/ call bell points/ sockets etc. with 2x1.5 sq.mm pvc insulated 1100 v grade copper conductor wires and 1.0 sq.mm earth wire in concealed/ surface using PVC 20mm/25mm/32mm dia conduits, accessories such as bends, tees, saddles, draw boxes, mounting boxes, inner plates, cover plates, ceiling rose etc. (wherever required) and plugs etc. no flexible conduits will be allowed The circuit wiring starting from DB to point control box/ switch box using 2x2.5 sqmm & 1x1.5 sqmm earthing pvc insulated wiring with colour code to be provided. Identification ferrules at both ends to be provided. Notes: Each circuit shall have independent earth wire. Each point shall be earthed. Circuit wiring to be included in the point wiring rates				
a.	one light point controlled by one 6 A switch	55.00	Each		
b.	wall fan point with independent 6A switch and 6 a socket	12.00	Each		
c.	exhaust fan point with 16 a switch and 6A socket	3.00	Each		
2	POWER POINTS : Same as item no 1 but wiring for 16 A - 6 pin sockets using 4 sq.mm pvc insulated copper conductor wire with independent 2.5 sq.mm earth wire from DB to 1st Socket & 1st socket to 2nd Socket with 2.5sq.mm and 1.5 sq.mm earth wire including providing and fixing of 16 A - 6 pin socket with 16 Amp switch.	10.00	Each		
3	A. C. Points: A.C Point wiring with 2x4 sqmm +1x2.5 SQ mm copper conductor from AC DB to ACPOINT in 16 swg GI conduit ac point including supply ing and fixing of metal AC box with 3 pin metal clad top and 32/25 amp SPMCB as per site requirments	6.00	Each		
4	LIGHT FIXTURES & FANS: P & F light and accessories as per the following . Details and making connections , testing and installation . Complete in all respects				
a	S& F 2 x 30 W 2' X 2' LED PANEL recessed LIGHT	35.00	Each		
b.	S& F 1 x 18 W LED recessed down lighter	18.00	Each		
c.	LED (1 X 36 W) TUBE LIGHT	10.00	Each		
d.	Metal body Wall fan 400 mm - Crompton High flow of capacitor start, three speed wall mounting/cabin fan of following sweep with the help of anchor bolts including making connection testing etc. as required. Each wall fan should be connected through independent switch and socket of 6Amp.(Crompton/ Almonard/ Usha/ Havells)	14.00	Each		
e	48" CEILING FAN	1.00	Each		
f	Exhaust fan 300 mm - Crompton/ Almonard of Heavy duty capacitor start 1400 RPM single phase ISI marked Exhaust fan, IS:2312 marked including making opening if required, making connections testing etc. as required.(Crompton/ Almonard/ Usha/ Havells)	2.00	Each		
g	S& F of Rope Light with driver (Philips/ Bajaj/ HPL/ Osram/ Havells)	150	Rmts.		
(h)	Decorative spot led light of 1watt to 5 watt led (6500K)/BAJAJ/philips/HAVELLS	10	Rmts.		
(i)	Decorative picture led light wall mounted of 3watt to 5 watt led (6500K)/BAJAJ/philips/HAVELLS	4	Nos.		
5	UPS Wiring: P/F UPS point in pvc conduit 2 mm thicks & duly wired with 2x2.5 sqmm insulated copper wire along with 1x1.5 sqmm pvcinsulated wire for earthing including bends, nipples, junctions, M.S switch boxes each to have 3 Nos 6 A 5 pin modular socket, 1x 6 A indicator controlled by 1x6A switch 'compl fine finish incl. making necessary connections & start of equipment as per details & drawings				
a	u.p.s. point directly connected to u.p.s. D.B.	26.00	Each		

6	EARTHING : S/I/T/C of earthing station using 600x600x6.28 mm thick GI plate including excavation, back filling, filling of salt/charcol, 40 mm internal diameter GI pipe as per specifications including Masonary Chamber with CI Cover & frame as per IS 3043/1966 revised up to date.	1.00	Each		
7	Supply & laying of hot dipped Copper strip (25X3 mm) to Connect to the DB's poles & Equipments in outdoor yard & also in indoor portion of substation.	40.00	RM		
8	Supply & laying of XLPE insulated armoured aluminium/copper conductor 1.1 KV class cables as per IS complete in all respect.				
a	4CX 35.00 Sq.mm aluminium unarmoured	35.00	RM		
b	4CX 16.00 Sq.mm aluminium unarmoured (UPS-input & output)	50.00	RM		
c	2CX 10.00 Sq.mm ALUMINIUM unarmoured (A.T.M. ROOM TO PANEL)	40.00	RM		
9	UPS D.B.- supply , ertection & commissioning of 4 way TPN HCB DB WITH 63 amp TPN MCB -2 NO. , 10/32 amp SPN -8no.comprising of recessed sheet steel one loose with double door with loose wires box with 100 ahnned of bus bars with nuteral , earth strips , interconnection with following neuntings as required .	2.00	no.		
10	DISTRIBUTION BOARDS.- P & F sheet metal distribution boards of approved make double door type and making necessary connections etc complete with all MCBs of C series 10 KA. (LEGRAND/ SCHNEIDER/ SIEMENS/C&S/HPL) All MCB'S must be 'C' series, 10 KA T P N 4 WAY DB :- (For Lighting) Having Incomer : 40 Amp. 4-P MCB a OUT GOING : 10 Amp. SP MCB - 12 NOS T P N 4 WAY DB :- (For Power/ AC) Having Incomer : 63 Amp. 4-P MCB b OUT GOING : 16 Amp. SP MCB - 12 NOS T P N 4 WAY DB :- (For A.C.) INCOMER: 100 Amp. 4 P, Heavy Duty MCB c S P N 10 WAY DB :- SP MCB 6 Amp = 8 Nos. DP MCB 63/40 Amp = 1 NOS.				
11	MAIN ELECTRICAL PANEL FOR SMALL BRANCH :- Designing manufacturing, installing, testing and commissioning of cubical type MAIN PANEL CPRI approved made from 16 SWG CRCA sheet steel, "type base M.S. channel for grouting on floor complete with MCCB, MCBs, meters, C.T., etc. complete in all respect, insulated bus bar with near shrinkable PVC sleeve in suitable bus bar chamber, wiring, name plates, danger plates, earth bus etc. & comprising of compartments with hinged doors and rubber gasket, bus bar chabmer with bolted door and rubber gasket etc. the panel being of dust & vermin proof construction and to be painted with primer and smoke gray paint (minimum two coats) to look attractive. The panel should be comprising with the following : (Degree of Protection IP-54) INCOMER: - ALL MCCB SHOULD HAVE 25 KA SHORT CIRCUIT CURRENT CAPACITY (C- CLASS) (Legrand/ HPL/ C&S/siemens/ABB/ Schneider) (i) 150 Amp 4 - P, MCCB (3 Phase) 1 Nos. (ii) 100 Amp 4 - P, ON LOAD change over switch (iii) 250 Amp. Capacity aluminum bus bar for ATM & system room heat shrinkable proper insulation with heat shrinkable proper insulation with color coded. Analog ammeter and voltmeter with selector switches three number indicating lamp R-Y-B Phase indicators with 2 amp. back up HRC fuses & Energy Meter with KWH and PF indication (Back up Fuse protection) OUT GOING : - ALL MCCB SHOULD HAVE 25 KA SHORT CIRCUIT CURRENT CAPACITY DOUBLE BUS BAR PANEL DG SUPPLY ONLY FOR LIGHT, POWER, UPS, ATM ONLY A.C. SHOULD NOT OPERATE ON DG SUPPLY All MCCB must have 25 KA S.C. current capacity All outgoing feeder should have separate door and compartment. Each outgoing feeder shall be with indicator. (i) 100 Amp 4 - P, MCCB (3 Phase) 1 Nos. (A.C.) (ii) 63 Amp 4 - P, MCCB (3 Phase) 3 Nos. (Power, light. A.T.M., UPS) (iii) 16 Amp DP, MCB (1 on each Phase) 1 Nos. (ii) 63 Amp 4 - P, MCB (3 Phase) 2 Nos. (Power, light. A.T.M., UPS)	1	Nos.		
TOTAL (PART-C)					
PART - C : TELEPHONE WORK					
S.No.	ITEM	QTY.	UNIT	RATE (RS.)	AMOUNT
1	S/I/T/C 2 Pair PVC Insulated Telephone wire (Delton, Finolex Polycab or Eq.)	150.00	R Mt.		
2	Supply,installation, testing & Commissioning of telephone outlet Box with top plate.	10.00	No.		
TOTAL (PART-D)					

PART - D: NETWORKING WORK					
S.No.	ITEM	QTY.	UNIT	RATE (RS.)	AMOUNT
1	Supply, Laying, Testing & Commissioning of enhanced CAT 6 LAN cable (AT & T/D Link/ Siemens sheilded make) in PVC conduit & termination.	650	R.Mt.		
2	S/I/T/C of RJ 45 Connector with computer socket outlets of AMP/D-LINK make.	30	No.		
3	Supply and installation of patch cord 1 m length	20	No.		
4	Supply and installation of patch cord 2 m length	10	No.		
5	P & F OF NEW DATA RACK , 24 PORT SWITCH , 9U RACK AND PATCH PANEL FOR NETWORKING WORK.	1	No.		
TOTAL (PART-E)					

PART - E : AIR CONDITIONING WORK					
S.No.	ITEM	QTY.	UNIT	RATE (RS.)	AMOUNT
1	AIR CONDITION UNIT Supply & handing over the following equipment as per specifications , schudle and drawing atleast 5 star rated bluestar / HAIER split AC . Supply of a.c. type unit each comprising of an outdoor and single high wall mounded in door unit. condensing unit shall be complete with hermetically sealed rotary compressor and air cooledd condenssor with fan evaporating unit shall consist of a fan section with dymamically balanced centrifugal fan driven by FHP motor , multi rows deep cooling cool of copper tubes with aluminium fins thermostatic expansion valve etc. the evaporating unit shall br equipped with synthetic fiber fiter, insulated drain pan safety controls thermostate all complete in a unit single face split unit. supply of high wall spilt unit with cordless remote.				
a	SPLIT A.C.				
	supply of 1.0 TR SPLIT A.C.	2	No.		
	supply of 1.5 TR SPLIT A.C.	1	No.		
	supply of 2.0 TR SPLIT A.C.	1	No.		
2	instalation , testing and commissioning of SPLIT A.C.	4	No.		
3	CASSATEE A.C.				
	supply of 3.00 TR Cassatee A.C.	3	No.		
4	instalation , testing and commissioning of cassatee A.C.	3	No.		
5	voltage stabliser 3 step cripped with TDR - 5KVA	3	No.		
6	P& F electrical wiring and COPPER refregent piping above 10 r./ft for split ac	70	RMETS		
7	P& F electrical wiring and COPPER refregent piping above for cassette ac	95	RMETS		
8	condensate drain water piping 1" dia p.v.c. duly insulated to nearest drain trap to be laid concealed.	65	RMETS		
9	ms stand for split ac	4	no.		
10	ms stand for cassette ac	3	no.		
11	TIMER	1	NO		
TOTAL (PART-F)					

INTERIOR & FURNISHING WORK FOR BANK OF BARODA , SRINATHPURAM BRANCH, KOTA.					
	PART-A :- INTERIOR WORK				
	PART-B :- ELECTRICAL WORK				
	PART-C :- TELEPHONE WIRING				
	PART-D :- NETWORKING				
	PART-E :- AIR CONDITIONING WORK				
TOTAL AMOUNT					

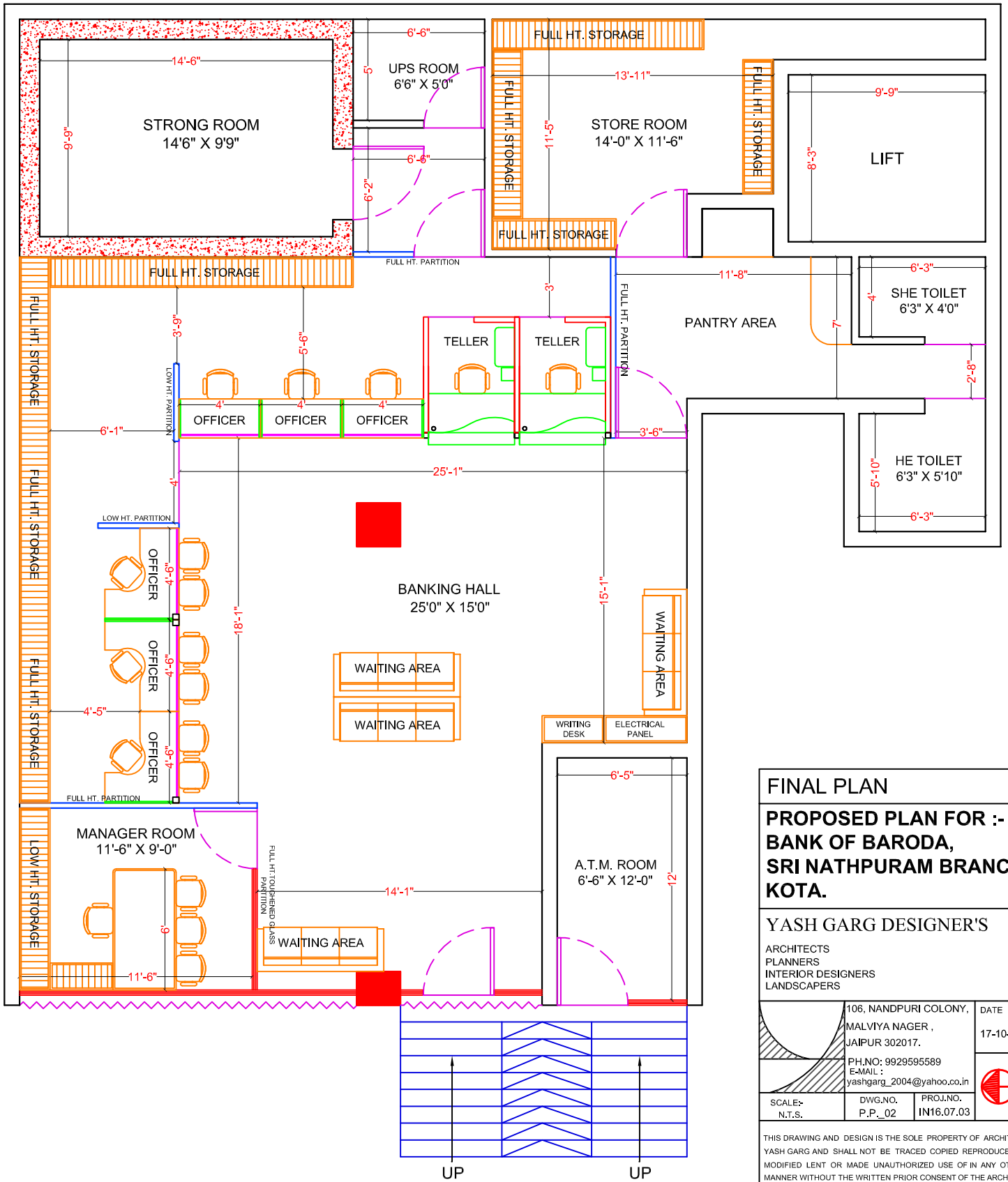

FINAL PLAN
PROPOSED PLAN FOR :-
BANK OF BARODA,
SRI NATHPURAM BRANCH,
KOTA.

YASH GARG DESIGNER'S
 ARCHITECTS
 PLANNERS
 INTERIOR DESIGNERS
 LANDSCAPERS

	106, NANDPURI COLONY, MALVIYA NAGER, JAIPUR 302017.	DATE 17-10-2024
	PH.NO: 9929595589 E-MAIL : yashgarg_2004@yahoo.co.in	
SCALE:- N.T.S.	DWG.NO. P.P_02	PROJ.NO. IN16.07.03

THIS DRAWING AND DESIGN IS THE SOLE PROPERTY OF ARCHITECT YASH GARG AND SHALL NOT BE TRACED COPIED REPRODUCED MODIFIED LENT OR MADE UNAUTHORIZED USE OF IN ANY OTHER MANNER WITHOUT THE WRITTEN PRIOR CONSENT OF THE ARCHITECT